

DIMENSIONS												NO LOAD WINGS - REINFORCING												SHORT WINGS - REINFORCING												TWO CURS REINFORCING											
NO	1	2	3	4	5	6	7	8	9	10	11	NO	12	13	14	15	16	17	18	19	20	21	NO	22	23	24	25	26	27	28	29	30	31	32	NO	33	34	35	36	37	38	39	40	41	42	43	
1	1.00	1.00	1.00	1.00	1.00	1.00	1.00	1.00	1.00	1.00	1.00	1.00	1.00	1.00	1.00	1.00	1.00	1.00	1.00	1.00	1.00	1.00	1.00	1.00	1.00	1.00	1.00	1.00	1.00	1.00	1.00	1.00	1.00	1.00	1.00	1.00	1.00	1.00	1.00	1.00	1.00	1.00	1.00	1.00	1.00	1.00	

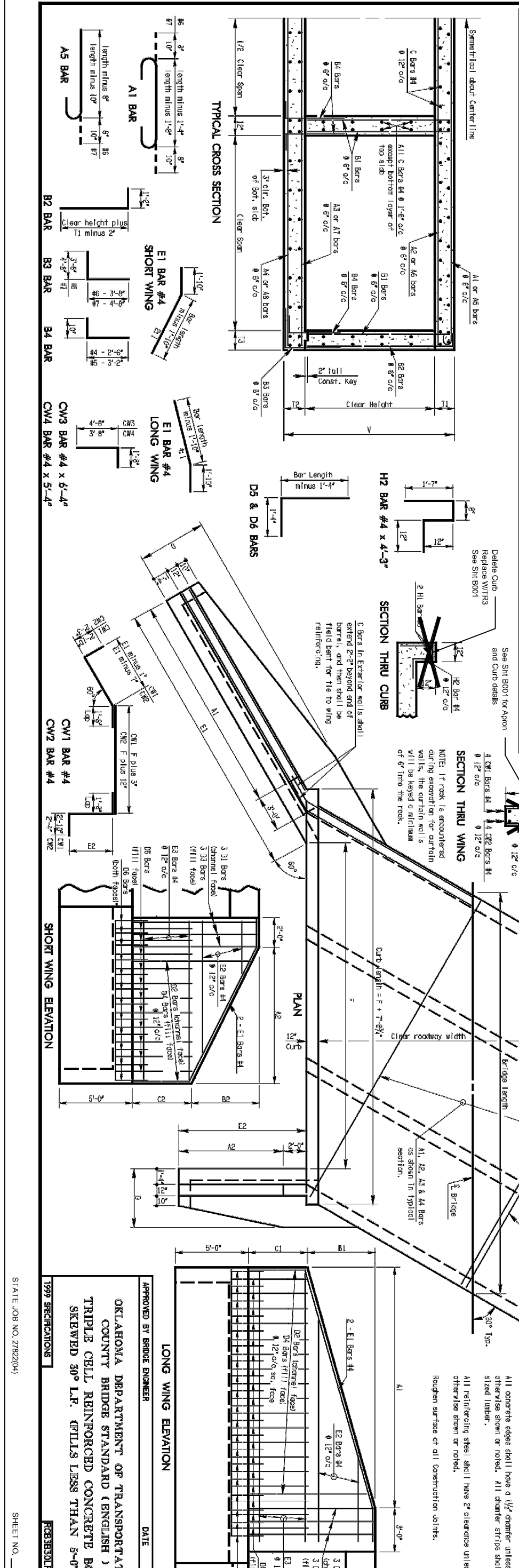
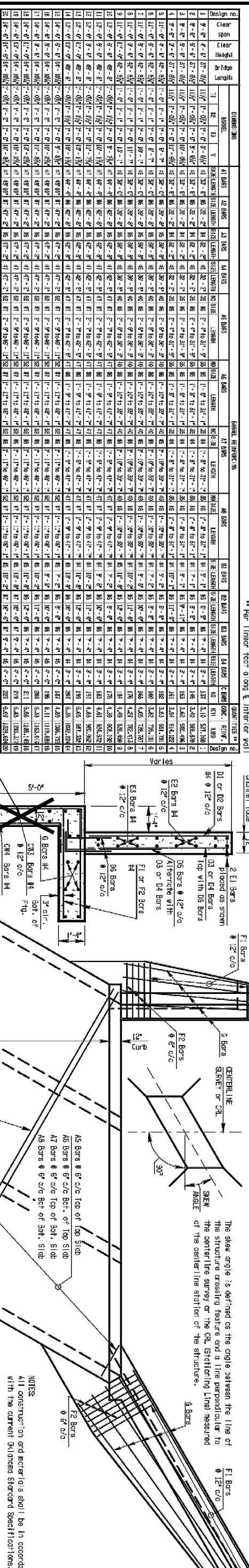

DESIGN DATA  
 P.O. = 3000psi  
 Class "A" Concrete  
 Reinforcing Steel Grade 60 fy = 60000psi  
 Loading HS 20  
 Design: Load Factor Design

NOTES  
 All construction and material shall be in accordance with the current Oklahoma Standard Specifications.  
 All concrete edges shall have a 1/2" chamfer unless otherwise shown or noted. All chamfer strips shall be sized lumber.  
 All reinforcing steel shall have 2" clearances unless otherwise shown or noted.  
 Roughen surface of all construction joints.

APPROVED BY BRIDGE ENGINEER  
 OKLAHOMA DEPARTMENT OF TRANSPORTATION  
 COUNTY BRIDGE STANDARD (ENGLISH)  
 TRIPLE CELL REINFORCED CONCRETE BOX  
 SKEWED 30° L.R. (FILLS LESS THAN 3'-0")  
 1999 SPECIFICATIONS  
 FEB301E-21 OOE  
 CR-11E