

SIGNAL FACE NUMBER	POLE	NUMBER & TYPE	MOUNTING	VISOR	BACK PLATES	NOTE
1 & 2	"B"	6 ONE WAY ONE SECT. (S-22)	MAST ARM	V-1	2 *B-2 MOD.	NEW
3 & 4	"C"	6 ONE WAY ONE SECT. (S-22)	MAST ARM	V-1	2 *B-2 MOD.	NEW
5	"B"	1 ONE WAY ONE SECT. W/ CD (S-20)	CLAMP MOUNT	V-3	-	NEW
6	"C"	1 ONE WAY ONE SECT. W/ CD (S-20)	CLAMP MOUNT	V-3	-	NEW

\*NOTE: SIGNAL HEADS AND BACKPLATES SHALL BE AS SHOWN ON THE "VEHICLE SIGNAL HEAD DIAGRAM"

LOCATION	TYPE	MAST ARM	FOUNDATION
"B"	32' M.H. COMBO	30' T.S. & 10' LUMINAIRE	S-30
"C"	32' M.H. COMBO	30' T.S. & 10' LUMINAIRE	S-30

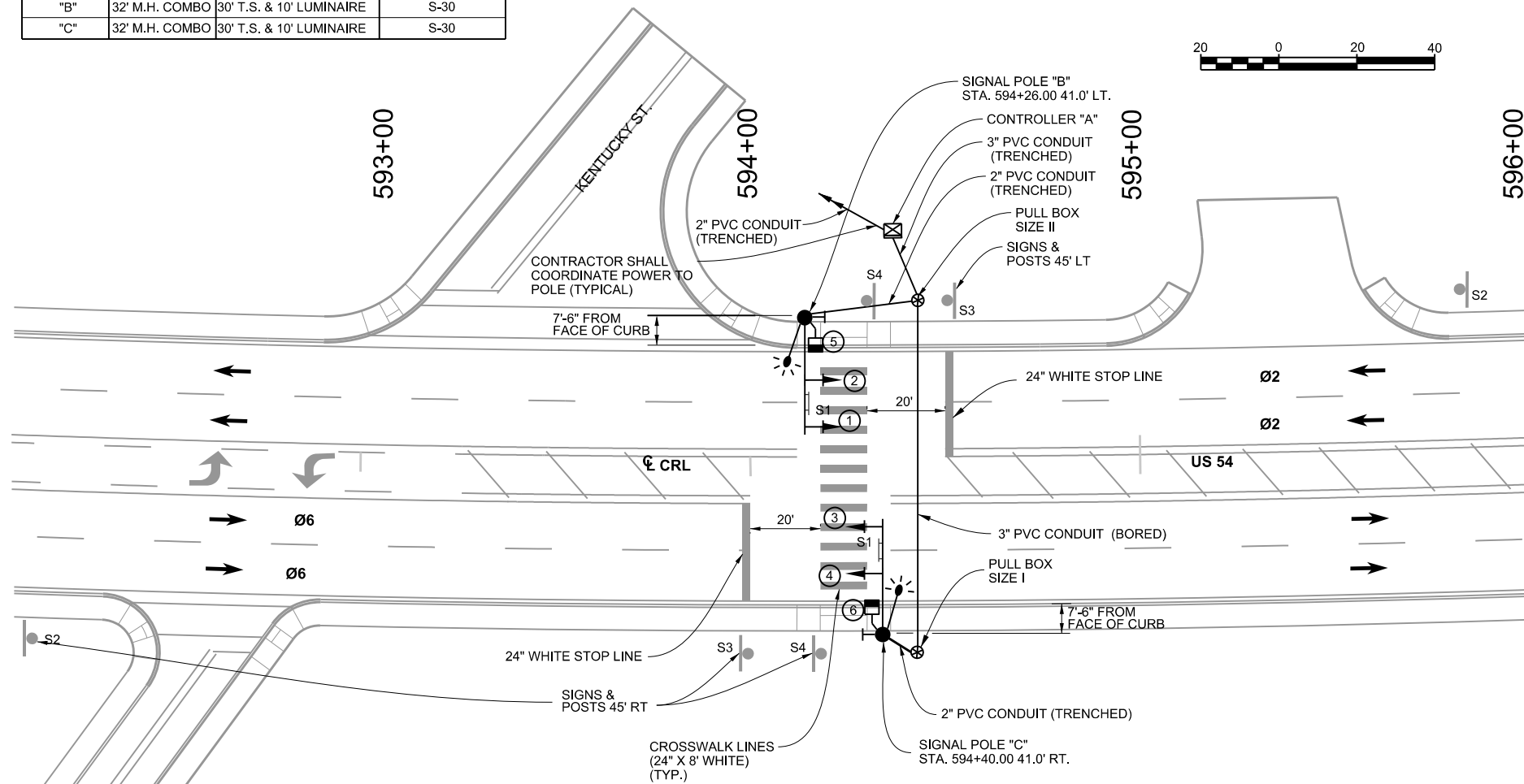

B-12C/5C	C-12C/5C

CABLE TERMINAL IDENTIFICATION CODE

EXAMPLE: B - 12C → 12 CONDUCTOR CABLE

EXAMPLE: F - 2CS → TWO CONDUCTOR SHIELDED LEAD-IN CABLE

SPLICE LOCATION

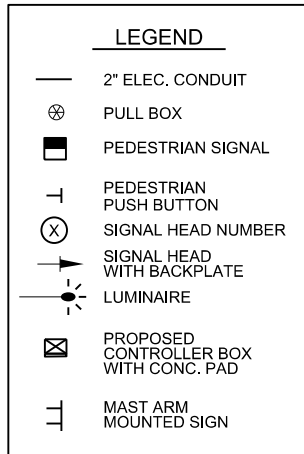

**NOTE:**

SPECIFIC LOCATION OF TRAFFIC SIGNAL CONTROLLER, CABINET, AND ALL TRAFFIC SIGNAL POLES WILL BE AS SHOWN ON THE PLANS. CONTRACTOR WILL CONFIRM FINAL LOCATION WITH ENGINEER PRIOR TO INSTALLING FOUNDATIONS. CONTRACTOR WILL CONFIRM LOCATION OF ALL UTILITIES PRIOR TO ANY EXCAVATION, BORING, AND DRILLING OPERATIONS.

THE INTENT OF THE PLANS AND SPECIFICATIONS IS TO PROVIDE FOR THE INSTALLATION OF THE "HIGH INTENSITY ACTIVATED CROSSWALK PEDESTRIAN BEACON" SIGNAL AT THIS LOCATION INCLUDING ALL SIGNAL EQUIPMENT AND HARDWARE BOTH ABOVE AND BELOW GROUND.

CONTRACTOR TO INSTALL THE CONTROLLER WITH TIMING AND PHASE SETTINGS AS SHOWN ON SHEET 79.

ALL CABLE RUNS IN CONDUIT WILL BE CONTINUOUS TO PROPOSED SIGNAL POLE FOUNDATION FROM CONTROLLER BOX, WITH 3 FEET SLACK AT BOTH ENDS.

SEE SHEETS 80 - 96 FOR TRAFFIC CONTROL PLANS.

SEE SHEETS 5 AND 5A FOR TRAFFIC NOTES AND PAY ITEMS.

**PROPOSED SIGNS**

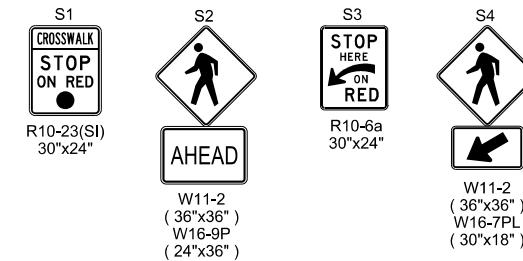

**NOTE:**  
SIGNS ARE SHOWN ON THIS SHEET FOR INFORMATION ONLY. REFER TO TO SIGNING AND STRIPING PLANS, SHEETS 73-77.

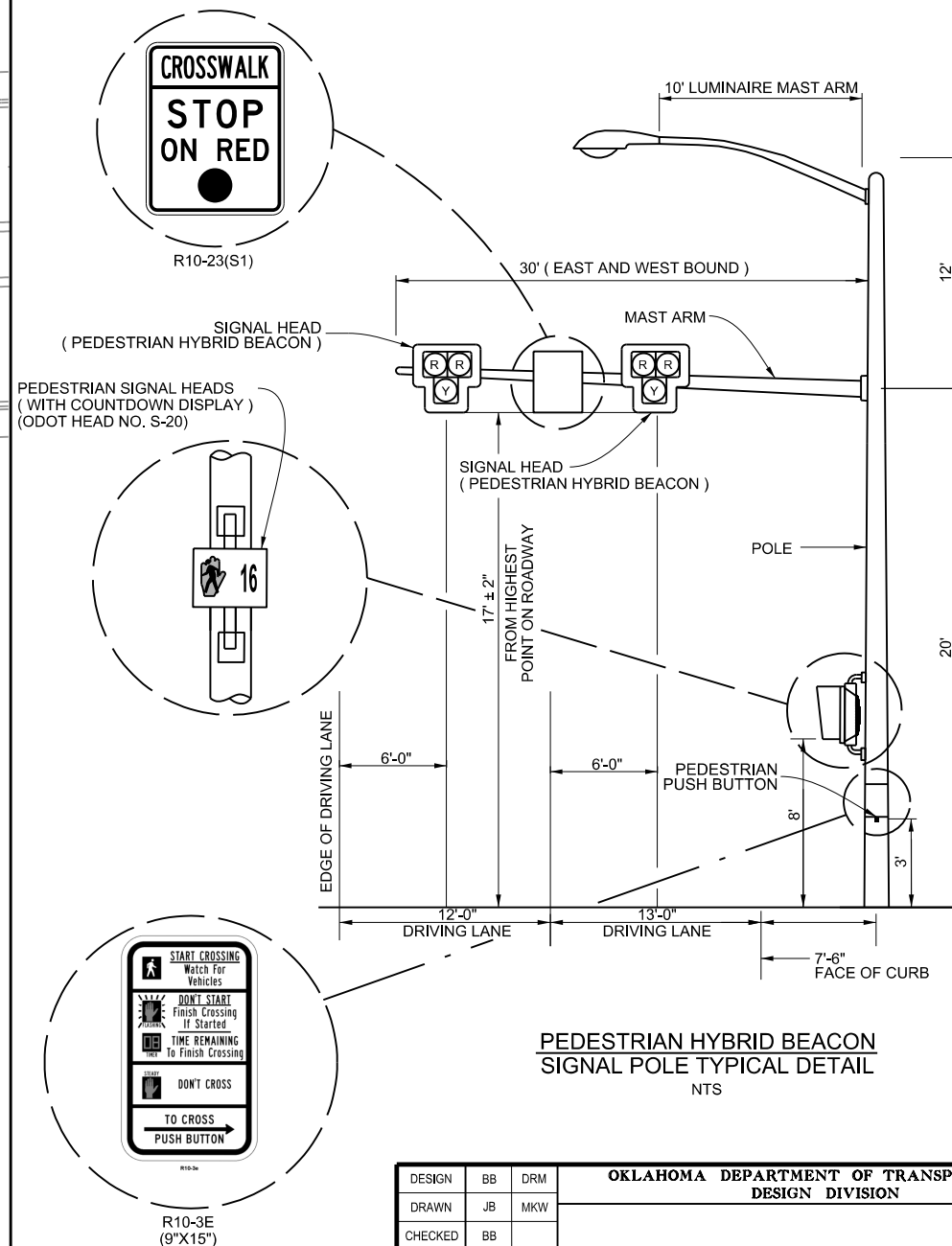
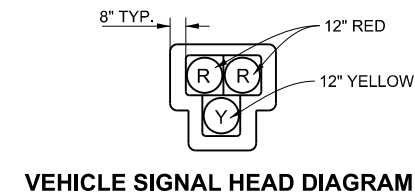

DESIGN	BB	DRM	OKLAHOMA DEPARTMENT OF TRANSPORTATION DESIGN DIVISION	
DRAWN	JB	MKW	PEDESTRIAN SIGNAL PLAN	
CHECKED	BB			
APPROVED	GC			
SQUAD	JACOBS			

JOB PIECE NO. 20839(08) SHEET NO. T008

PRINT DATE: 8/7/2017 F:\Jobs\WKM2300 - EC1335 (TEXAS CO)\700CADD\702CIVIL\WKM2300\_PSP1.dgn