

OKLAHOMA DEPARTMENT OF TRANSPORTATION					
FED. ROAD DIST. NO.	STATE	PROJ. NO.	FISCAL YEAR	SHEET NO.	TOTAL SHEETS
6	OKLA.			S001	
DESCRIPTION		REVISIONS		DATE	

# SURVEY DATA SHEETS

## SURVEY CONTROL DATA

### 1. HORIZONTAL CONTROL:

A. HORIZONTAL CONTROL FOR THIS SURVEY IS THE NGS OKLAHOMA STATE PLANE COORDINATE SYSTEM, NAD83 (1993), LAMBERT PROJECTION (NORTH ZONE).

B. ACCURACY - THE PRIMARY CONTROL NETWORK, THE SECONDARY CONTROL NETWORK AND SECTION BOUNDARIES FOR THIS SURVEY ARE IN GENERAL COMPLIANCE WITH THE NGS SECOND ORDER, CLASS II STANDARDS FOR HORIZONTAL CONTROL ( 1:20,000).

### 2. BEARINGS:

THE BEARINGS SHOWN HEREIN OR HEREON ARE GRID BEARINGS DERIVED FROM THE NGS OKLAHOMA STATE PLANE COORDINATE SYSTEM AND ARE NOT ASTRONOMICAL. THE ANGLE OF VARIANCE BETWEEN GRID NORTH (GN) AND THE ASTRONOMICAL TRUE NORTH (TN) IS DEPICTED DIAGRAMMATICALLY.

### 3. VERTICAL CONTROLS:

A. LEVEL DATUM IS NAVD 88.

B. ACCURACY - VERTICAL CONTROL FOR THIS SURVEY IS WITHIN THE CLOSURE REQUIREMENT OF NOAA/NGS "CLASSIFICATION, STANDARDS OF ACCURACY, AND GENERAL SPECIFICATIONS OF GEODETIC CONTROL SURVEYS" (FEB. 1974, REPRINTED FEB. 1977) THIRD ORDER STANDARDS AS A MINIMUM.

SURVEY BEGAN: OCTOBER 16, 2006.  
SURVEY COMPLETED: JUNE 30, 2006.

DARYL WILLIAMS, PROFESSIONAL LAND SURVEYOR II  
KEVIN FLECK, TRANSPORTATION SPECIALIST LEVEL III  
STEVE PERRING, TRANSPORTATION SPECIALIST LEVEL IV  
LLOYD TEETER, TRANSPORTATION SPECIALIST LEVEL II  
JOHN WILSON, TRANSPORTATION SPECIALIST LEVEL I

### EQUIPMENT:

LEICA GPS EQUIPMENT EE-120, EE-123, EE-125, EE-126  
EE-131, EE-142  
LEICA NA2002 DIGITAL LEVEL EL-0475  
LEICA 1101 TOTAL STATION

### Electronic File Transfer Disclaimer:

These Files, Drawings and/or Notes are provided for information only. The Oklahoma Department of Transportation (ODOT) and the Owner cannot be held responsible for the content or accuracy of these Files, Drawings and/or Notes due to conversions, software translations, or any other manipulation of said Files, Drawings and/or Notes. ODOT expressly disclaims any responsibility arising from any use of these Files, Drawings and/or Notes. To the full extent permitted by applicable law, the recipient of these Files, Drawings and/or Notes hereby agrees to defend, indemnify, and hold harmless ODOT and the Owner from and against any and all claims, suits, actions, damages, loss, liability or costs of every nature or description (including reasonable attorney's fees) arising from, or in any way attributable to or connected with any of these Files, Drawings and/or Notes.

## PROJECT LOCATION

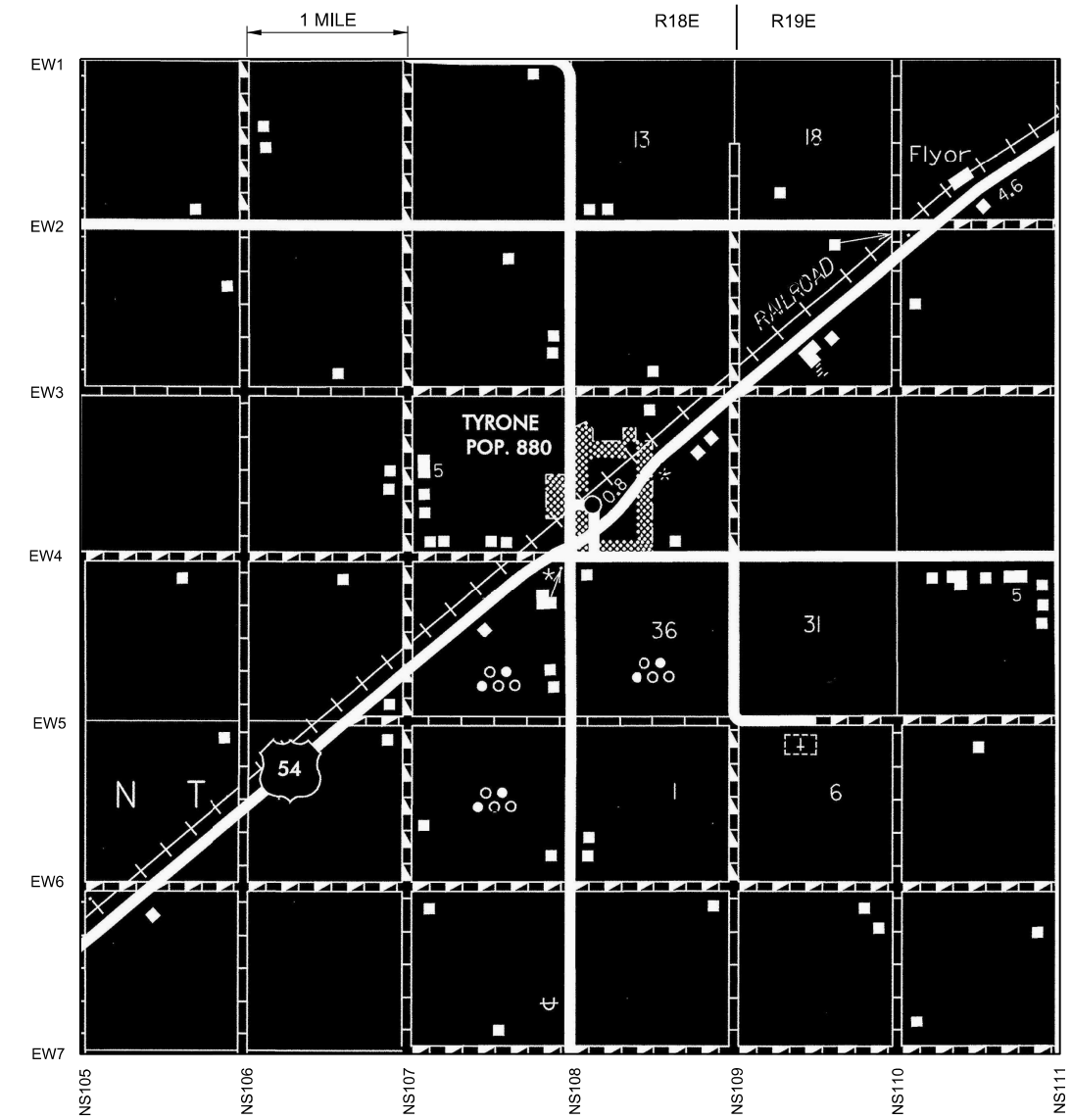

### INDEX OF SURVEY SHEETS

1. TITLE SHEET
2. HORIZONTAL CONTROL DIAGRAM & DATA
3. HISTORICAL LETTER & WRITTEN REPORT & ALIGNMENT REPORT
4. COGO POINTS
- 5-6. BENCHMARK LIST
- 7-15 SURVEY DATA SHEETS
- 16-22 GEOMETRIC DATA SHEETS

STATE OF OKLAHOMA  
DEPARTMENT OF TRANSPORTATION

SWO 4251 Job/Piece 20947 (04) Engr.Contract No. \_\_\_\_\_

### LAND SURVEYOR'S CERTIFICATION

I hereby certify that all land and property sub-division distances, angles, corners and monumentation made or used in conjunction with this survey and depicted or recorded herein or hereon were recovered, established or re-established in substantial conformity with:

- applicable instructions contained in the U.S. Government Bureau of Land Management publication "Manual of Surveying Instructions";
- its supplement, "Restoration of Lost or Obliterated Corners and Subdivision of Sections";
- "Oklahoma Minimum Standards for the Practice of Land Surveying" as adopted by the State Board of Registration for Professional Engineers and Land Surveyors; and
- sound land surveying practices;

Including a thorough search, study, analysis and consideration of all existing records and field evidence.

I further certify that all survey monuments depicted exist and that all land survey work was done by me or under my direct supervision and that it is true, accurate and correct to the best of my knowledge and belief.

Dated this 27th day of APRIL, 2007.

(seal)

Land Surveyor \_\_\_\_\_  
Signature

Daryl Williams  
Printed Name

Oklahoma Registered Land Surveyor No. 1444

Certificate of Authorization No. \_\_\_\_\_ Exp. Date \_\_\_\_\_

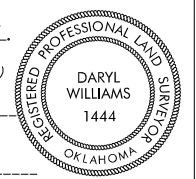

## TEXAS COUNTY U.S. 54

SWO 4251(1)  
STATE JOB NO. 20947(04)  
SECTION ONE

### CONVENTIONAL SYMBOLS

- RAILROADS
- RANGE & TOWNSHIP
- SECTION LINES
- QUARTER SECTION LINES
- FENCES
- EXISTING ROADS
- BASE LINE
- TELEPHONE & TELEGRAPH
- POWER LINES
- BUILDINGS
- OIL WELL
- DRAINAGE STRUCTURES - IN PLACE

### SCALES

1" = 100  
1" = 500

THIS SURVEY MEETS THE OKLAHOMA MINIMUM STANDARDS FOR THE PRACTICE OF LAND SURVEYING AS ADOPTED BY THE OKLAHOMA STATE BOARD OF REGISTRATION FOR PROFESSIONAL ENGINEERS AND LAND SURVEYORS, JUNE 11, 2001.

SPECIFICATIONS FOR SURVEYS FOR PRIMARY AND SECONDARY HIGHWAYS DATED SEPTEMBER 11, 2001 GOVERN.

OKLAHOMA DEPARTMENT OF TRANSPORTATION SURVEY DIVISION			
PLS	DKW		
DRAWN	KDF		
CHECKED	SJP		
APPROVED			
CREW	CLINTON	SWO 4251(1)	STATE JOB NO. 20839(08) SHEET NO. S001

## SURVEY DATA SHEET

SHEET 1 OF 22

PRINT DATE: 8/7/2017 F:\p\w\k\m\2300 - EC-1335 (TEXAS CO)\700CADD\702CIVIL\W\K\M\2300\_S01.dgn