

PHASE 3 SHIFT TRAFFIC TO UTILIZE LANE AND SHOULDER CONSTRUCTED IN PHASE 2.
 REMOVE TEMPORARY AND EXISTING DRAINAGE STRUCTURES.
 CONSTRUCT WESTBOUND DITCHES & DRAINAGE STRUCTURES.
 CONSTRUCT WESTBOUND LANE/SHOULDER/CURB/GUTTER/SIDEWALK/DRIVEWAYS.
 LEAVE PHASE 2 TEMPORARY PAVEMENT WIDENING IN PLACE (TO BE REMOVED IN FUTURE PROJECTS).

ONLY ONE OF THE FOLLOWING STREETS MAY BE CLOSED AT ONE TIME:

- DUFFY STREET
- KENTUCKY STREET
- 5TH STREET

THE CONTRACTOR SHALL MAINTAIN ACCESS FOR ALL ADJACENT PROPERTIES THROUGHOUT CONSTRUCTION.

SEC. 35, T-6-N, R-18-E

540+00

BM 122

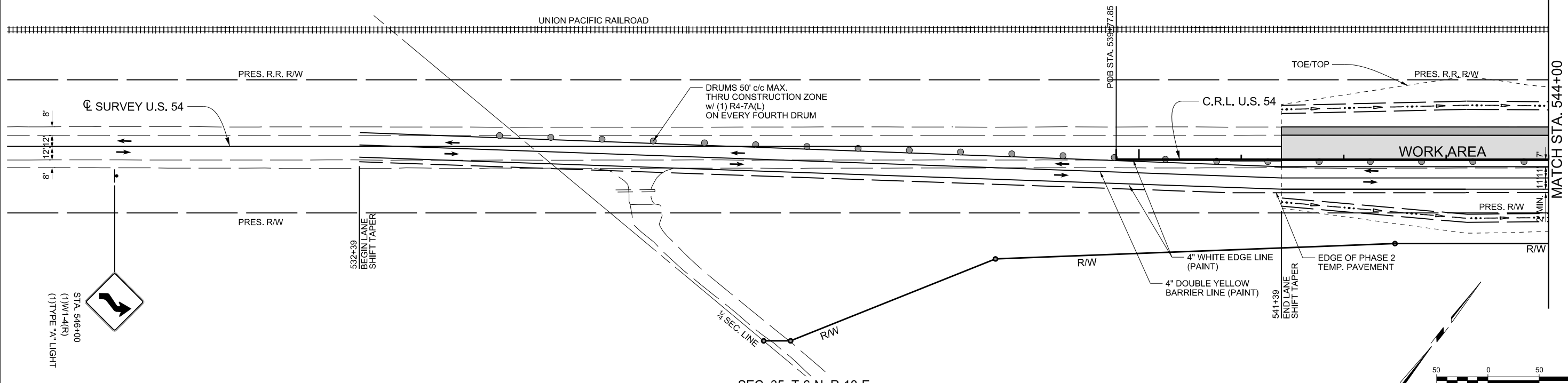

SEC. 35, T-6-N, R-18-E

SEC. 35, T-6-N, R-18-E

555+00

550+00

545+00

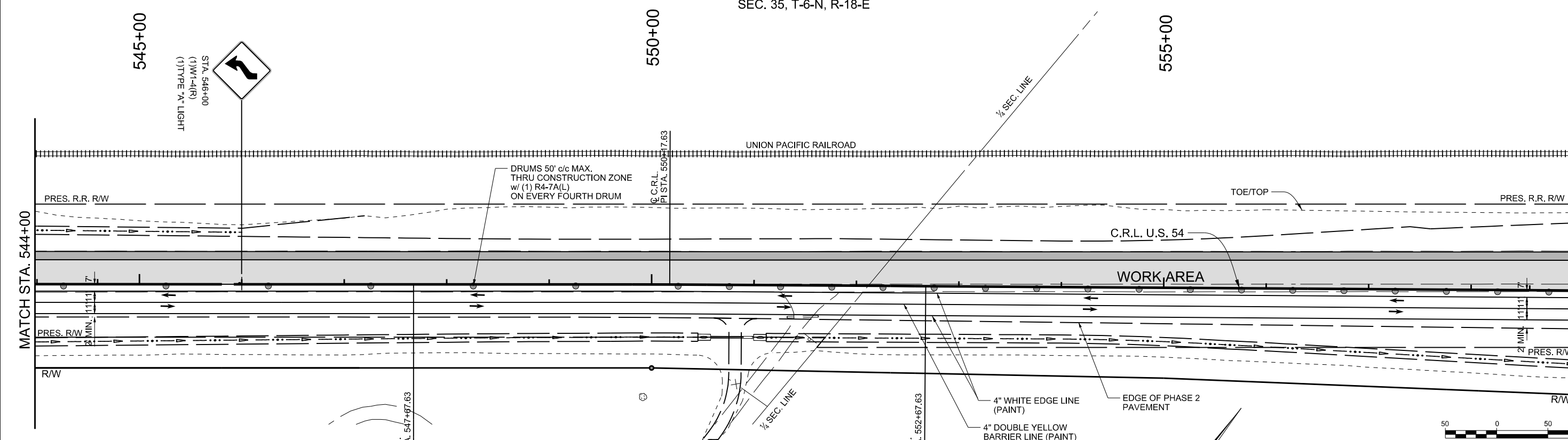

SEC. 35, T-6-N, R-18-E

PRINT DATE: 8/7/2017 F:\job\WKM2300 - EC1335 (TEXAS GO)\700CADD\702CIVIL\WKM2300 Phase 3 SEQ SH1.dgn

DESIGN	BB	DRM
DRAWN	JB	MKW
CHECKED	BB	
APPROVED	GC	
SQUAD	JACOBS	

OKLAHOMA DEPARTMENT OF TRANSPORTATION
 DESIGN DIVISION

CONSTRUCTION SEQUENCE SHEET (11)
 PHASE 3

JOB PIECE NO. 20839(08) SHEET NO. R054