

PHASE 2 UTILIZE EXISTING PIPE/BOX AND REBUILD TO C.R.L.
 PROVIDE INSTALLED PORT. LONGITUDINAL BARRIER UNTIL FILL
 MATERIAL OVER STRUCTURE HAS BEEN COMPACTED.
 SHIFT TRAFFIC TO UTILIZE PAVEMENT WIDENING DESCRIBED IN PHASE 1.
 CONSTRUCT EASTBOUND DITCHES & DRAINAGE STRUCTURES.
 CONSTRUCT EASTBOUND LANE/SHOULDER/CURB/GUTTER/SIDEWALK/DRIVEWAYS.
 CONSTRUCT TEMPORARY PAVEMENT WIDENING TO SERVE PHASE 3 TRAFFIC.

ONLY ONE OF THE FOLLOWING STREETS MAY BE CLOSED AT ONE TIME:
 • DUFFY STREET
 • KENTUCKY STREET

THE CONTRACTOR SHALL MAINTAIN ACCESS FOR ALL ADJACENT PROPERTIES THROUGHOUT CONSTRUCTION.

SEC. 25, T-6-N, R-18-E

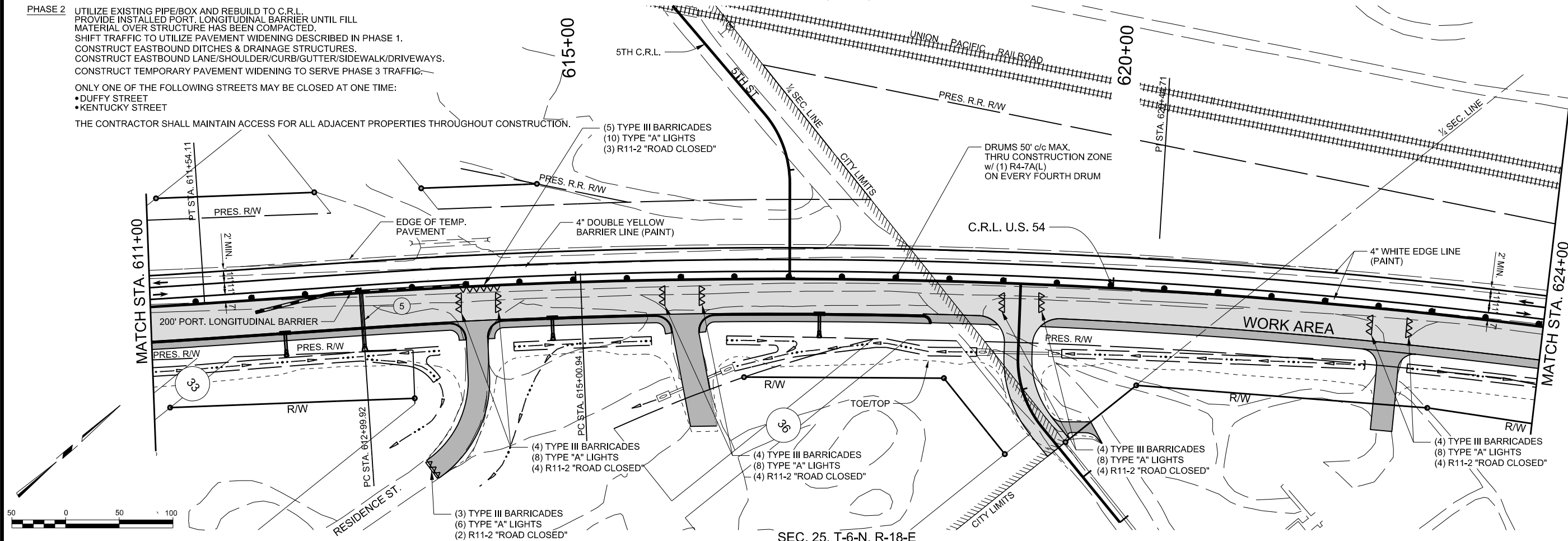

SEC. 25, T-6-N, R-18-E
 SEC. 25, T-6-N, R-18-E

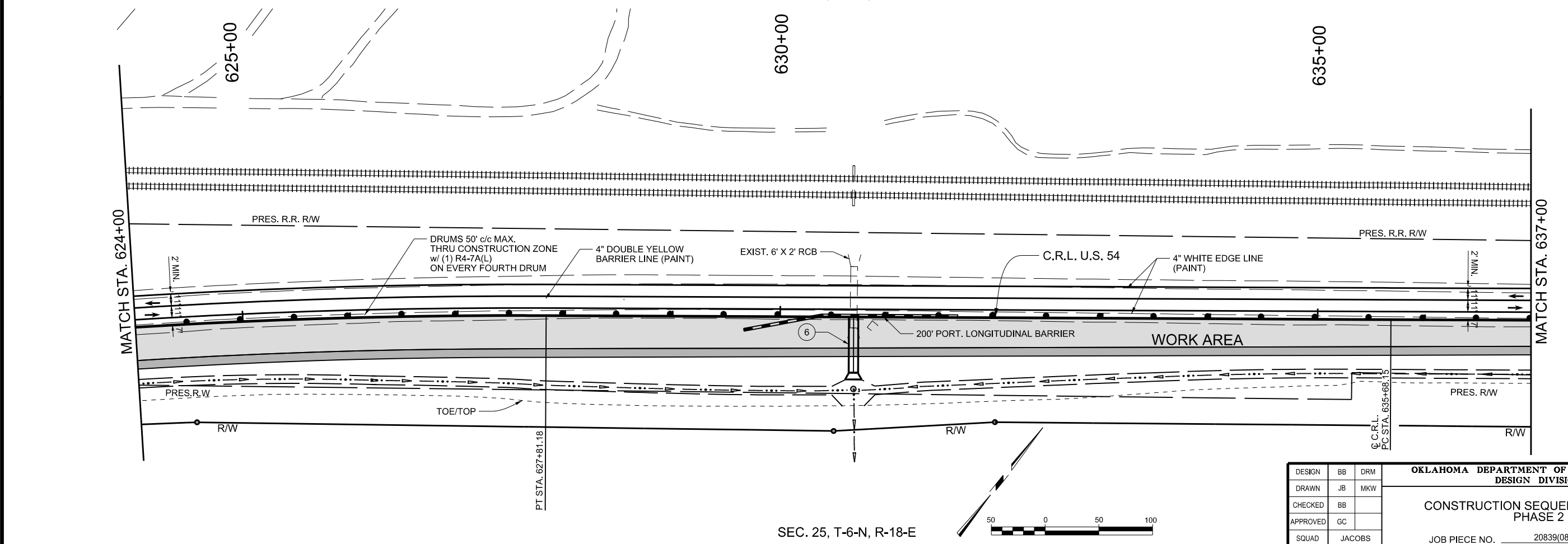

SEC. 25, T-6-N, R-18-E

PRINT DATE: 8/7/2017 F:\job\WKM2300 - EC1335 (TEXAS CO)\700CADD\702CIVIL\WKM2300 Phase 2 SEQ SH4.dwg

DESIGN	BB	DRM	OKLAHOMA DEPARTMENT OF TRANSPORTATION DESIGN DIVISION CONSTRUCTION SEQUENCE SHEET (9) PHASE 2 JOB PIECE NO. 20839(08) SHEET NO. R052
DRAWN	JB	MKW	
CHECKED	BB		
APPROVED	GC		
SQUAD	JACOBS		