

PHASE 1 CONSTRUCT TEMPORARY PAVEMENT WIDENING ALONG WESTBOUND SHOULDER.

ONLY ONE OF THE FOLLOWING STREETS MAY BE CLOSED AT ONE TIME:

- DUFFY STREET
- KENTUCKY STREET
- 5TH STREET

THE CONTRACTOR SHALL MAINTAIN ACCESS FOR ALL ADJACENT PROPERTIES THROUGHOUT CONSTRUCTION.

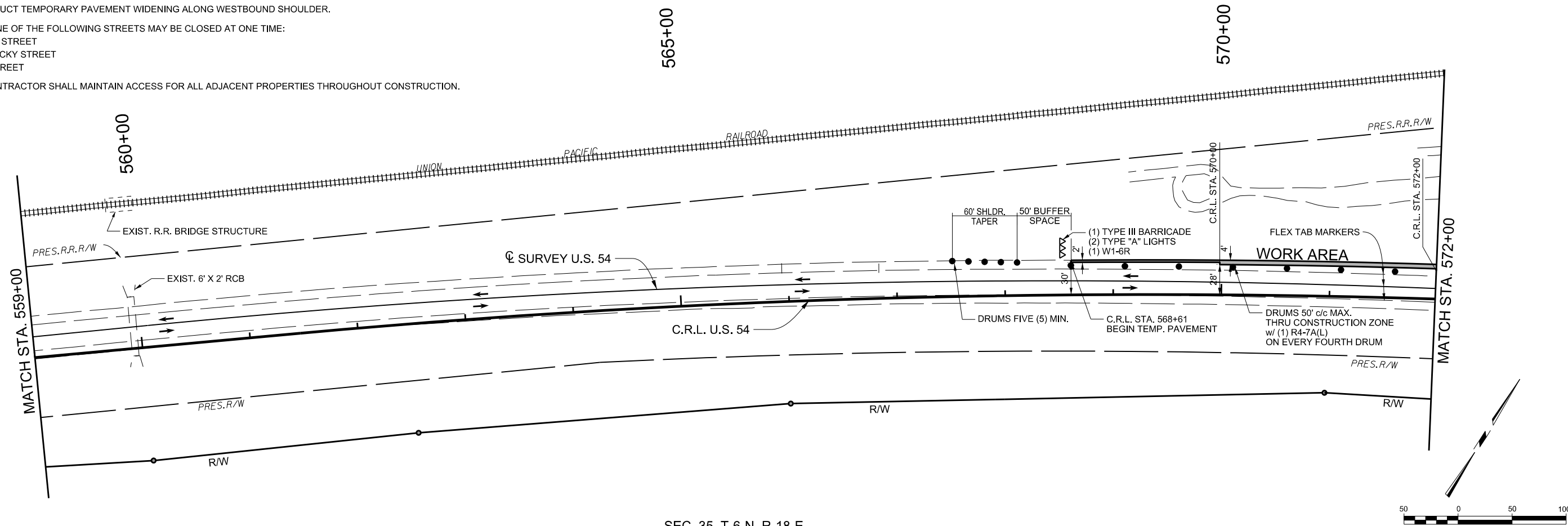

SEC. 35, T-6-N, R-18-E

SEC. 26, T-6-N, R-18-E

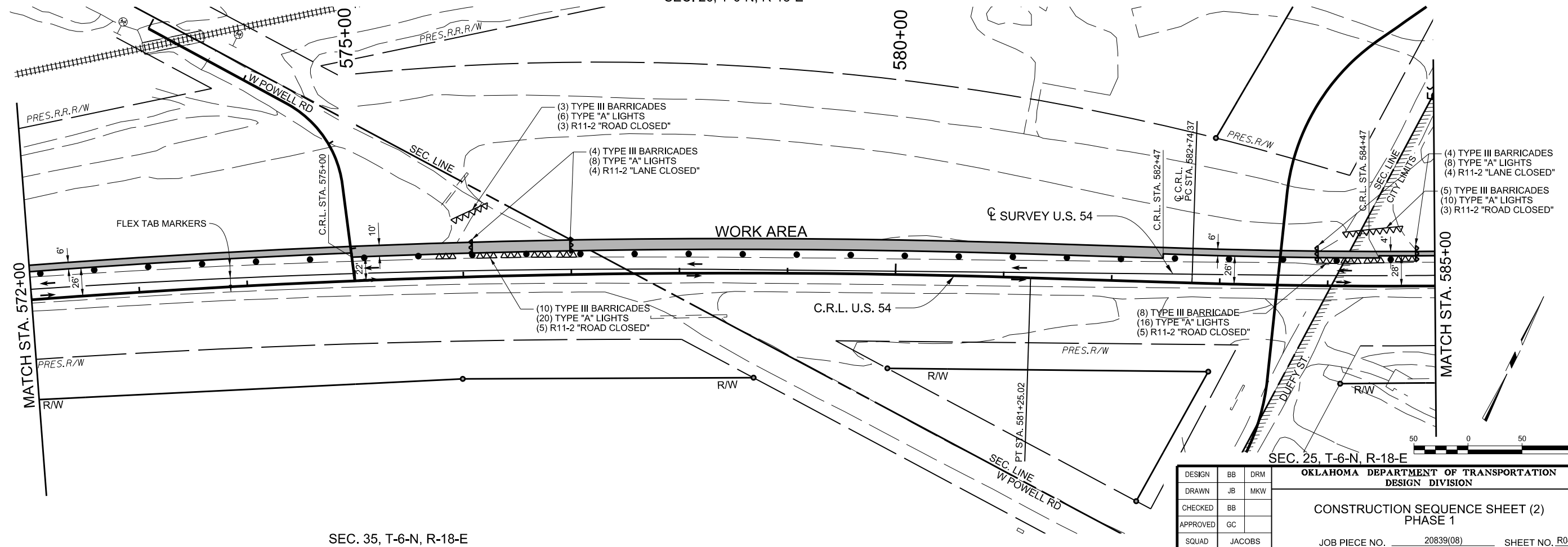

SEC. 35, T-6-N, R-18-E

SEC. 25, T-6-N, R-18-E

DESIGN	BB	DRM	OKLAHOMA DEPARTMENT OF TRANSPORTATION DESIGN DIVISION CONSTRUCTION SEQUENCE SHEET (2) PHASE 1 JOB PIECE NO. 20839(08) SHEET NO. R045
DRAWN	JB	MKW	
CHECKED	BB		
APPROVED	GC		
SQUAD	JACOBS		

PRINT DATE: 8/7/2017 F:\job\WKM2300-EC1335 (TEXAS CO)\700CADD\702CIVIL\WKM2300 Phase 1 SEQ SH2.dwg