

REVISIONS	DATE
DESCRIPTION REV. SPECIFIC DEVICES TO BE USED	09-13-2017

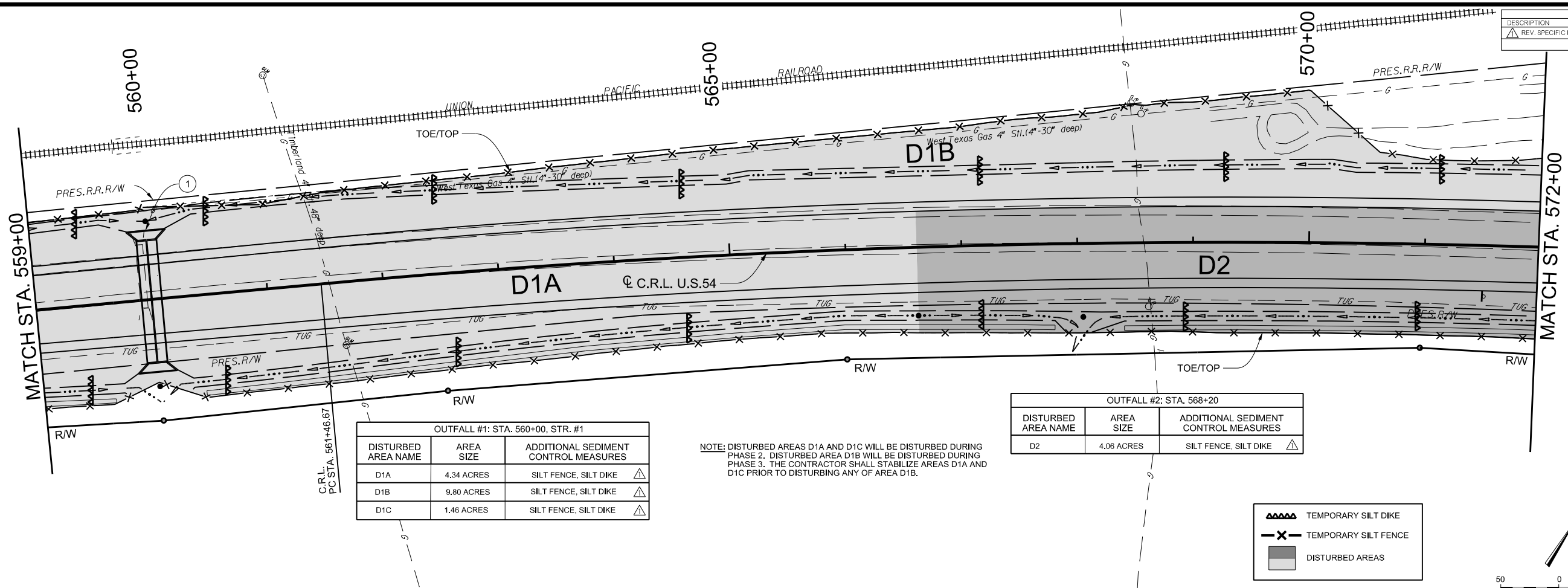

OUTFALL #1: STA. 560+00, STR. #1

DISTURBED AREA NAME	AREA SIZE	ADDITIONAL SEDIMENT CONTROL MEASURES
D1A	4.34 ACRES	SILT FENCE, SILT DIKE
D1B	9.80 ACRES	SILT FENCE, SILT DIKE
D1C	1.46 ACRES	SILT FENCE, SILT DIKE

OUTFALL #2: STA. 568+20

DISTURBED AREA NAME	AREA SIZE	ADDITIONAL SEDIMENT CONTROL MEASURES
D2	4.06 ACRES	SILT FENCE, SILT DIKE

NOTE: DISTURBED AREAS D1A AND D1C WILL BE DISTURBED DURING PHASE 2. DISTURBED AREA D1B WILL BE DISTURBED DURING PHASE 3. THE CONTRACTOR SHALL STABILIZE AREAS D1A AND D1C PRIOR TO DISTURBING ANY OF AREA D1B.

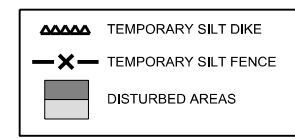

SEC. 35, T-6-N, R-18-E

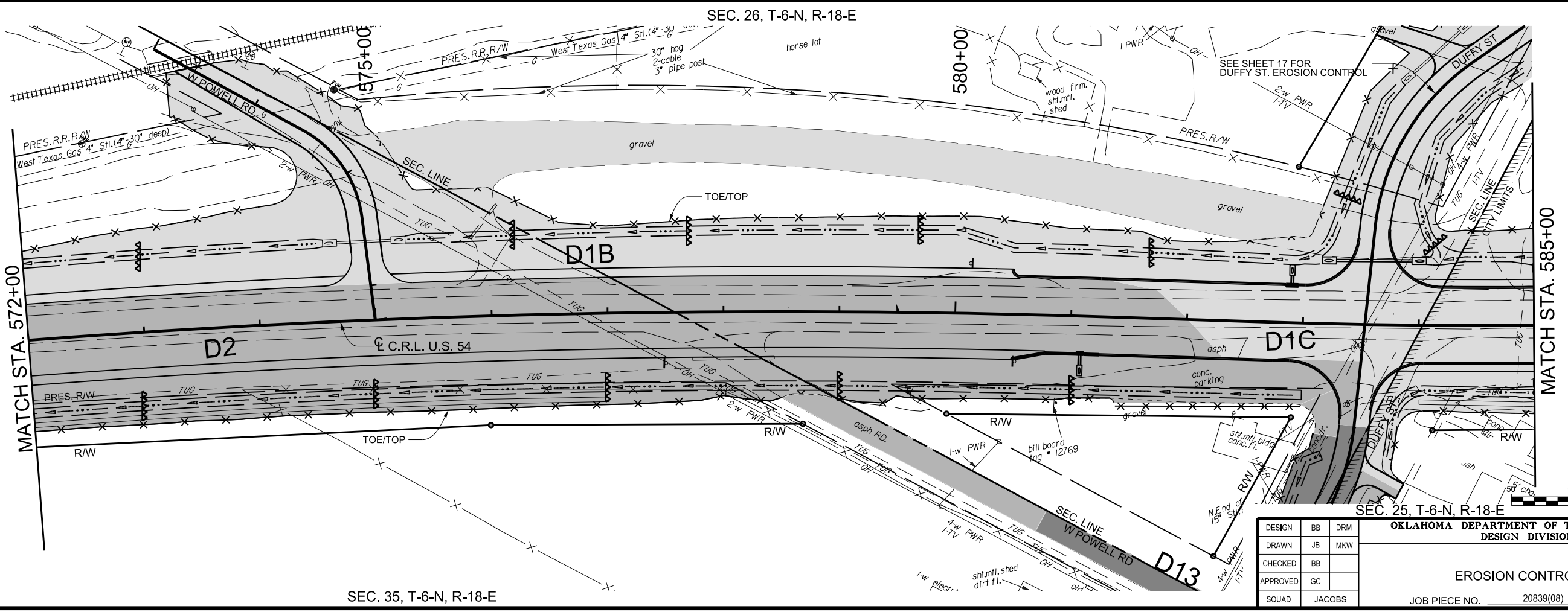

DESIGN	BB	DRM
DRAWN	JB	MKW
CHECKED	BB	
APPROVED	GC	
SQUAD	JACOBS	

OKLAHOMA DEPARTMENT OF TRANSPORTATION  
DESIGN DIVISION

EROSION CONTROL (2)

JOB PIECE NO. 20839(08) SHEET NO. R005



SEC. 35, T-6-N, R-18-E

SEC. 26, T-6-N, R-18-E

SEC. 25, T-6-N, R-18-E

PRINT DATE: 9/13/2017 I:\OKC\FLO3\Draw\Wk\X2300 - EC1335 (TEXAS CO)\800\DELM\820\DRAWINGS\2017-2018-05 Revision\Wk\X2300.ERC02.dgn