

SECTION 4
T-10-N, R-13-W

410+00

405+00

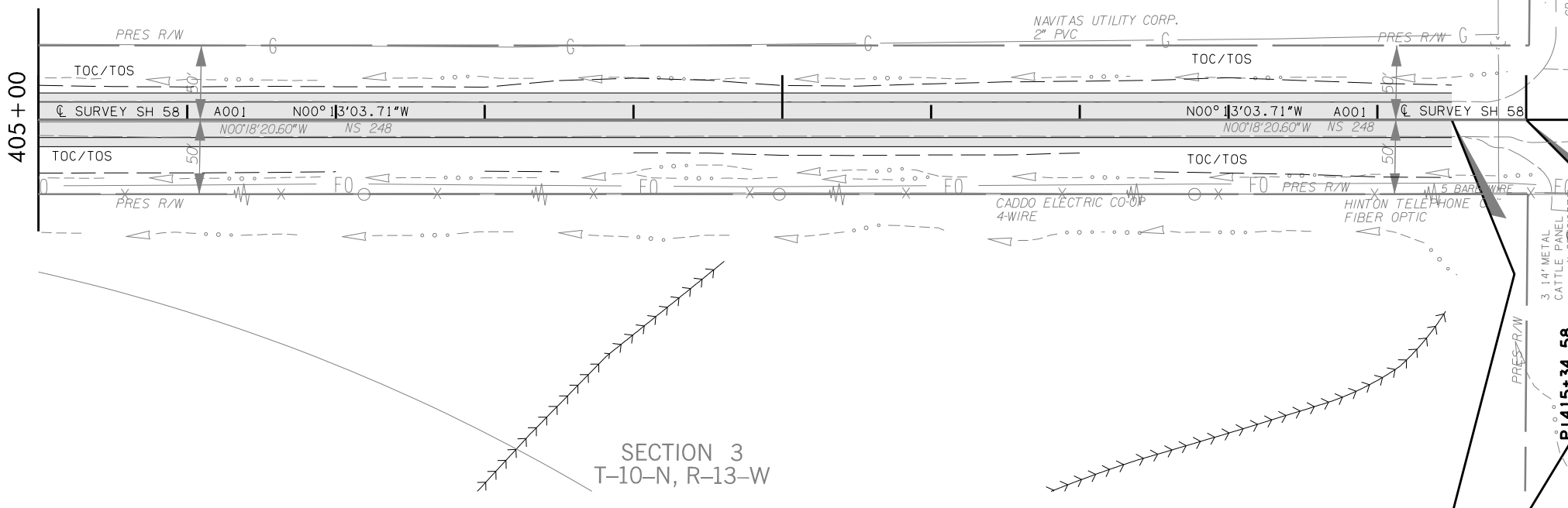

SECTION 3
T-10-N, R-13-W

BM 80d NAIL IN WEST SIDE OF POWER POLE 49' RT.,
STA. 407+19 ELEV. = 1611.97

BM 1" IRON PIN, ODOT MON. NO. C-8-1240, (7405) 57' RT.,
STA. 415+06 ELEV. = 1618.08

80d NAIL IN SE SIDE OF CORNER POST 50' LT.,
STA. 416+56 ELEV. = 1615.08

