

SECTION 28  
T-10-N, R-13-W

SECTION 21  
T-10-N, R-13-W

SECTION 27  
T-10-N, R-13-W

SECTION 22  
T-10-N, R-13-W

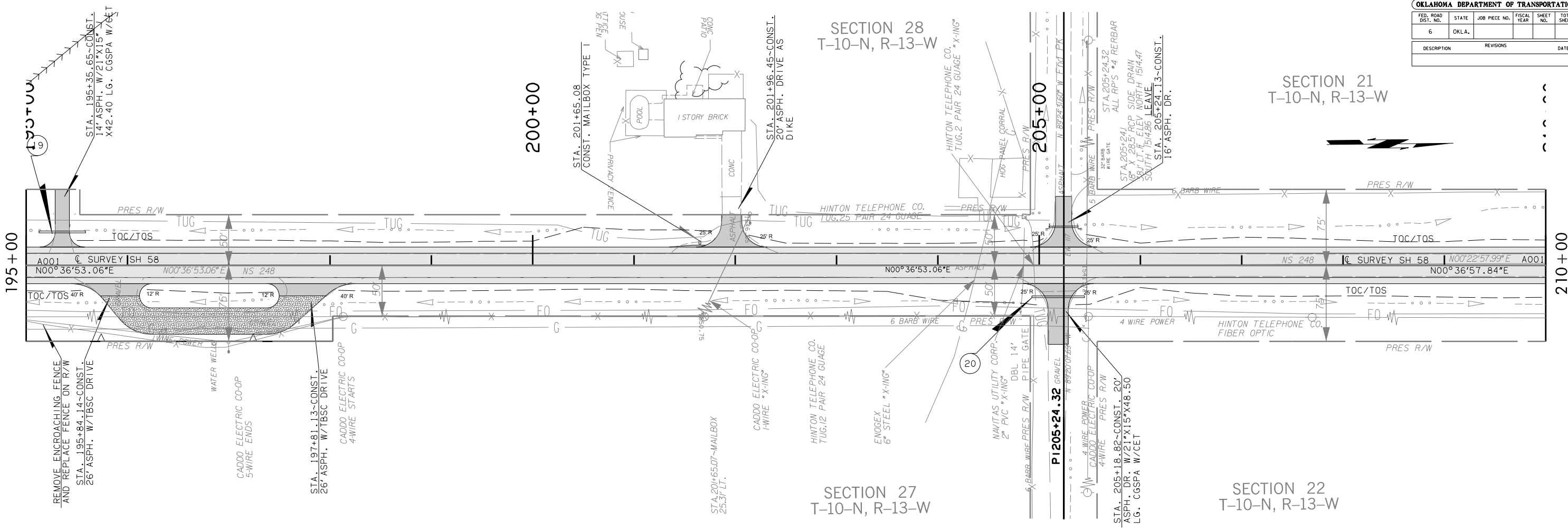

BM "+" IN CENTER P.I. OF "L" SHAPED HDWL., IN SOUTHWEST QUADRANT OF INTERSECTION. 36' LT., STA. 205+10 = BM "+" ON NORTHEAST COR. OF SOUTH HDWL., STA. 124+10 ON SAP NO. 775(2) PARTS 1, 2 & 3, SH 58 CADDO COUNTY PLANS. STA. 205+10 ELEV. = 1517.48

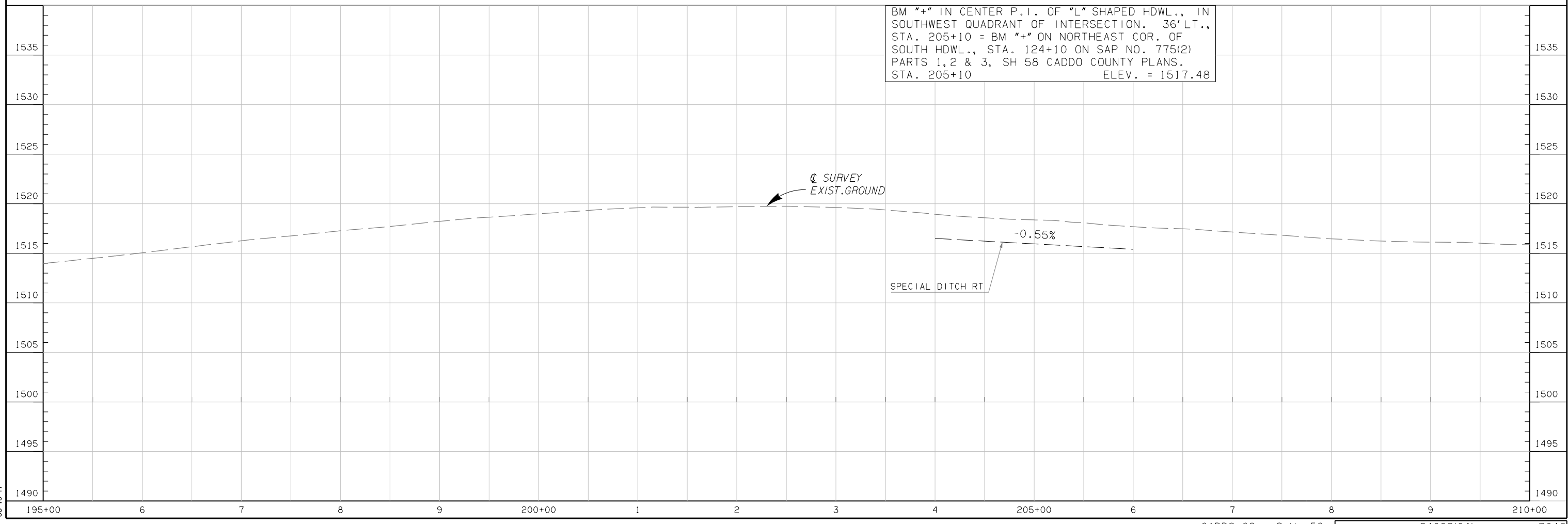

05-10-17