

OKLAHOMA DEPARTMENT OF TRANSPORTATION					
FED. ROAD DIST. NO.	STATE	PROJ. NO.	FISCAL YEAR	SHEET NO.	TOTAL SHEETS
	OKLA.				
DESCRIPTION		REVISIONS		DATE	

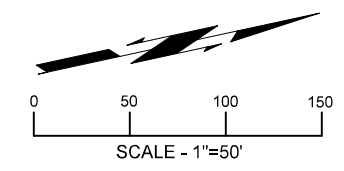

Sta. 1106+98.30 18" x 18" x 43' RCP
Xing. at 216' Lt. & 201' Rt.
Elev. = 880.6 Lt. & 882.0 Rt.

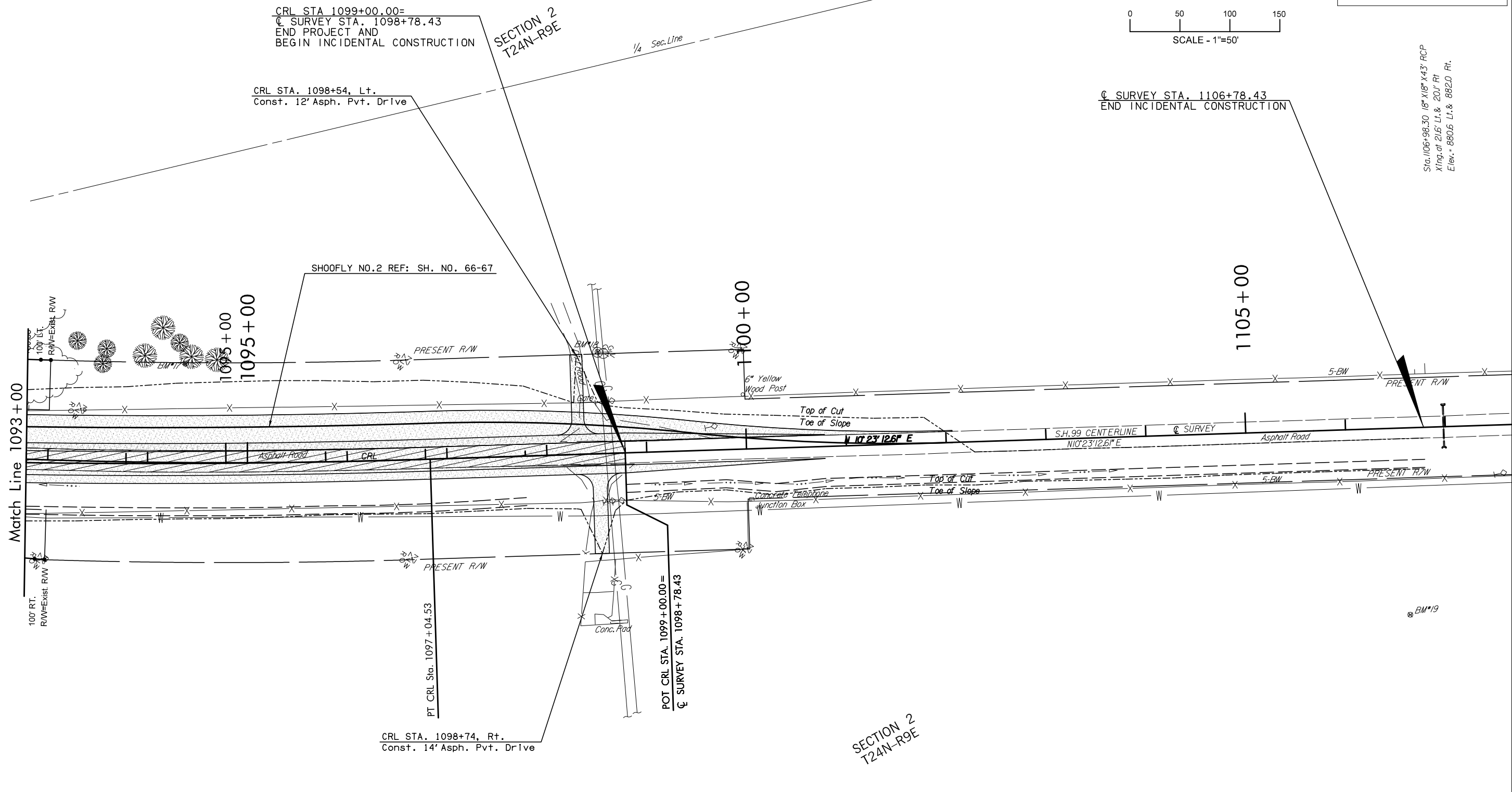

DSMR: XXX PLOTTED BY: loyde@okdot.gov 6/9/2017 10:45:39 AM

	- MAINLINE PAVEMENT
	- SHOOFLY PAVEMENT
	- PAVEMENT REMOVAL
	- SPECIAL DITCH
	- CONC. DITCH LINING

- BM 17 - 80D NAIL IN 18" TREE
Sta. 1094+37, 99' LT. Elev. = 878.03
- BM 18 - TOP OF GAS VENT PIPE
Sta. 1098+54, 102' LT. Elev. = 887.56
- BM 19 - 80D NAIL IN 14" TREE
Sta. 1106+59, 187' RT. Elev. = 887.95

DESIGN		OKLAHOMA DEPARTMENT OF TRANSPORTATION DESIGN DIVISION SH-99 OVER BIRCH CREEK OSAGE COUNTY STATE HIGHWAY 99 PLAN STATE JOB NO. 24261(04) SHEET NO. 63 OSAGE CO. SH-99
DRAWN		
CHECKED		
APPROVED		
SQUAD		