

PRINT DATE: 12/19/2016 T:\1209\Drawings\Roadway\1209-S-X\Sections.dgn

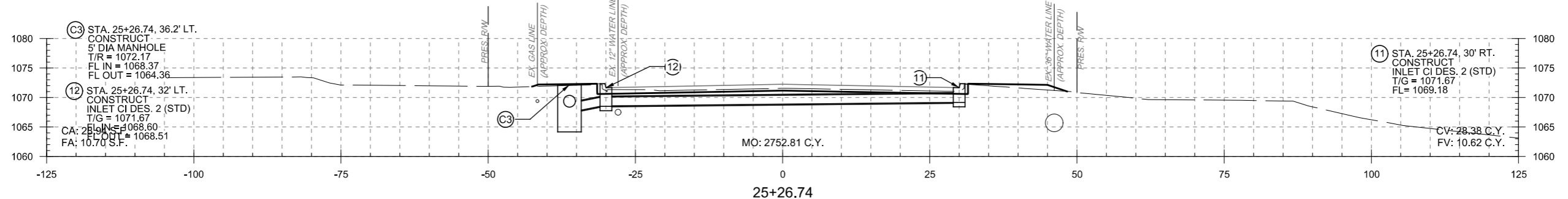
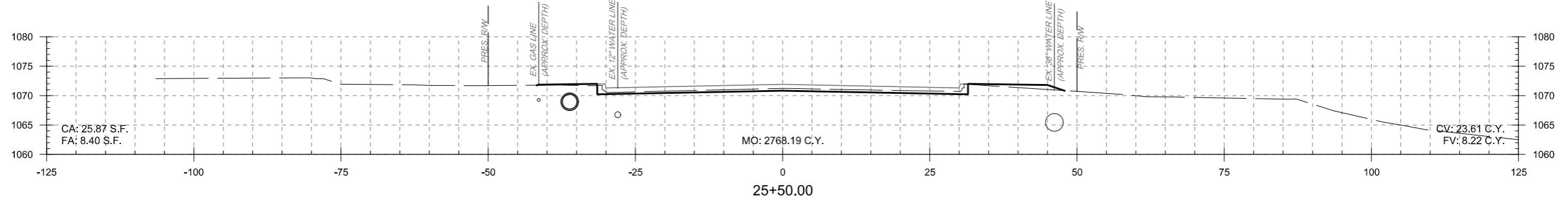
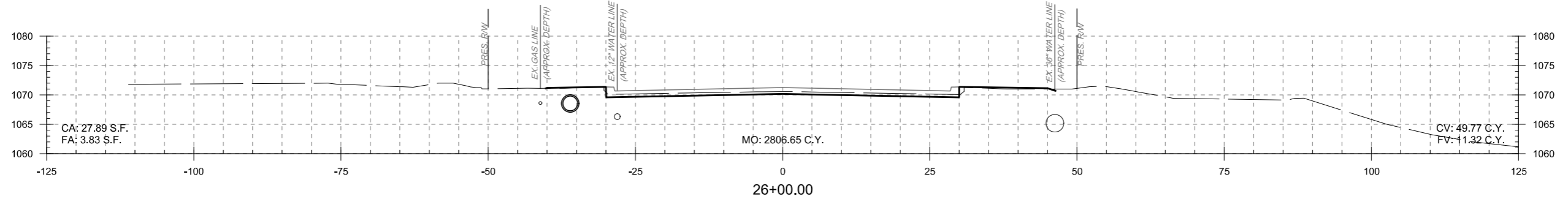
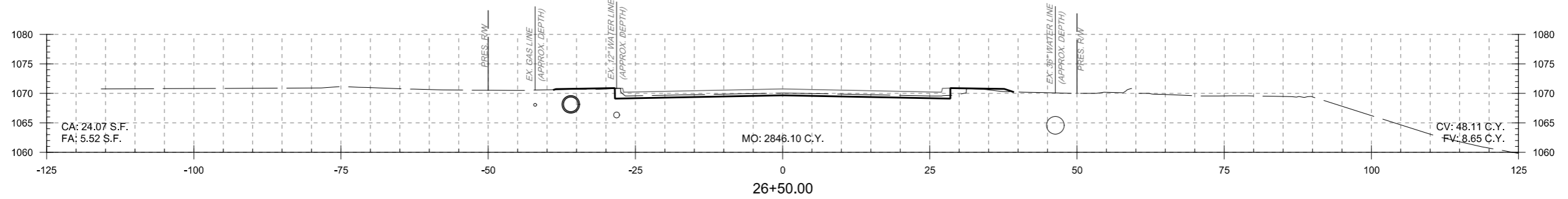
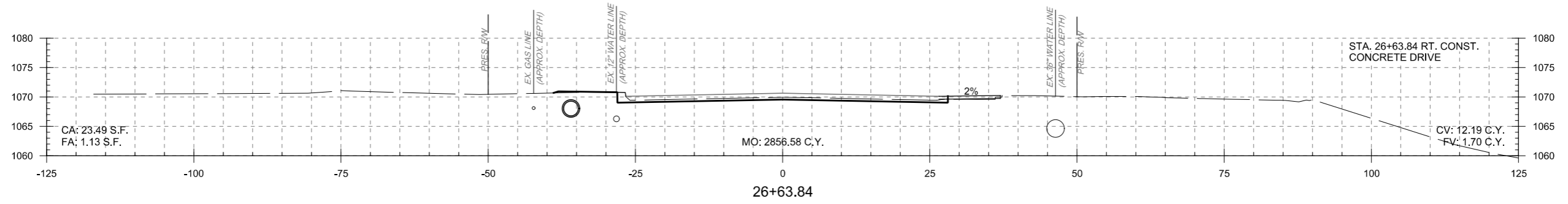

(C3) STA. 25+26.74, 36.2' LT.  
 CONSTRUCT  
 5' DIA MANHOLE  
 T/R = 1072.17  
 FL IN = 1068.37  
 FL OUT = 1064.36  
 (12) STA. 25+26.74, 32' LT.  
 CONSTRUCT  
 INLET CI DES. 2 (STD)  
 T/G = 1071.67  
 FL IN = 1068.60  
 FL OUT = 1068.51

(11) STA. 25+26.74, 30' RT.  
 CONSTRUCT  
 INLET CI DES. 2 (STD)  
 T/G = 1071.67  
 FL = 1069.18

NORTH WESTERN AVE. OKLAHOMA CO.

DESIGN	KG
DRAWN	NDA
CHECKED	KA
APPROVED	
SQUAD	MacArthur

OKLAHOMA DEPARTMENT OF TRANSPORTATION

STA.25+26.74 TO STA.26+63.84

STATE JOB NO. JP 30326(04) SHEET NO. X-12