

WORK AREA 110 CHANNELIZER CONES AT 50' C/C  
 250' TAPER - 10 CHANNELIZER CONES AT 25' C/C  
 N. WESTERN AVE.

1. CONTRACTOR SHALL KEEP 11' MINIMUM LANE WIDTHS UNLESS OTHERWISE NOTED.
2. CONTRACTOR SHALL MAINTAIN ACCESS TO ALL BUSINESSES, STREETS AND DRIVEWAYS.
3. REMOVE ALL CONFLICTING STRIPING

TRAFFIC DURING PHASE 3 CONST.

MATCH LINE - STA. 57+00

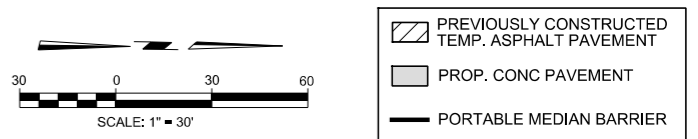
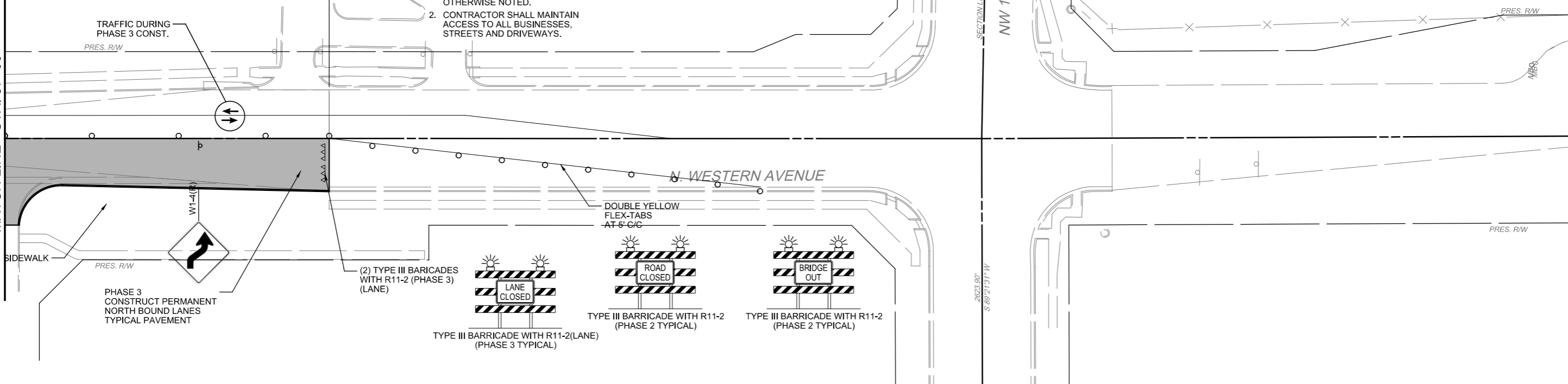

PRINT DATE: 12/19/2016 T:\1209\Drawings\Traffic\1209-S-Seq12.dgn

DESIGN	KG		NORTH WESTERN AVE.	OKLAHOMA CO.
DRAWN	NDA		<b>OKLAHOMA DEPARTMENT OF TRANSPORTATION</b>	
CHECKED	KA		<b>SEQUENCE OF CONSTRUCTION (11)</b>	
APPROVED			<b>PHASE III</b>	
SQUAD	MacArthur		STATE JOB NO. <u>JP 30326(04)</u> SHEET NO. <u>43</u>	