

STATE OF OKLAHOMA
DEPARTMENT OF TRANSPORTATION

PLAN OF PROPOSED
CITY STREET

RECONSTRUCTION AND ROADWAY WIDENING
AND WATERLINE LOWERING
WESTERN AVENUE FROM NW 178TH STREET TO NW 192ND STREET

OKLAHOMA COUNTY

OKLAHOMA CITY PROJECT No. PC-0441 (PHASE I) / WC-0860
FEDERAL AID PROJECT NO. STP-255B(360)AG Δ
JOB PIECE NO. 30326(04)

REVISIONS		
REV. NO.	DESCRIPTION	DATE
1	UPDATED PROJECT NUMBER	10-05-2017



The City of
OKLAHOMA CITY

MICK CORNETT Mayor

COUNCIL MEMBERS

JAMES GREINER Ward 1
ED SHADID Ward 2
LARRY McATEE Ward 3
TODD STONE Ward 4
DAVID GREENWELL Ward 5
MARGARET S. "MEG" SALTER Ward 6
JOHN A. PETTIS JR Ward 7
MARK STONECIPHER Ward 8

JAMES D. COUCH City Manager

ERIC J. WENGER, P.E. City Engineer

DESIGN DATA

AADT 2012 = 9,000
AADT 2032 = 17,870
K (DHV/ADT) = 9.5%
D = 60%
T (% ADT) = 3.0%
T3(% ADT) = 0.0%
V = 45 MPH
20yrFLEX ESALS = 4.3 M

NOTE: CONSTRUCTION ACTIVITIES THAT RESULT IN LAND DISTURBANCE OF EQUAL TO OR GREATER THAN ONE (1) ACRE, OR LESS THAN ONE (1) ACRE IF THEY ARE PART OF A LARGER COMMON PLAN OF DEVELOPMENT OR SALE THAT TOTALS AT LEAST ONE (1) ACRE MUST ALSO OBTAIN A PERMIT FROM ODEQ (FROM 605-002a) FOR STORM WATER DISCHARGE FROM CONSTRUCTION ACTIVITIES.

THIS MEANS THAT LAND DISTURBING OF ONE (1) ACRE OR MORE MUST PERMIT WITH ODEQ AND THE CITY OF OKLAHOMA CITY.

STORM WATER QUALITY

NOTE: THE USGS 7.5 MINUTES QUADRANGLE SHEETS INDICATE THAT "WATERS OF THE UNITED STATES" AND "WETLANDS" EXIST WITHIN THIS PROJECT. THE ISSUE OF "WATERS OF THE UNITED STATES" AND "WETLANDS" FALLS UNDER THE CORPS OF ENGINEERS (COE) TULSA DISTRICT REGULATORY DIVISION, BUT THE CITY IS OBLIGATED TO INSURE THAT ALL NECESSARY STATE AND FEDERAL PERMITS HAVE BEEN OBTAINED, PURSUANT TO 44 CFR 60.3. THEREFORE, THE APPLICANT IS REQUIRED TO SUBMIT DOCUMENTATION FROM THE COE SHOWING COE APPROVAL FOR PROPOSED WORK.

NOTE: A COPY OF THE EROSION CONTROL SITE PLAN MUST BE ON SITE AT ALL TIMES AND MADE AVAILABLE TO THE INSPECTOR UPON REQUEST.

NOTE: THE CONTRACTOR SHALL BE RESPONSIBLE FOR REPAIR OR REPLACEMENT OF ALL EROSION CONTROL DEVICES DAMAGED DUE TO CONSTRUCTION.

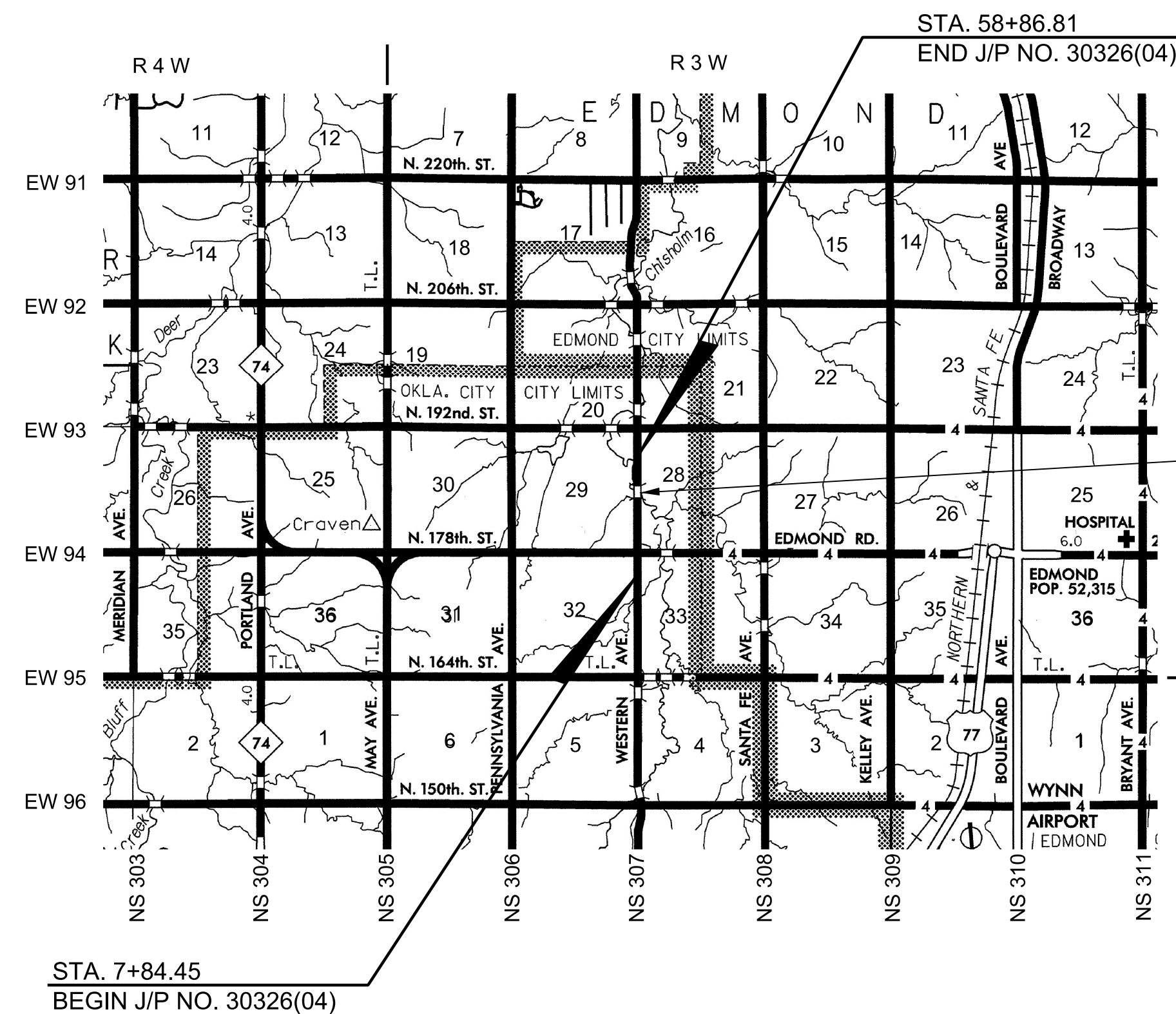

EXISTING BRIDGE EXCEPTION
BEGIN STA. 35+13.05
END STA. 36+93.40
LENGTH = 180.35'

INDEX OF SHEETS
SEE SHEET NO. 2

STANDARDS
SEE SHEET NO. 2

SCALES 1" = 50'
PLAN 1" = 50'
PROFILE HOR. 1" = 50'
VER. 1" = 5'
LAYOUT MAP 1" = 5280'

CONVENTIONAL SYMBOLS

- ASPHALT CONCRETE
- P.C. CONCRETE
- PAVEMENT REMOVAL
- PROPOSED ROAD
- RAILROADS
- RANGE & TOWNSHIP
- SECTION LINES
- QUARTER SECTION LINES
- FENCES
- GROUND LINE
- EXISTING ROADS
- BASE LINE
- GRADE LINES
- TELEPHONE & TELEGRAPH
- POWER LINES
- BUILDINGS
- OIL WELL
- DRAINAGE STRUCTURES - IN PLACE
- DRAINAGE STRUCTURES - NEW
- RIGHT-OF-WAY LINES - EXISTING
- RIGHT-OF-WAY LINES - NEW
- CONTROLLED ACCESS
- RIGHT-OF-WAY FENCE

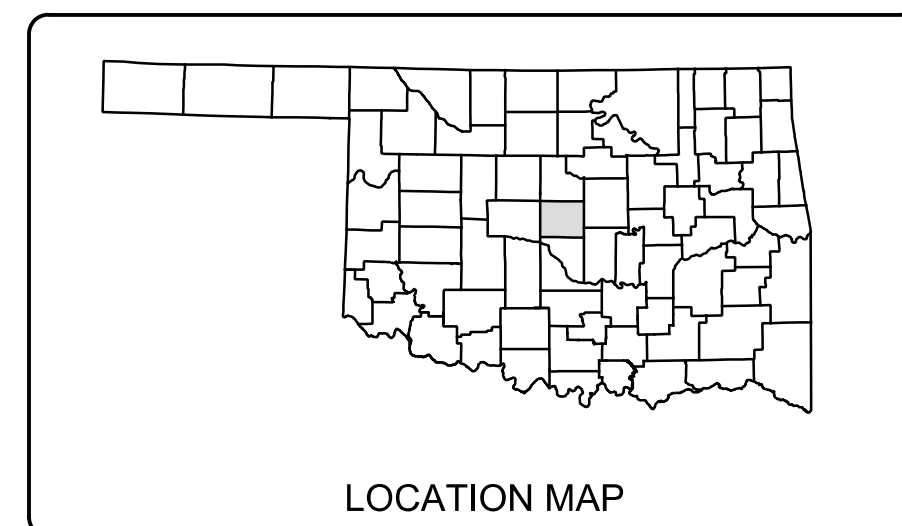

PROJECT LENGTH BASED ON C.R.L. STATIONING
ROADWAY LENGTH _____ 4922.01 FT. 0.932 MI.
BRIDGE EXCEPTION LENGTH _____ 180.35 FT. 0.034 MI.
PROJECT LENGTH _____ 5102.36 FT. 0.966 MI.

RECOMMENDED FOR APPROVAL

	8/25/17
ERIC J. WENGER, P.E. DIRECTOR PUBLIC WORKS, CITY ENGINEER	DATE
	8/29/17
SAM SAMANDI, P.E. ENGINEERING MANAGER	DATE
	8/29/17
CHRIS BROWNING GENERAL MANAGER OCWUT	DATE
APPROVED AS FINAL PLANS	
_____ MAYOR	_____ DATE
_____ CITY CLERK	_____ DATE

PROJECT No. PC-0441 (PHASE I) / WC-0860

MacArthur
Associated Consultants
25 N.W. 146th Street - Edmond, OK 73013 - 405.848.2471
G.O.A. No. 699 Renewal Date: 05-30-17

12/19/16

KENNETH R. GILLESPIE, P.E. OKLA. REG. NO. 20104 DATE



OKLAHOMA DEPARTMENT OF TRANSPORTATION	DEPARTMENT OF TRANSPORTATION FEDERAL HIGHWAY ADMINISTRATION
DATE APPROVED _____	DATE APPROVED _____
BY _____ CHIEF ENGINEER	BY _____ DIVISION ADMINISTRATOR
PROJECT NO. 30326(04) SHEET NO. 1	