

X:\0dot\EC-1589B\Civil\Cross Sections.dgn
3/2/2017

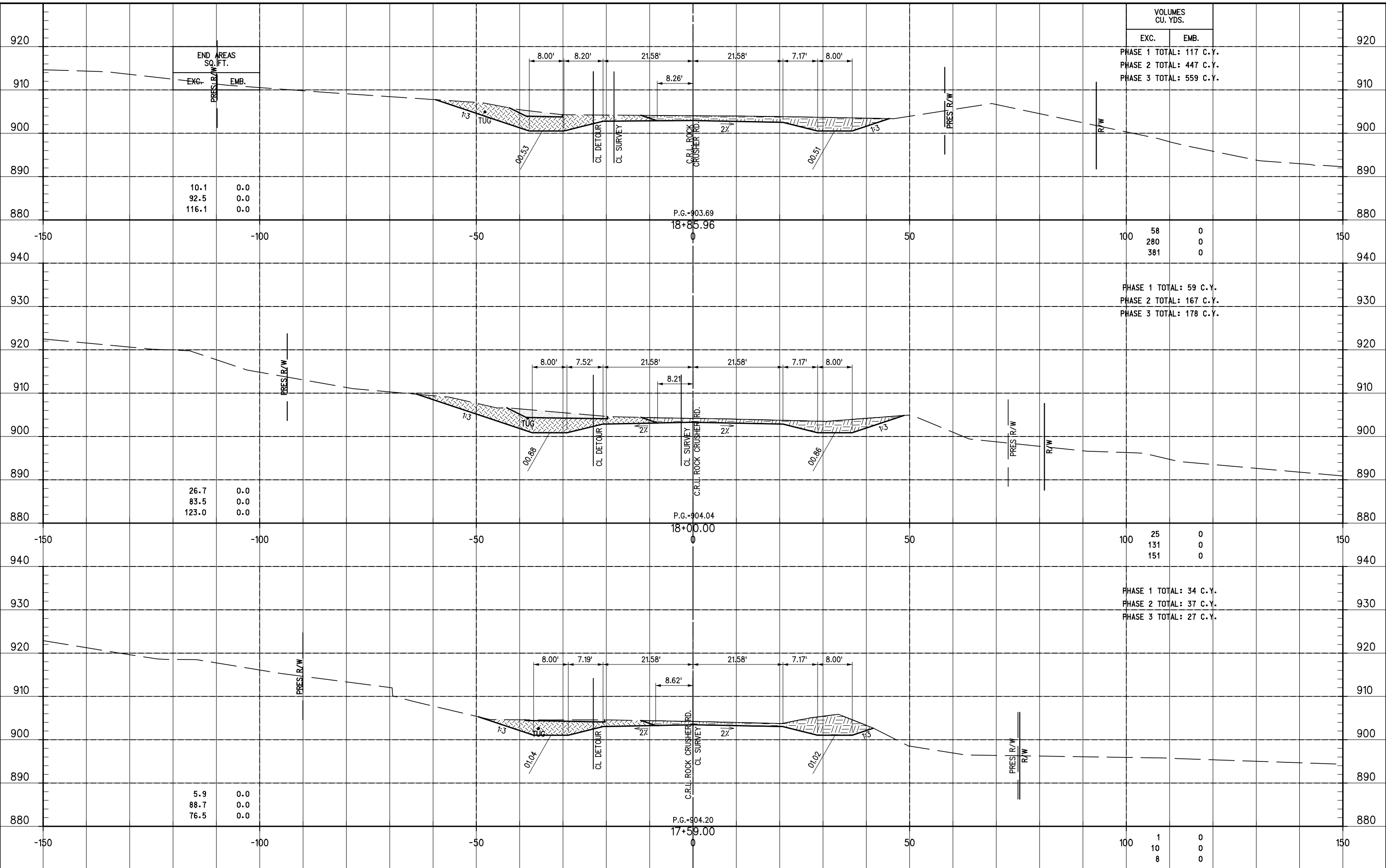

STA. 17+59.00 TO STA. 18+85.96

VOLUMES CU. YDS.	
EXC.	EMB.
100	58
280	0
381	0
PHASE 1 TOTAL: 117 C.Y.	
PHASE 2 TOTAL: 447 C.Y.	
PHASE 3 TOTAL: 559 C.Y.	
100	25
131	0
151	0
PHASE 1 TOTAL: 59 C.Y.	
PHASE 2 TOTAL: 167 C.Y.	
PHASE 3 TOTAL: 178 C.Y.	
100	1
10	0
8	0
PHASE 1 TOTAL: 34 C.Y.	
PHASE 2 TOTAL: 37 C.Y.	
PHASE 3 TOTAL: 27 C.Y.	

SCALE: 1"=10' VERT. & HORIZ.