

REV. NO.	DESCRIPTION	REVISIONS	DATE

PHASE 3 CONSTRUCTION ACTIVITIES:

1. TRAFFIC IS SHIFTED FROM DETOUR AND EXISTING PAVEMENT ONTO NEW PAVEMENT.
 2. REMOVE DETOUR 1 AND CONSTRUCT FULL DEPTH RECONSTRUCTION, GRADING, AND DRAINAGE FROM STA 17+55.99 TO STA 19+66.88.
 3. REMOVE DETOUR 2 AND CONSTRUCT DRIVEWAY, GRADING AND DRAINAGE ON NORTH SIDE OF ROAD. MILL AND OVERLAY FROM STA 36+78.49 TO STA 40+33.90
 4. CONSTRUCT FULL DEPTH RECONSTRUCTION, GRADING AND DRAINAGE FOR PUBLIC ROAD #4.
 5. REMOVE OLD BRIDGE OVER I-35.
 6. INSTALL PERMANENT SIGNING AND STRIPING AS PER PLANS.
- ESTIMATED DURATION FOR PHASE 3: 30 DAYS

TRAFFIC CONTROL NOTES:

- A. ALL TRAFFIC CONTROL SIGNS AND DEVICES AND THEIR USE SHALL CONFORM TO ODOT TRAFFIC CONTROL STANDARDS AND PART 6 (WORK ZONES) OF THE MANUAL ON UNIFORM TRAFFIC CONTROL DEVICES (MUTCD).
- B. LANE AND SHOULDER SHIFTS OR CLOSURES ALONG ROCK CRUSHER RD REQUIRED TO PERFORM WORK DURING THIS PHASE SHALL CONFORM TO ODOT TRAFFIC CONTROL STANDARDS AND PART 6 (WORK ZONES) OF THE MUTCD.
- C. UTILIZE A TRAFFIC SHIFT AS NECESSARY TO REMOVE OLD BRIDGE OVER I-35. MAINTAIN 2 OPEN LANES OF TRAFFIC IN EACH DIRECTION AT ALL TIMES. THE USE OF A TRAFFIC SHIFT SHALL BE COORDINATED AND APPROVED BY ODOT AND OHP PRIOR TO IMPLEMENTATION.
- D. ACCESS SHALL BE MAINTAINED THROUGHOUT CONSTRUCTION FOR PUBLIC RD #4.

SUMMARY OF TRAFFIC CONTROL (THIS SHEET)		
ITEM		NO. REQ'D.
SIGN: W1-4(L)	(16.0 S.F.)	1
SIGN: R11-2	(10.0 S.F.)	2
SIGN: W1-8	(3.0 S.F.)	7
SIGN: W5-1	(16.0 S.F.)	1
TYPE III BARRICADES		2
DRUMS		20
TYPE A LIGHTS		6
FLEXTAB MARKERS		288
IMPACT ATTENUATOR		2
PORTABLE BARRIER (LF)		600



SCALE: 1" = 50'

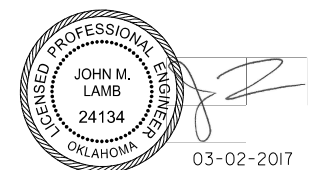
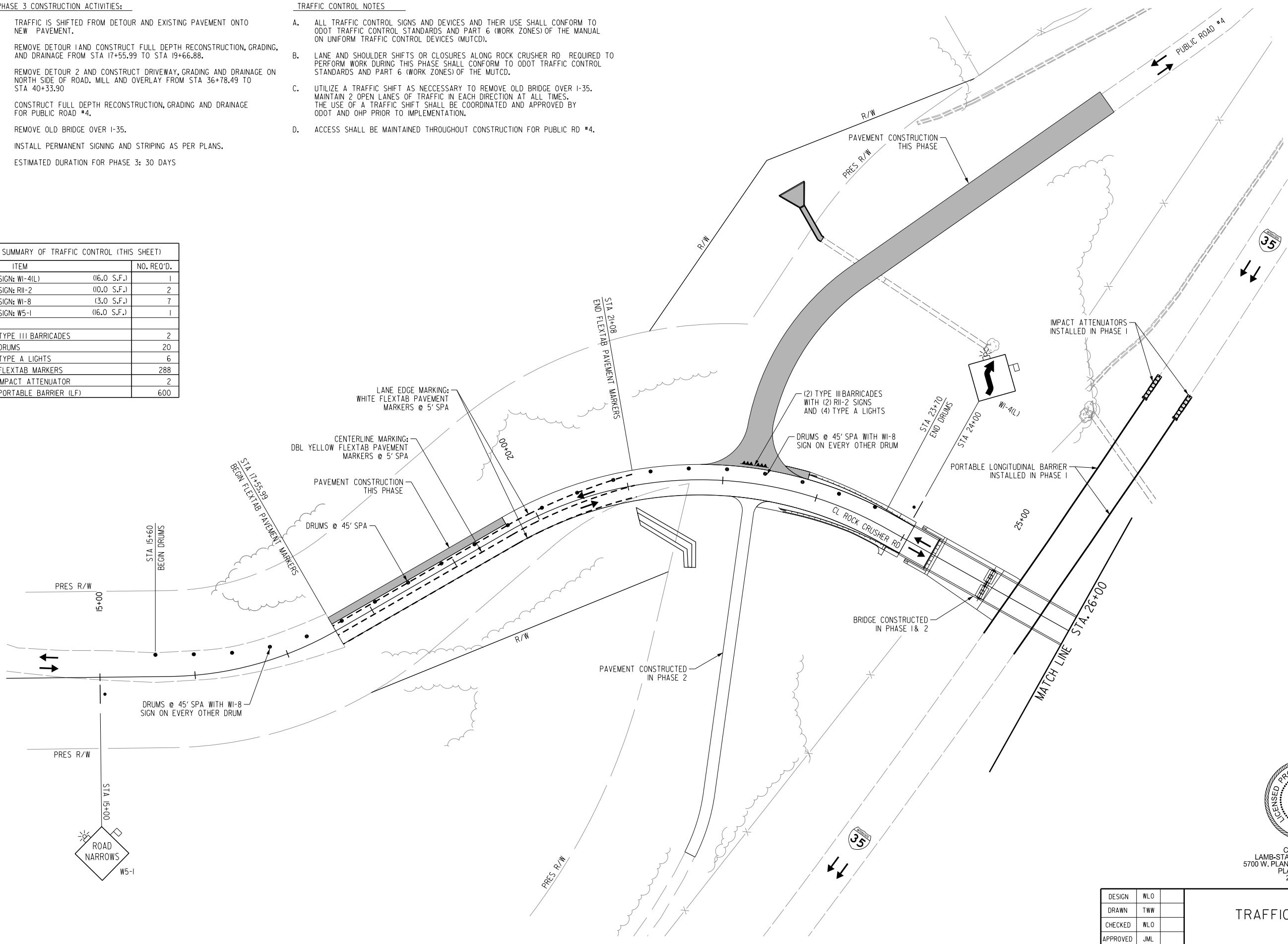

CA 5769 PE/LS
 LAMB-STAR ENGINEERING, L.P.
 5700 W. PLANO PARKWAY, SUITE 1000
 PLANO, TX 75093
 214-440-3600

PHASE 3

DESIGN	WLO
DRAWN	TWW
CHECKED	WLO
APPROVED	JML
SQUAD	LSE

JOB PIECE NO. 30363104 SHEET NO. 37

**TRAFFIC CONTROL PLAN
(1 OF 2)**

L:\Projects\2014\040059\00-GK-ODOT-EC1589B\135-Bridge\CAD\Sheets\EC1589B_TC05.dgn 3/1/2017