

REV. NO.	DESCRIPTION	DATE

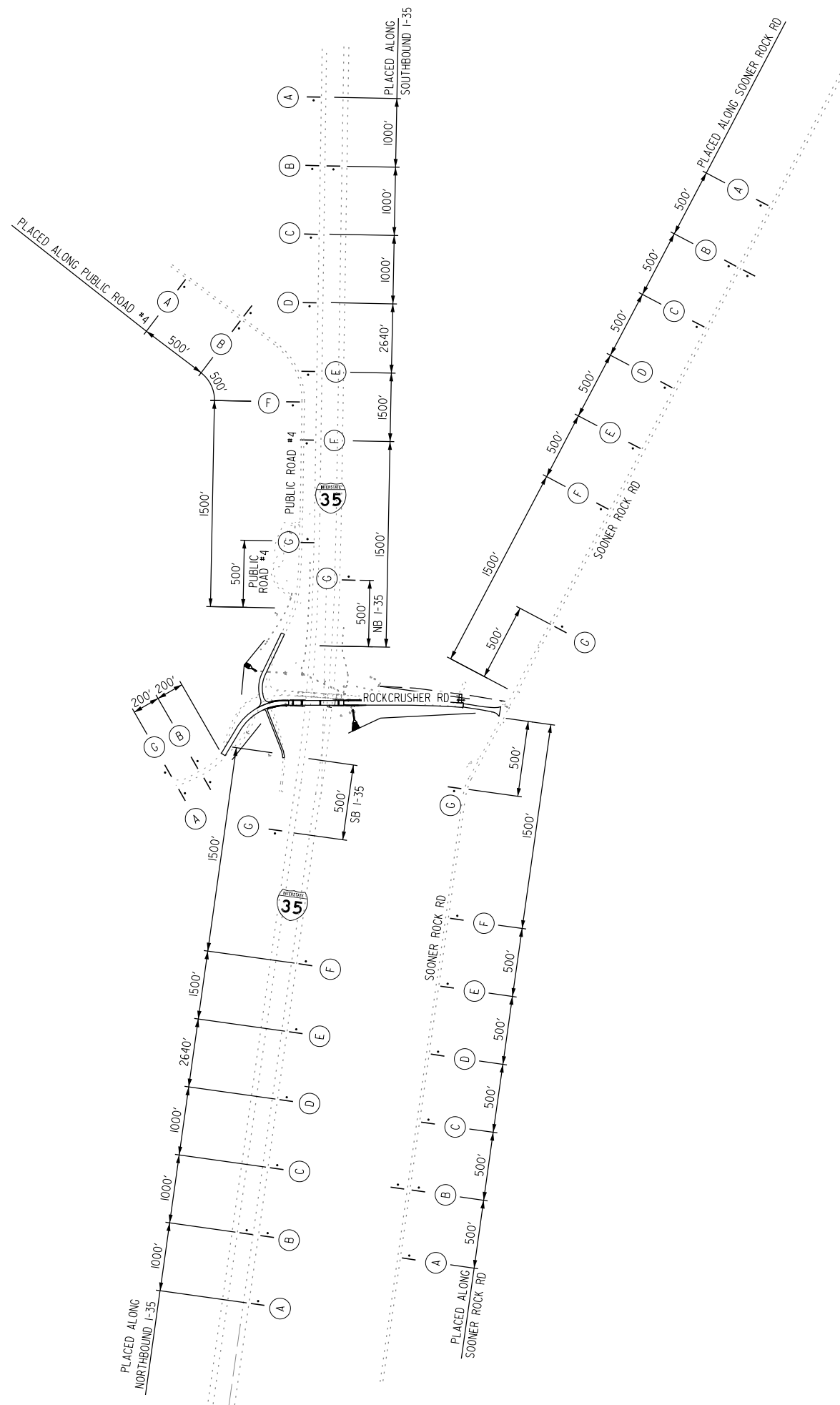

SCALE:
NTS



TRAFFIC CONTROL NOTES

- ALL TRAFFIC CONTROL SIGNS AND DEVICES AND THEIR USE SHALL CONFORM TO ODOT TRAFFIC CONTROL STANDARDS AND PART 6 (WORK ZONES) OF THE MANUAL ON UNIFORM TRAFFIC CONTROL DEVICES (MUTCD).
- THE HIGHWAY IS TO REMAIN OPEN TO TRAFFIC THROUGHOUT CONSTRUCTION.
- ADVANCE WARNING SIGNS SHALL REMAIN IN PLACE FOR ALL PHASES OF CONSTRUCTION.
- FOR SPECIAL SIGN DETAIL SEE SHEET NO. 6.
- ADVANCED WARNING SIGNS TO BE SPACED AT DIMENSIONS SHOWN. SEE ODOT STANDARD TC57-I-02 FOR ADDITIONAL INFORMATION.

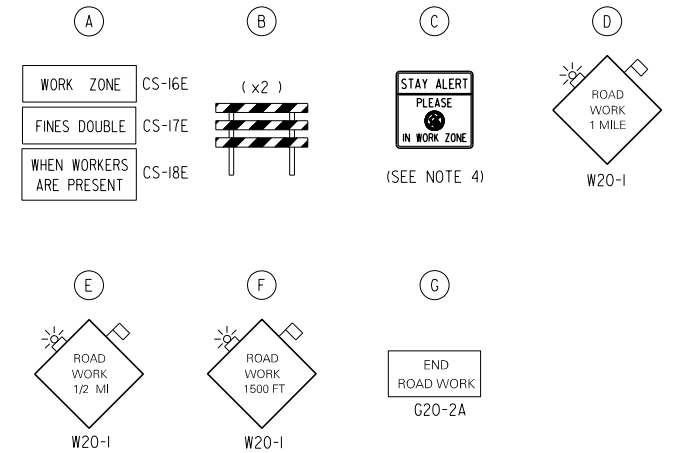

SUMMARY OF TRAFFIC CONTROL (THIS SHEET)		
ITEM		NO. REQ'D.
SIGN: W20-1	(16.0 S.F.)	13
SIGN: G20-2A	(4.5 S.F.)	6
SIGN: CS-16E	(6.0 S.F.)	6
SIGN: CS-17E	(6.0 S.F.)	6
SIGN: CS-18E	(8.0 S.F.)	6
SIGN: STAY ALERT	(16.0 S.F.)	4
WING BARRICADES		12
TYPE "A" LIGHTS		13

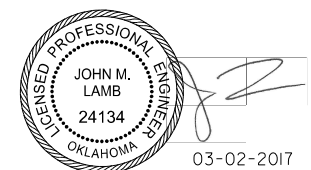

03-02-2017

CA 5769 PE/LS
LAMB-STAR ENGINEERING, L.P.
5700 W. PLANO PARKWAY, SUITE 1000
PLANO, TX 75093
214-440-3600

DESIGN	WLO
DRAWN	TWW
CHECKED	WLO
APPROVED	JML
SQUAD	LSE

**TRAFFIC CONTROL
ADVANCE WARNING SIGNS**