

UTILITIES

AT&T - Rod Cline, (405) 743-6180
 Cable One - Dennis Anderson, (918) 440-2957
 Kay Electric - Chad Shepherd, (580) 789-1088

SEC. 5 T26N R2E

OKLAHOMA DEPARTMENT OF TRANSPORTATION		
DESCRIPTION	REVISIONS	DATE

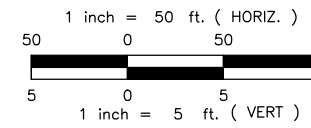
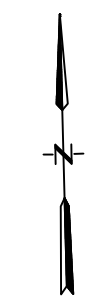

LEGEND

	PROPOSED ASPHALT PAVEMENT
	PROPOSED ASPHALT SHOULDER
	PROPOSED T.B.S.C.

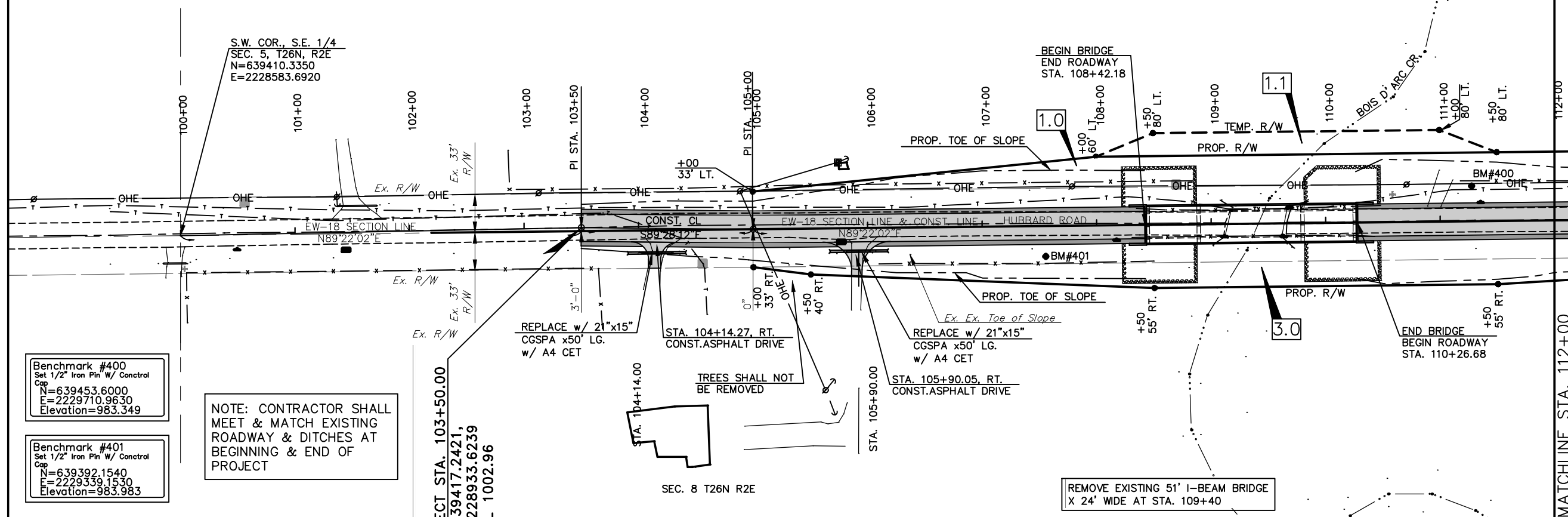

Benchmark #400
 Set 1/2" Iron Pin W/ Control Cap
 N=639453.6000
 E=2229710.9630
 Elevation=983.349

Benchmark #401
 Set 1/2" Iron Pin W/ Control Cap
 N=639392.1540
 E=2229339.1530
 Elevation=983.983

NOTE: CONTRACTOR SHALL MEET & MATCH EXISTING ROADWAY & DITCHES AT BEGINNING & END OF PROJECT

BEGIN PROJECT STA. 103+50.00
 N=639417.2421
 E=2228933.6239
 EL 1002.96

