

STATE OF OKLAHOMA
DEPARTMENT OF TRANSPORTATION

SURVEY OF
S.H.-10
SWO 5076(1)
J P NO.29068(04)

CRAIG COUNTY, OK
BRIDGE OVER BIG CABIN CREEK

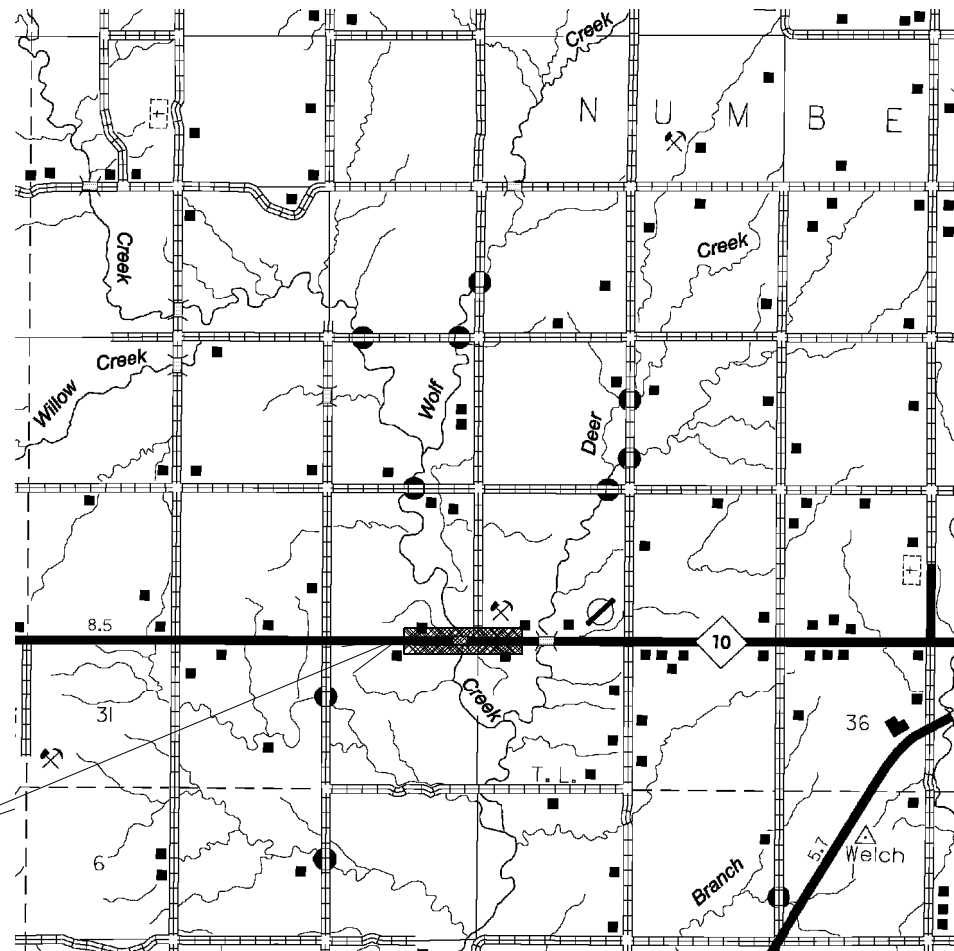

PROJECT LENGTH 4233.80 Ft. 0.80 Mi.
S.H. 10:
BEGINNING STATION : 1417+66.20
ENDING STATION : 1460+00.00



INDEX OF SURVEY SHEETS

1	TITLE SHEET & SURVEYORS CERTIFICATION
2-3	HISTORICAL LETTER & WRITTEN REPORT
4	BENCHMARK LIST & ALIGNMENT REPORT
5	COGO POINTS
6-7	SURVEY DATA SHEETS
8-11	GEOMETRIC DATA SHEETS

SURVEY BEGAN: MAY 1, 2014.
SURVEY COMPLETED: AUGUST 20, 2014.

K.A. ISAACS, PROFESSIONAL LAND SURVEYOR
R.D. LAMBILLOTTE, PROFESSIONAL LAND SURVEYOR
J.D. ISAACS, CAD TECHNICIAN
J.D. LAUGHTER, SURVEY CREW CHIEF
J.C. ARNETT, SURVEY CREW MEMBER

EQUIPMENT:

TRIMBLE R8 GNSS GPS RTK UNITS
TRIMBLE TSC3 DATA COLLECTORS
TRIMBLE S6 ROBOTIC TOTAL STATION
LEICA AUTOMATIC ELECTRONIC DIGITAL LEVEL
EAGLE POINT SOFTWARE IN MICROSTATION ENVIRONMENT

STATE OF OKLAHOMA
DEPARTMENT OF TRANSPORTATION

SWO 5076(1) Job/Piece 29068(04) Engr. Contract No.

LAND SURVEYOR'S CERTIFICATION

I hereby certify that all land and property sub-division distances, angles, corners, and monumentation made or used in conjunction with this survey and depicted or recorded herein or hereon were recovered, established or re-established in substantial conformity with:

- Applicable instructions contained in the U.S. Government Bureau of Land Management publication "Manual of Survey Instruction",
- Its supplement, "Restoration of Lost or Obliterated Corners and Sub-division of Sections";
- "Oklahoma Minimum Standards for the Practice of Land Surveying" as adopted by the State Board of Licensure for Professional Engineers and Land Surveyors; and
- Sound land surveying practices;

including a thorough search, study, analysis and consideration of all existing records and field evidence.

I further certify that all survey monuments depicted exist and that all land survey work was done by me or under my direct supervision.

Dated this 17th Day of November, 2014.

Land Surveyor *Kenny A. Isaacs*
Signature
Kenny A. Isaacs
Printed Name



Oklahoma Licensed Land Surveyor No. 1213

Certificate of Authorization No. CA 2252

PLS	KAI		OKLAHOMA DEPARTMENT OF TRANSPORTATION SURVEY DIVISION
DRAWN	JDI		
CHECKED	KAI		
APPROVED	KAI		
CREW	ISAACS		
SWO 5076 (1) PROJECT NO. 29068(04) SHEET NO. 21			

STATE OF OKLAHOMA
DEPARTMENT OF TRANSPORTATION
SURVEY DIVISION

SWO 5076(1) J/P 29068(04) ; Craig CO.

HORIZONTAL CONTROL:
 Oklahoma Coordinate System of 1927 Zone.
 Oklahoma Coordinate System of 1983 North Zone.
 Oklahoma Dept. of Transportation Plane Coordinate System of 1927 Zone.
 Oklahoma Dept. of Transportation Plane Coordinate System of 1983 Zone.
 Arbitrary Coordinate System

HORIZONTAL PLANE DATUM DEFINITION:
 Oklahoma Department of Transportation coordinates were derived by multiplying the Oklahoma Coordinate Systems of 1927 or 1983 by the combined adjustment factor of 1.00010. The ODOT Coordinate System is 2350 feet above sea level.

1. Primary Control adjusted to OK SPC NAD 83(1993) (B) Order
 Stations MOMO, MOCA, MOA2, HARVEY,
 A) Closure before adjustment X ; Y ; Angles ; 1:
 Trav. Length ; No. Angles ;
 B) ; is () Order before adjustment.
 C) Method of Distance Measurement:
 Electronic GPS Triangulation Chained
 D) Instrument used for angles

2. Secondary Control adjusted to Primary Control (B) Order
 Stations C-18-461, C-18-462
 A) Closure before adjustment X ; Y ; Angles ; 1:
 B) Secondary Control ; is (3rd) Order, tied to CORS
 C) Method of Distance Measurement:
 Electronic GPS Triangulation Chained
 D) Instrument used for angles Trimble GPS 5800

VERTICAL CONTROL IS (3rd) order. Level Line taken from C-18-461
 (3rd) order and tied to C-18-462 (3rd) order.
 NGVD 29 datum
 NAVD 88 datum

ACCURACY DEFINITION:
 (1) HORIZONTAL: (3rd Order = Class I = 1 : 10,000'
 (3rd Order = Class II = 1 : 5,000'
 (2) VERTICAL: (1st Order = 0.017 Ft. x sqrt. of Mi.) (2nd Order = 0.035 Ft. x sqrt. of Mi.)
 (3rd Order = 0.050 Ft. x sqrt. of Mi.)

Distribution:
Copy w/survey reports
Copy in each Alignment
and level book

K. A. Isaacs
Professional Land Surveyor

11/21/2014
Date

(FORM SD #20)
Rev. 11/03

Utility Companies	Phone Numbers
Electric Lines:	
Northeast Oklahoma Electric Cooperative	(918) 256-6405
Telephone Lines:	
Atlas Telephone Company	800-522-6543
Fiber Optic:	
Atlas Telephone Company	800-522-6543
Waterline:	
Craig County Rural Water Dist.	(918)-256-1145

PROJECT EXTENTS

Electronic File Transfer Disclaimer:

These Files, Drawings and/or Notes are provided for information only. The Oklahoma Department of Transportation (ODOT) and the Owner cannot be held responsible for the content or accuracy of these Files, Drawings and/or Notes due to conversions, software translations, or any other manipulation of said Files, Drawings and/or Notes. ODOT expressly disclaims any responsibility arising from any use of these Files, Drawings and/or Notes. To the full extent permitted by applicable law, the recipient of these Files, Drawings and/or Notes hereby agrees to defend, indemnify, and hold harmless ODOT and the Owner from and against any and all claims, suits, actions, damages, loss, liability or costs of every nature or description (including reasonable attorney's fees) arising from, or in any way attributable to or connected with any of these Files, Drawings and/or Notes.

THIS SURVEY MEETS THE OKLAHOMA MINIMUM STANDARDS FOR THE PRACTICE OF LAND SURVEYING AS ADOPTED BY THE OKLAHOMA STATE BOARD OF REGISTRATION FOR PROFESSIONAL ENGINEERS AND LAND SURVEYORS, MAY 17, 2010.

SPECIFICATIONS FOR SURVEYS FOR PRIMARY AND SECONDARY HIGHWAYS DATED MAY 1, 1999 GOVERN.

SDS I OF II