

**LEGEND - SYMBOLS**

- EXISTING POLE AND BASE
- PROPOSED POLE AND BASE
- TRAFFIC PULLBOX
- SIGNAL CABINET
- FIRE HYDRANT
- UTILITY POLE
- SIGNAL HEAD (TYPE INDICATED)
- CONDUIT WITH CONDUCTOR
- LUMINAIRE
- SIGN

**NOTE ON POLE LOCATION:**

DESIGNATION SHOWN FOR EACH POLE IS THE OFFSET FROM CURBLINE TO CENTER OF POLE:  
 -1ST NUMBER IS OFFSET FROM EAST-WEST CURBLINE  
 -2ND NUMBER IS OFFSET FROM NORTH-SOUTH CURBLINE

**LEGEND - ITEMS OF WORK**

- (A) REMOVE POLE AND BASE
- (B) INSTALL POLE AND BASE
- (C) INSTALL CONDUIT AND CONDUCTOR (2"/20-C, UNLESS NOTED OTHERWISE)
- (D) REPLACE OR INSTALL PULLBOX (TYPE 2, UNLESS NOTED OTHERWISE)
- (E) REMOVE AND REPLACE SIDEWALK

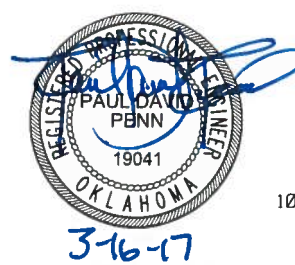
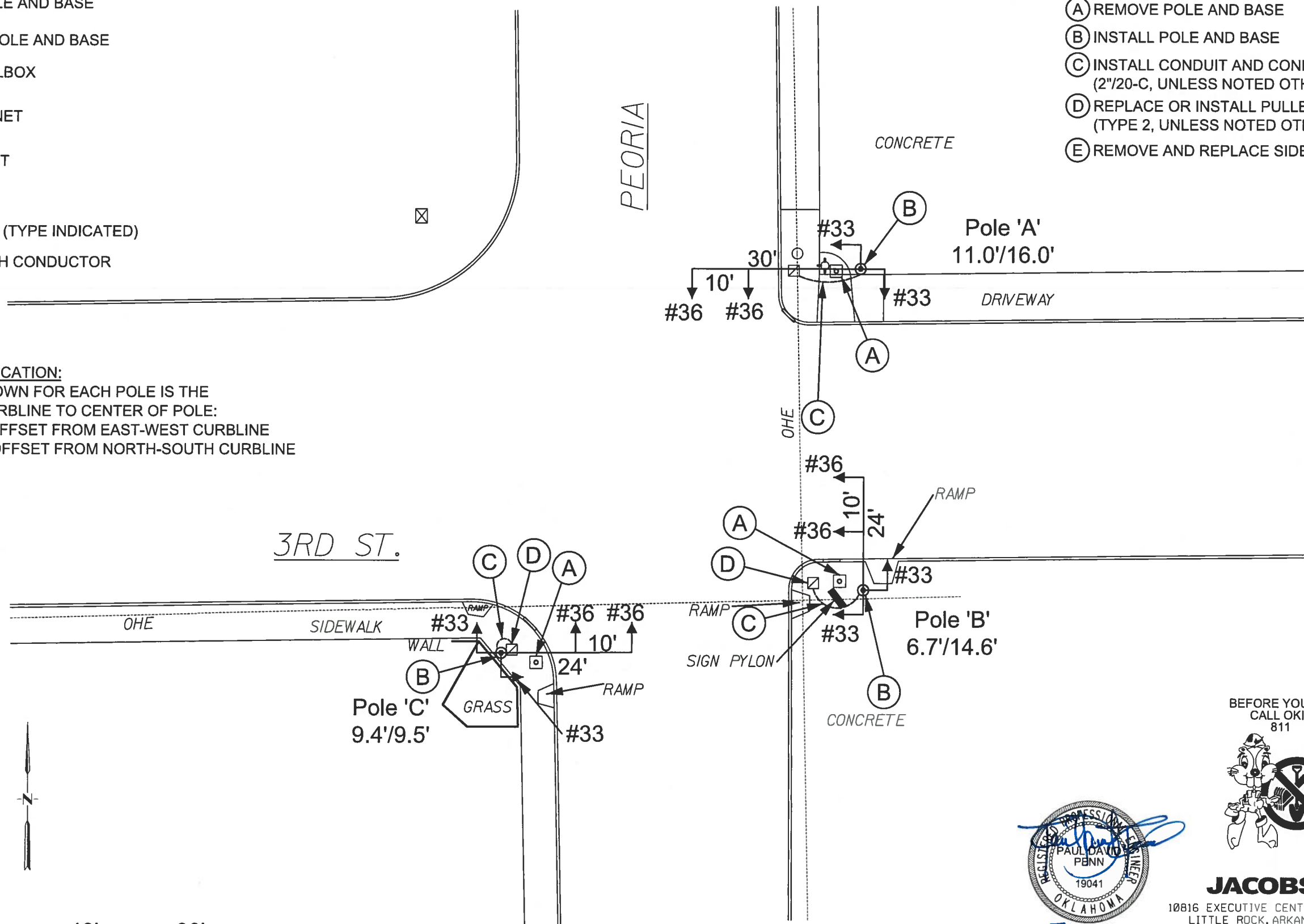

**JACOBS**  
 10816 EXECUTIVE CENTER DR. STE. 300  
 LITTLE ROCK, ARKANSAS 72211

DESIGN	BLV	OKLAHOMA DEPARTMENT OF TRANSPORTATION DESIGN DIVISION TULSA TRAFFIC SIGNAL LED UPGRADE PROJECT (3rd ST. & PEORIA AVE.) 50 REPLACEMENT PLAN PROJECT NO. 23708(06) SHEET NO. 35
DRAWN	JAB	
CHECKED	BLV	
APPROVED	BLV	
SQUAD	Jacobs	