

**LEGEND - SYMBOLS**

- EXISTING POLE AND BASE
- PROPOSED POLE AND BASE
- TRAFFIC PULLBOX
- SIGNAL CABINET
- FIRE HYDRANT
- UTILITY POLE
- SIGNAL HEAD (TYPE INDICATED)
- CONDUIT WITH CONDUCTOR
- LUMINAIRE

**LEGEND - ITEMS OF WORK**

- (A) REMOVE POLE AND BASE
- (B) INSTALL POLE AND BASE
- (C) INSTALL CONDUIT AND CONDUCTOR (2"/20-C, UNLESS NOTED OTHERWISE)
- (D) REPLACE OR INSTALL PULLBOX (TYPE 2, UNLESS NOTED OTHERWISE)
- (E) REMOVE AND REPLACE SIDEWALK
- (F) RESEST HOSPITAL SIGNS

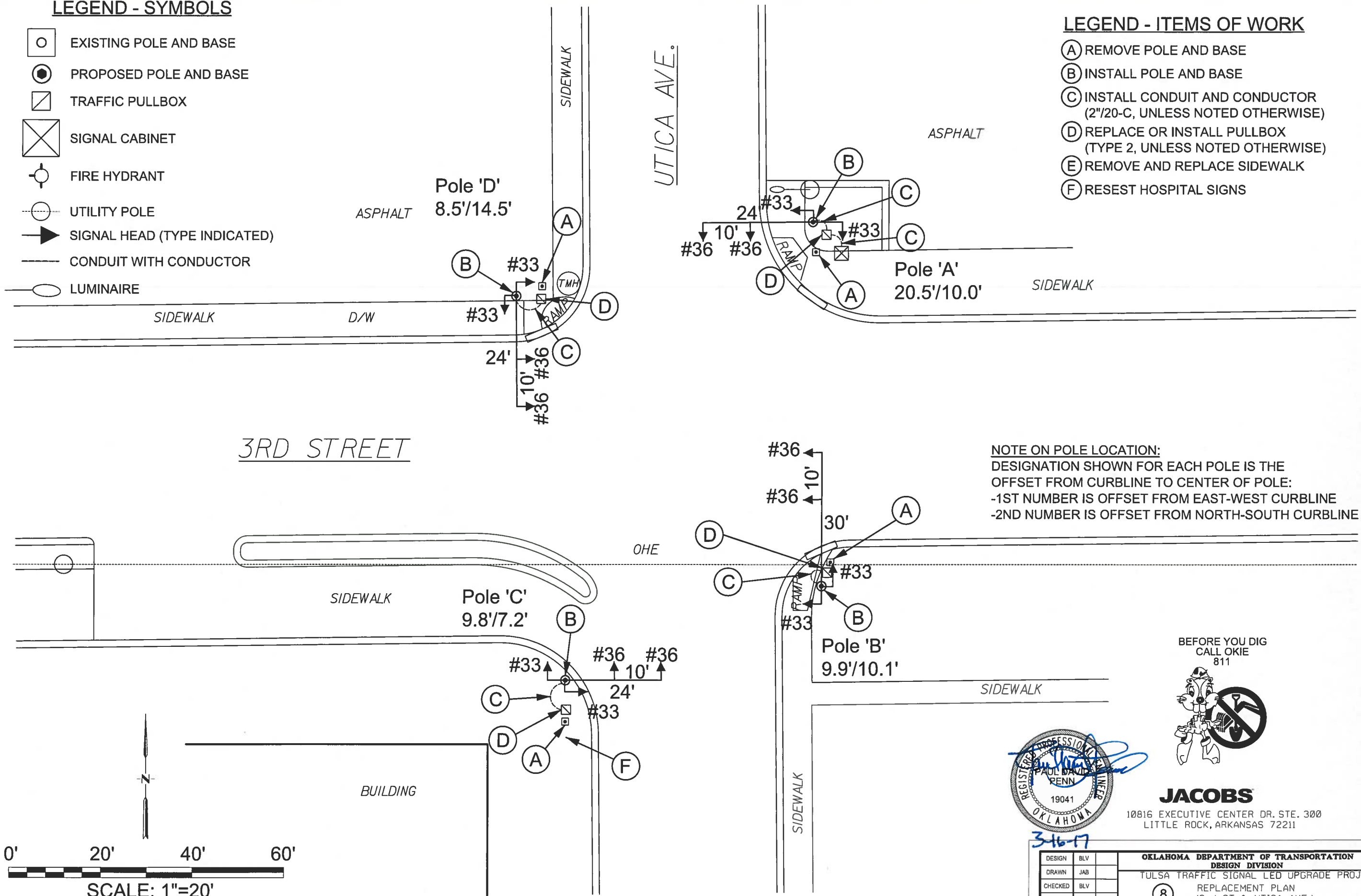

**NOTE ON POLE LOCATION:**  
 DESIGNATION SHOWN FOR EACH POLE IS THE OFFSET FROM CURBLINE TO CENTER OF POLE:  
 -1ST NUMBER IS OFFSET FROM EAST-WEST CURBLINE  
 -2ND NUMBER IS OFFSET FROM NORTH-SOUTH CURBLINE

BEFORE YOU DIG  
 CALL OKIE  
 811

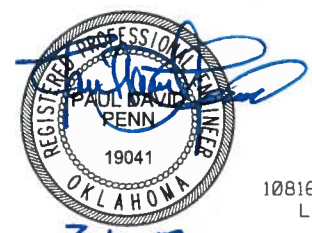

**JACOBS**  
 10816 EXECUTIVE CENTER DR. STE. 300  
 LITTLE ROCK, ARKANSAS 72211

PRINT DATE: 3/15/2017 BRILELS



DESIGN	BLV		<b>OKLAHOMA DEPARTMENT OF TRANSPORTATION</b> <b>DESIGN DIVISION</b> TULSA TRAFFIC SIGNAL LED UPGRADE PROJECT REPLACEMENT PLAN (3-rd ST. & UTICA AVE.) PROJECT NO. 23708(06) SHEET NO. 14
DRAWN	JAB		
CHECKED	BLV		
APPROVED	BLV		
SQUAD	Jacobs		