

Sub.: June 9, 2016

RANDY MC MURPHY - COUNTY COMMISSIONER
DISTRICT NO. 2

DESIGN DATA

ADT 2015= 25
ADT 2035= 50
DESIGN SPEED=55 M.P.H.
TERRAIN-ROLLING

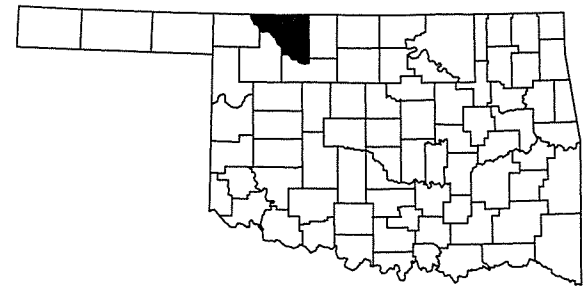

STATE OF OKLAHOMA
DEPARTMENT OF TRANSPORTATION
**PLAN OF PROPOSED
COUNTY BRIDGE**
FEDERAL AID PROJECT NO. ACSTP-276D(020)CI
BRIDGE AND APPROACH PLANS
WOODS COUNTY
(OLD NBI NO. 04935)(NEW NBI NO. 31600)
LOCATION NO. 76N2410E0170001
LITTLE EAGLE CHIEF CREEK
STATE JOB NO. 28347(04)
LAT. 36°46'03"N LONG. 98°43'12"W

SURVEY DATA

- HORIZONTAL CONTROL
 - HORIZONTAL CONTROL FOR THIS SURVEY IS THE ESTABLISHED SECTION CORNERS ALONG THE CONSTRUCTION REFERENCE LINE & SECTION LINE
- VERTICAL CONTROL
 - LEVEL DATUM IS MEAN SEA LEVEL (U.S.C. & G.S.)

| INDEX OF SHEETS | |
|-----------------|---|
| SHEET NO. | DESCRIPTION |
| 1 | TITLE |
| 2 | TYPICAL SECTION & SUMMARY OF PAY QUANTITIES & GENERAL NOTES (ROADWAY) |
| 3 | SUMMARY OF PAY QUANTITIES & GENERAL NOTES (BRIDGE) |
| 4 | STORMWATER MANAGEMENT PLAN |
| 5 | EROSION CONTROL PLAN |
| 6 | ALIGNMENT, SURVEY REFERENCE & R/W |
| 7 | PLAN AND PROFILE |
| 8 | GENERAL PLAN & ELEVATION |
| 9 | STAKING LAYOUT, ANCHOR BOLT & PEDESTAL LAYOUT |
| 10-14 | CROSS SECTIONS |
| 15-16 | BORING LOG |
| 17 | COUNTY ROAD CLOSURE |

THE FOLLOWING STANDARDS SHALL BE USED:

| 2009 STANDARDS | | | |
|----------------|-----------|-------------|------------|
| ROADWAY | TRAFFIC | MAINTENANCE | |
| CET4S-3-2 | DU1-1-00 | TCS2-1-00 | GRAU1-1-00 |
| FHTMPP-1-0 | DU2-1-00 | TCS4-1-01 | GRH1-1-00 |
| SPB-1-4 | TCS1-1-01 | TCS5-1-00 | GRH2-1-00 |
| RDI-3-1 | | TCS6-1-02 | GRH3-1-00 |
| SSS-1-1 | | TCS7-1-02 | |
| TSD-2-0 | | TCS8-1-00 | |
| TSC2-3-2 | | TCS9-1-01 | |
| SPI-4-1 | | | |

| BRIDGE | | |
|------------------------------------|------------------------------------|--------------------------------|
| CB26..32-C-SK0-ABUT-PC4-02E | CB26..32-C.I-SK0..30-GRAU-BC-00E | CB26-C-SK0-SPR-QUAN-PCB-1-01E |
| CB26..32-C-SK0-ABUT-MISC-01E | CB26-C-SK0-XSECT-PC234-01E | CB26-C-SK0..30-DIA-INT-PCB-01E |
| CB26-C-SK0-DKSLB-BLUST-01E | CB26-C-SK0-DIA-END-PC234-01E | CB26-C-SK0..30-BRG-PC4-01E |
| CB26-C-SK0..30-PCB-IV-100-01E | CB26..32-C.I-SK0..30-PCB-DTL-2-01E | HP1-2-00E |
| CB26..32-C.I-SK0..30-PCB-DTL-1-01E | CB26-C-SK0-LSECT-PCB-01E | TR3-2-01E |
| CB26..32-C-SK0-WING-PC4-01E | | |

TYLER D. SCHRODER, P.E. 25837
CIRCUIT ENGINEERING DISTRICT 8
2901 N. VAN BUREN
ENID, OK. 73703

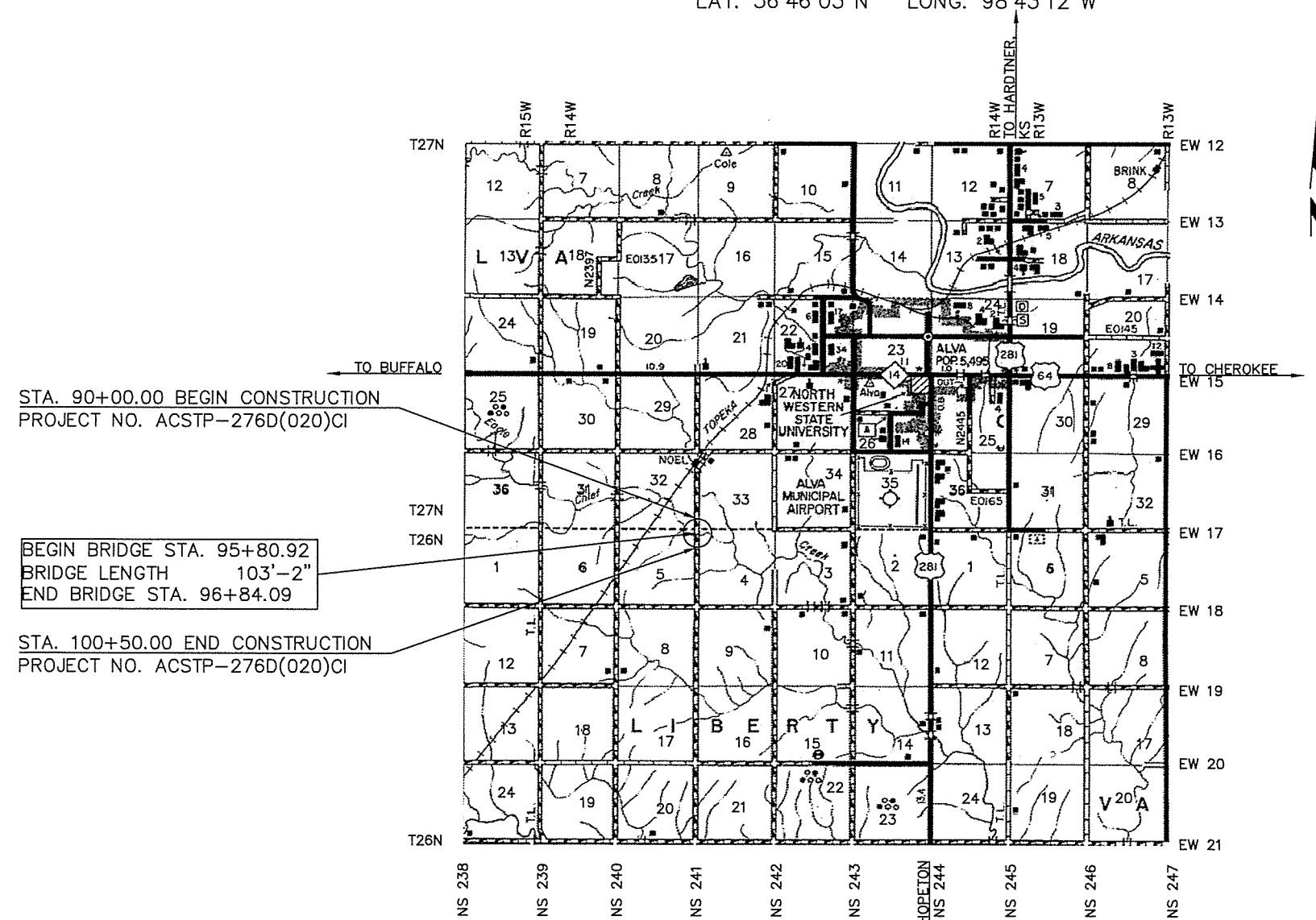

STA. 90+00.00 BEGIN CONSTRUCTION
PROJECT NO. ACSTP-276D(020)CI

BEGIN BRIDGE STA. 95+80.92
BRIDGE LENGTH 103'-2"
END BRIDGE STA. 96+84.09

STA. 100+50.00 END CONSTRUCTION
PROJECT NO. ACSTP-276D(020)CI

PROJECT LENGTHS BASED ON CRL

SCALES

| | |
|--------------|-----------|
| PLAN | 1"=50' |
| PROFILE HOR. | 1"=50' |
| VER. | 1"=5' |
| LAYOUT MAP | 1"=5,280' |

CONVENTIONAL SIGNS

- PROPOSED ROAD
- RAILROADS
- RANGE & TOWNSHIP SECTION LINES
- QUARTER SECTION LINES
- FENCES
- GROUND LINE
- EXISTING ROADS
- BASE LINE
- GRADE LINES
- TELEPHONE & TELEGRAPH
- POWER LINES
- OIL WELLS
- BUILDINGS
- DRAINAGE STRUCTURES-IN PLACE
- DRAINAGE STRUCTURES-NEW
- RIGHT-OF-WAY LINES-EXISTING
- RIGHT-OF-WAY LINES-NEW
- RIGHT-OF-WAY MARKERS-IN PLACE
- RIGHT-OF-WAY MARKERS-REMOVE & RESET
- RIGHT-OF-WAY MARKERS-NEW
- CONTROLLED ACCESS
- RIGHT-OF-WAY FENCE

| | | |
|----------------|--------------|-----------|
| ROADWAY LENGTH | 946.83 FT. | 0.179 MI. |
| BRIDGE LENGTH | 103.17 FT. | 0.020 MI. |
| PROJECT LENGTH | 1,050.00 FT. | 0.199 MI. |
| EXCETIONS | NONE | |
| EQUATIONS | NONE | |

| | |
|---------------|------------------------------|
| DATE | 3-7-16 |
| COMM. DIST. 1 | [Signature] |
| COMM. DIST. 2 | Randy McMurphy |
| COMM. DIST. 3 | [Signature] |
| ATTEST | Shelley Reed COUNTY CLERK |



TYLER D. SCHRODER
REGISTERED PROFESSIONAL ENGINEER NO. 25837
28347(04)

CIRCUIT ENGINEERING DIST. 8

2901 N. VAN BUREN
ENID, OK 73703
(580) 237-4810

| | |
|---|--|
| OKLAHOMA DEPARTMENT OF TRANSPORTATION DATE APPROVED _____ BY _____ CHIEF ENGINEER | DEPARTMENT OF TRANSPORTATION FEDERAL HIGHWAY ADMINISTRATION DATE APPROVED _____ BY _____ DIVISION ADMINISTRATION |
|---|--|

SWO. F.A. Project No. ACSTP-276D(020)CI Sheet No. 1

"2009 OKLAHOMA STANDARD SPECIFICATIONS FOR HIGHWAY CONSTRUCTION-ENGLISH GOVERN, APPROVED BY THE U.S. DEPARTMENT OF TRANSPORTATION, FEDERAL HIGHWAY ADMINISTRATION, JANUARY 4, 2010."

WILFORD LEVINGS
LOCAL GOVERNMENT COORDINATION DIVISION
P.E. NO. 28347(01)