

TOP REINFORCING MAT DETAILS

BOTTOM REINFORCING MAT DETAILS

BOTH APPROACH SLABS

- ② SAWED AND SEALED CONSTRUCTION JOINT (SEE "GENERAL PLAN AND TYPICAL CROSS SECTION" BRIDGE "A" FOR DETAIL)
- ③ SAWED AND SEALED LONGITUDINAL JOINT (SEE STD. LECS-4)

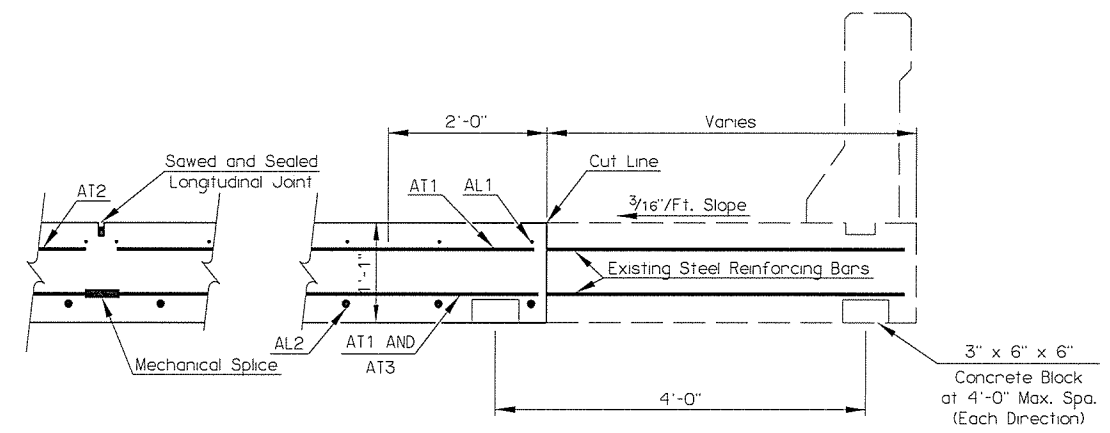

SECTION OF APPROACH SLAB

BAR LIST - APPROACH SLABS (PHASE 1)					
MARK	NO.	SIZE	FORM	LENGTH	VARIANCE
EPOXY COATED					
AT2	136	#4	STR.	19'-8"	_____
AT3	62	#4	STR.	39'-10"	_____
AL1	84	#4	STR.	29'-10"	_____
AL2	122	#9	STR.	29'-10"	_____

BAR LIST - APPROACH SLABS (PHASE 2)					
MARK	NO.	SIZE	FORM	LENGTH	VARIANCE
EPOXY COATED					
AT1	62	#4	STR.	21'-0"	_____
AL1	44	#4	STR.	29'-10"	_____
AL2	64	#9	STR.	29'-10"	_____

QUANTITIES - APPROACH SLABS (ONE SHOWN, TWO REQUIRED)		
ITEM	UNIT	TOTAL
① Approach Slab	S.Y.	408.90
Saw-Cut Grooving	S.Y.	367.00
Mechanical Splices	S.Y.	310.00
Deck Area Sealed (Floodcoat)	S.Y.	434.00

- ① The Department considers the cost of Concrete, Reinforcing Steel, Backer Rod, Rapid Cure Joint Sealant, Polystyrene, and Polyethylene Sheeting to be included in the contract unit price of APPROACH SLAB. There is an estimated 442.95 C.Y. of Class AA Concrete and an estimated 11,124 LB. of Epoxy Coated Reinforcing Steel in each Approach Slab.

US-169 OVER 31ST BRIDGE "A"	TULSA COUNTY	Design	N/A	N/A
		Detail	RLA	6/16
		Check	KMS	6/16
		Squad:	MAYFIELD	
		Engr.:	ELYAZGI	
STATE OF OKLAHOMA	DEPARTMENT OF TRANSPORTATION	JOB PIECE NO.	32565(05)	SHEET NO. B002