

REV. NO.	DESCRIPTION	REVISIONS	DATE

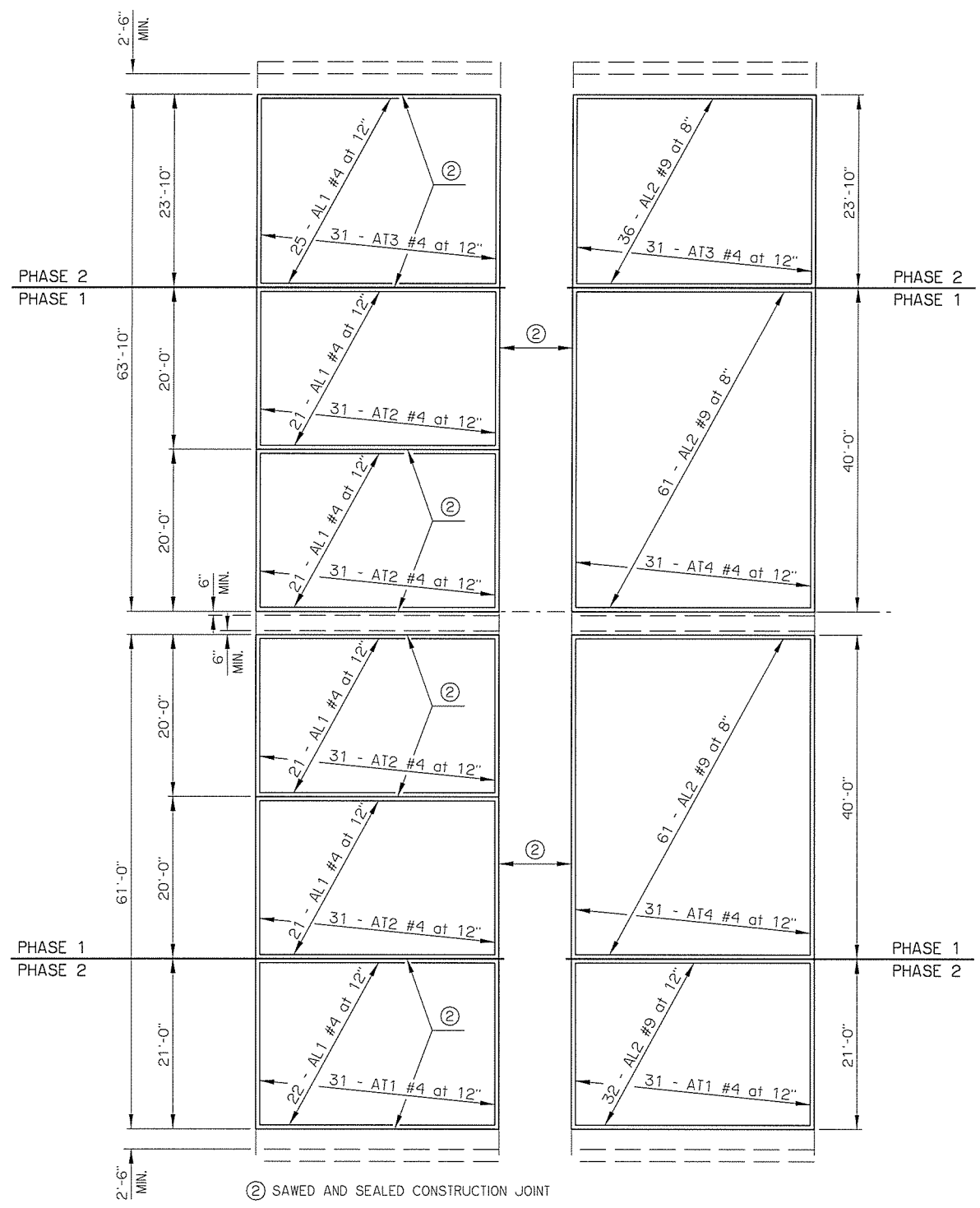

② SAWED AND SEALED CONSTRUCTION JOINT

TOP REINFORCING
MAT DETAIL

BOTTOM REINFORCING
MAT DETAIL

BOTH APPROACH SLABS

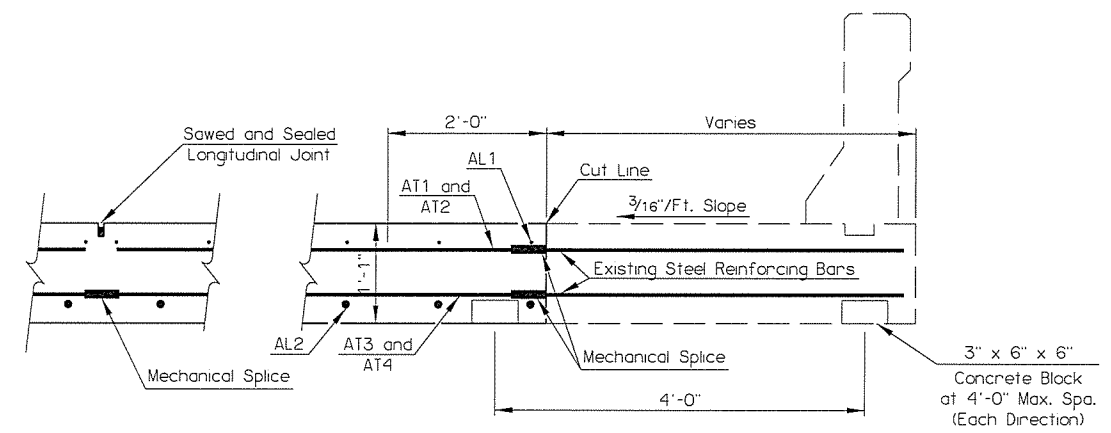

SECTION OF APPROACH SLAB

BAR LIST - APPROACH SLABS (PHASE 1)					
MARK	NO.	SIZE	FORM	LENGTH	VARIANCE
EPOXY COATED					
AT2	124	#4	STR.	19'-8"	_____
AT4	62	#4	STR.	39'-8"	_____
AL1	84	#4	STR.	29'-10"	_____
AL2	122	#9	STR.	29'-10"	_____

BAR LIST - APPROACH SLABS (PHASE 2)					
MARK	NO.	SIZE	FORM	LENGTH	VARIANCE
EPOXY COATED					
AT1	62	#4	STR.	20'-8"	_____
AT3	62	#4	STR.	23'-6"	_____
AL2	68	#9	STR.	29'-10"	_____

QUANTITIES - APPROACH SLABS (ONE SHOWN, TWO REQUIRED)		
ITEM	UNIT	TOTAL
① Approach Slabs	S.Y.	416.20
Saw-Cut Grooving	S.Y.	374.00
Mechanical Splices	EA.	310.00
Deck Area Sealed (Floodcoat)	S.Y.	450.00

① The Department considers the cost of Concrete, Reinforcing Steel, Backer Rod, Rapid Cure Joint Sealant, Polystyrene, and Polyethylene Sheeting to be included in the contract unit price of APPROACH SLAB.
There is an estimated 450.20 C.Y. of Class AA Concrete and an estimated 11,062 LB. of Epoxy Coated Reinforcing Steel in each Approach Slab.

US-169 OVER 41ST ST BRIDGE "C"		TULSA COUNTY	Design	N/A	N/A
			Detail	RLA	6/15
			Check	KMS	6/16
			Squad:	MAYFIELD	
			Engr.	ELYAZGI	
STATE OF OKLAHOMA		DEPARTMENT OF TRANSPORTATION			
JOB PECE NO. 31672(04)		SHEET NO. B006			