

DESCRIPTION	REVISIONS	DATE

STATE OF OKLAHOMA  
DEPARTMENT OF TRANSPORTATION

PLAN OF PROPOSED  
**STATE HIGHWAY**  
FEDERAL AID PROJECT NO. NHPP-272A(126)3B  
STATE JOB NO. 31672(04)  
**TULSA COUNTY**  
JOINT SEAL AND REPAIR  
(PREVENTIVE MAINTENANCE)  
DIVISION EIGHT

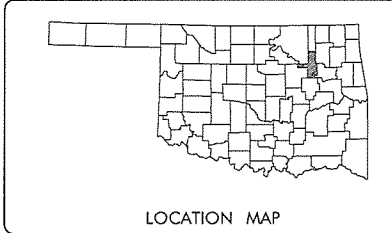

LOCATION MAP

TRAFFIC DESIGN

PROJECT ENGINEER : JAMI SHORT  
SQUAD SUPERVISOR : STEVE WILLIAMS

BRIDGE DESIGN

ENGINEERING MANAGER: MOHAMED ELYAZGI, PE SQUAD SUPERVISOR: KEVEN MAYFIELD  
ENGINEER: MIKE CAO, PE ENGINEER: KATIE BROWN, PE ENGINEER INTERN: --  
SQUAD MEMBERS: D.GOFORTH, J.LONSDALE, R.WEINERT, R. ADKINSON, A. GATLEY

MANDATORY TIE:  
THIS PROJECT SHALL BE MANDATORILY TIED  
WITH TULSA COUNTY JOB PIECE 32565(05)  
AND SHALL BE BID ACCORDINGLY

INDEX OF SHEETS

NO.	TITLE
0001	TITLE SHEET
AB01	GENERAL NOTES AND SUMMARY OF PAY QUANTITIES (BRIDGE) (SHEET 1 OF 2)
AB02	GENERAL NOTES AND SUMMARY OF PAY QUANTITIES (BRIDGE) (SHEET 2 OF 2)
ARR1	SUMMARY OF PAY QUANTITIES AND NOTES (RAILROAD)
AT01	SUMMARY OF PAY QUANTITIES AND NOTES (TRAFFIC CONTROL)
B001	GENERAL PLAN AND TYPICAL CROSS SECTIONS - (BRIDGE "A")
B002	DETAILS OF APPROACHES - (BRIDGE "A")
B003	GENERAL PLAN AND TYPICAL CROSS SECTIONS - (BRIDGE "B")
B004	DETAILS OF APPROACHES - (BRIDGE "B")
B005	GENERAL PLAN AND TYPICAL CROSS SECTIONS - (BRIDGE "C")
B006	DETAILS OF APPROACHES - (BRIDGE "C")
T001	TRAFFIC CONTROL DETAIL BRIDGES "A" AND "B" US-169 OVER 51ST ST AND RR OUTSIDE LANES AND SHOULDER
T002	TRAFFIC CONTROL DETAIL BRIDGES "A" AND "B" US-169 OVER 51ST ST AND RR INSIDE LANES AND SHOULDER
T003	TRAFFIC CONTROL DETAIL BRIDGE "C" US-169 OVER 41ST ST NORTHBOUND OUTSIDE LANES AND SHOULDER
T004	TRAFFIC CONTROL DETAIL BRIDGE "C" US-169 OVER 41ST ST NORTHBOUND INSIDE LANES AND SHOULDER
T005	TRAFFIC CONTROL DETAIL BRIDGE "C" US-169 OVER 41ST ST SOUTHBOUND OUTSIDE LANES AND SHOULDER
T006	TRAFFIC CONTROL DETAIL BRIDGE "C" US-169 OVER 41ST ST SOUTHBOUND INSIDE LANES AND SHOULDER

STANDARD DRAWINGS

TRAFFIC	ROADWAY
TCS1-1-01	TCS7-1-02
TCS2-1-00	TCS8-1-00
TCS3-1-01	TCS9-1-01
TCS4-1-01	TCS10-1-00
TCS5-1-00	TCS11-1-01
TCS6-1-02	TCS14-1-00
TCS15-1-00	PCPR-3-1
TCS18-1-01	
TCS19-1-01	
TCS20-1-00	
TCS24-1-02	
TCS25-1-00	

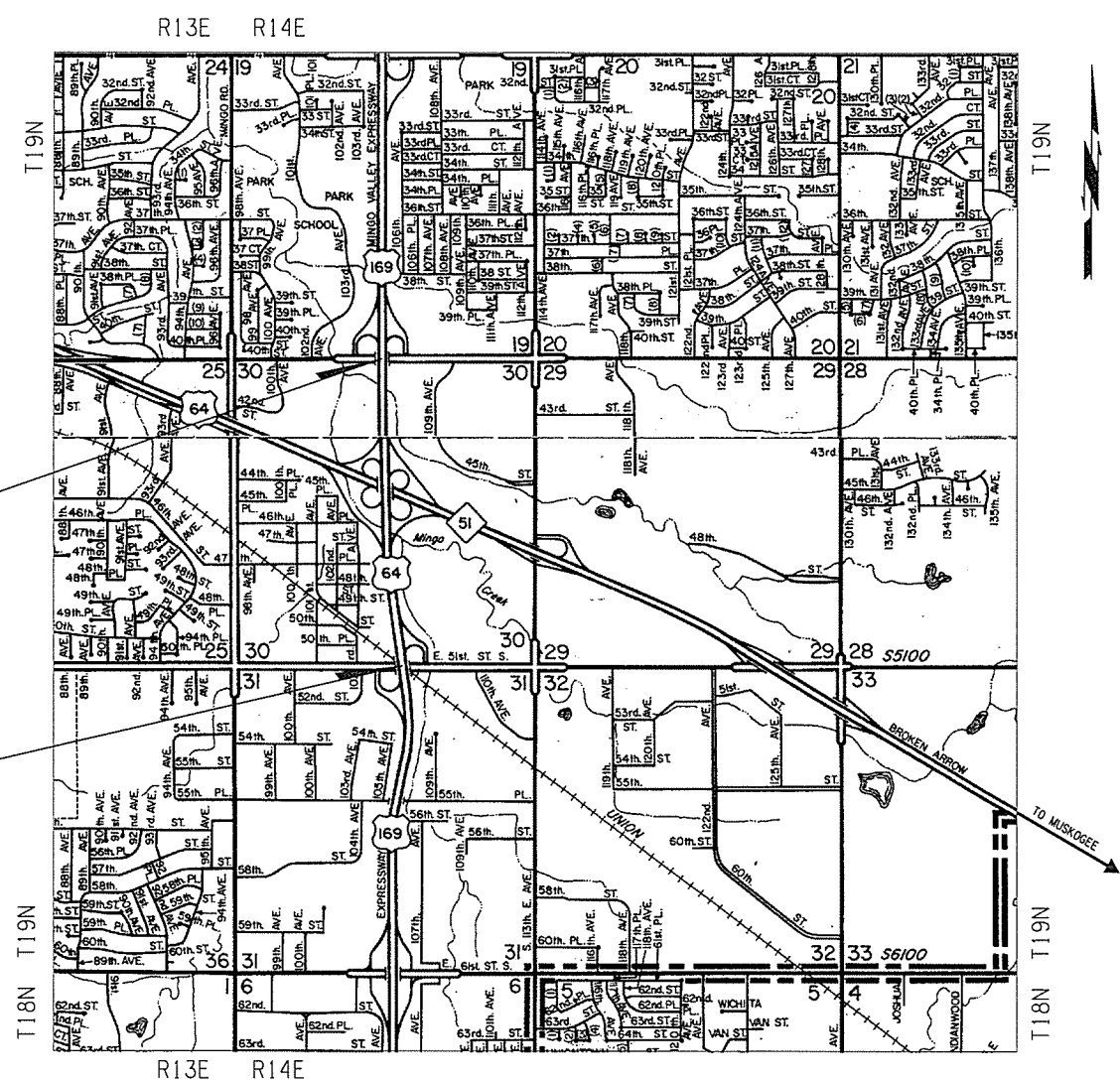

BRIDGE "C" - LOCATION NO. 7283-0667 X  
CONTROL SECTION NO. 169-72-83  
NBI NO. 19240  
FACILITY CARRIED: U.S. 169  
FEATURE INTERSECTED: 41ST STREET  
TOWNSHIP: T19N SECTION: 30 RANGE: R14E

BRIDGE "B" - LOCATION NO. 7283-0565 WX  
CONTROL SECTION NO. 169-72-83  
NBI NO. 19264  
FACILITY CARRIED: U.S. 169  
FEATURE INTERSECTED: 51ST STREET RR UNDER  
TOWNSHIP: T19N SECTION: 31 RANGE: R14E

BRIDGE "A" - LOCATION NO. 7283-0565 EX  
CONTROL SECTION NO. 169-72-83  
NBI NO. 19263  
FACILITY CARRIED: U.S. 169  
FEATURE INTERSECTED: 51ST STREET RR UNDER  
TOWNSHIP: T19N SECTION: 31 RANGE: R14E

SCALE  
PLAN 1" = 100'  
PROFILE HOR. 1" = 100'  
VER. 1" = 10'  
LAYOUT MAP 1" = 2,640'

- CONVENTIONAL SYMBOLS
- PROPOSED ROAD
  - RAILROADS
  - RANGE & TOWNSHIP
  - SECTION LINES
  - QUARTER SECTION LINES
  - FENCES
  - GROUND LINE
  - EXISTING ROADS
  - BASE LINE
  - GRADE LINES
  - TELEPHONE & TELEGRAPH
  - POWER LINES
  - BUILDINGS
  - OILWELL
  - DRAINAGE STRUCTURES - IN PLACE
  - DRAINAGE STRUCTURES - NEW
  - RIGHT-OF-WAY LINES - EXISTING
  - RIGHT-OF-WAY LINES - NEW
  - CONTROLLED ACCESS
  - RIGHT-OF-WAY FENCE

2009 OKLAHOMA STANDARD SPECIFICATIONS FOR HIGHWAY CONSTRUCTION GOVERN, APPROVED BY THE U.S. DEPARTMENT OF TRANSPORTATION, FEDERAL HIGHWAY ADMINISTRATION, JANUARY 4, 2010.

PREPARED BY:  
OKLAHOMA DEPARTMENT OF TRANSPORTATION  
BRIDGE DESIGN DIVISION  
**MOHAMED F. ELYAZGI, P.E.**  
OKLA. REG. NO. 17542  
DATE: 6/13/2016

OKLAHOMA DEPARTMENT OF TRANSPORTATION  
DATE APPROVED: \_\_\_\_\_  
BY: \_\_\_\_\_  
CHIEF ENGINEER

DEPARTMENT OF TRANSPORTATION  
FEDERAL HIGHWAY ADMINISTRATION  
DATE APPROVED: \_\_\_\_\_  
BY: \_\_\_\_\_  
DIVISION ADMINISTRATOR

PROJECT NO. NHPP-272A(126)3B  
SHEET NO. 1

P.E. NO. 31672(01)