

NOTES:
 Do not groove within 6" of the Expansion Joint between the Approach Slab and the Deck Slab.
 All transverse reinforcement shall be placed along radial lines to C.R.L. and are measured along edge of slab.
 All longitudinal reinforcement shall be oriented along a curve concentric with C.R.L.
 Parapet reinforcement not shown for Clarity. See Sheet No. 20 for details.
 See Sheet No. 23 for SECTIONS A, B, C & D-D.

ITEM	UNIT	APP. SLAB NO. 1	APP. SLAB NO. 2	TOTAL
③ CLSM BACKFILL	C.Y.	10.00	10.00	20.00
④ APPROACH SLAB	S.Y.	59.70	59.70	119.40
SAW-CUT GROOVING	S.Y.	51.10	51.10	102.20
CONCRETE PARAPET	L.F.	41.40	41.40	82.80
④ CLASS AA CONCRETE	C.Y.	21.60	21.60	43.20
④ EPOXY COATED REINFORCING STEEL	LB.	4,321.00	4,321.00	8,642.00
WATER REPELLENT (VISUALLY INSPECTED)	S.Y.	16.00	16.00	32.00

③ CLSM Backfill shall be used at the discretion of the Engineer, to fill any voids prior to placement of the new Approach Slabs.
 ④ The contract unit price for "APPROACH SLAB" shall be full compensation for Concrete, Epoxy Coated Reinforcing Steel (including EPI bars), Backer Rod, Rapid Cure Joint Sealant, Type III Terminal Joints, labor, equipment and other incidentals necessary to complete the work as specified on the plans.

MARK	SIZE	NO.	FORM	LENGTH	LENGTH VARIATION
EPOXY COATED REINFORCING STEEL					
AL1	#4	14	STR.	19'-11" AVG.	19'-8" TO 20'-2"
AL2	#4	14	STR.	20'-5 1/2" AVG.	20'-2" TO 20'-9"
AT1	#4	42	STR.	12'-8"	-
BL1	#9	40	STR.	20'-2 1/2" AVG.	19'-8" TO 20'-9"
BT1	#4	21	STR.	25'-9"	-
DB1	#5	28	BENT	4'-5"	-
EP1	#5	42	STR.	5'-4"	-
TT1	#4	42	BENT	3'-2"	-
TT2	#4	1	STR.	19'-8"	-
TT3	#4	1	STR.	20'-9"	-

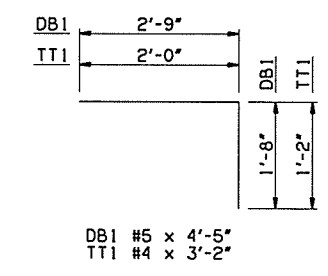

① 1/2" Longitudinal Sawed and Sealed Joint in the top of Approach Slab (See DETAIL "A" on Sheet No. 23).
 ② Type III Terminal Joint. See DETAIL "B" on Sheet No. 23.

GILCREASE EXPRESSWAY RAMP OVER COUNTY ROAD & BNSF RR BRIDGE "A"		DESIGN	JTR	4/15
APPROACH SLAB DETAILS (SHEET 1 OF 2)		DETAIL	SJL	4/15
		CHECK	BRT	5/16
		GARVER		
STATE OF OKLAHOMA	DEPARTMENT OF TRANSPORTATION			
JOB PIECE NO. 29773(04)		SHEET NO. 22		