

FED. ROAD DIST. NO.	STATE	JOB PIECE NO.	FISCAL YEAR	SHEET NO.	TOTAL SHEETS
X	OKLA.	28872(04)			

DESCRIPTION	REVISIONS	DATE

ITEM	UNIT	TOTAL
SPECIAL CONCRETE FINISH	S.Y.	47.00
CLASS A CONCRETE	C.Y.	1.40
EPOXY COATED REINFORCING STEEL	L.B.	401.00
WATER REPELLENT (VISUALLY INSPECTED)	S.Y.	33.00
PREPARATION OF CRACKS, ABOVE WATER	L.F.	30.00
EPOXY RESIN, ABOVE WATER	GAL.	1.00
PNEUMATICALLY PLACED MORTAR	S.Y.	13.40

ITEM	UNIT	TOTAL
SPECIAL CONCRETE FINISH	S.Y.	40.00
WATER REPELLENT (VISUALLY INSPECTED)	S.Y.	34.00
PREPARATION OF CRACKS, ABOVE WATER	L.F.	30.00
EPOXY RESIN, ABOVE WATER	GAL.	1.00
PNEUMATICALLY PLACED MORTAR	S.Y.	13.40

MARK	SIZE	NO.	FORM	LENGTH	LENGTH VARIATION
EPOXY COATED REINFORCING STEEL					
C1	#6	11	BENT	5'-2"	-
H1	#6	11	BENT	4'-4"	-
H2	#6	11	STR.	4'-0"	-
H3	#6	11	BENT	5'-1"	-
H4	#6	11	BENT	4'-8"	-
V1	#5	3	STR.	5'-2"	-

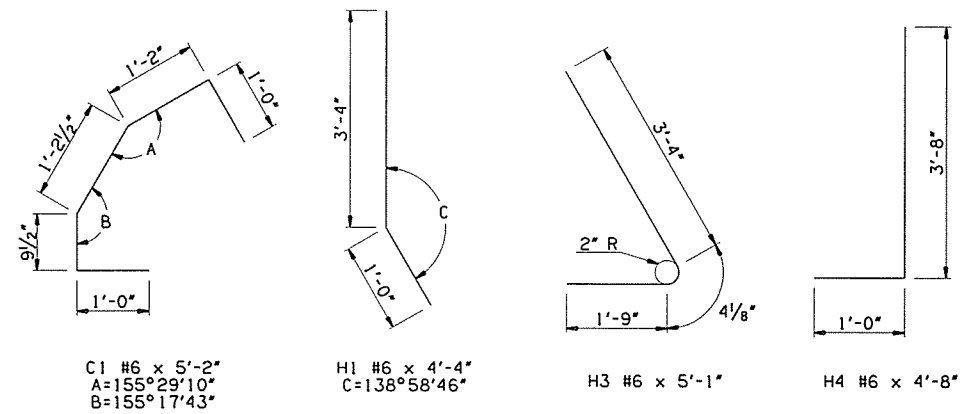

BAR BENDS - ABUTMENT NO. 1

I-44 EB OVER S 38TH W AVE TULSA COUNTY		DESIGN	NBK	11/15
& TSU RR BRIDGE 'B'		DETAIL	NBK	11/15
ABUTMENT DETAILS (SHEET 5 OF 5)		CHECK	BRT	11/15
		GARVER		

STATE OF OKLAHOMA	DEPARTMENT OF TRANSPORTATION
JOB PIECE NO. 28872(04)	SHEET NO. 34