

REV. NO.	REVISIONS DESCRIPTION	DATE

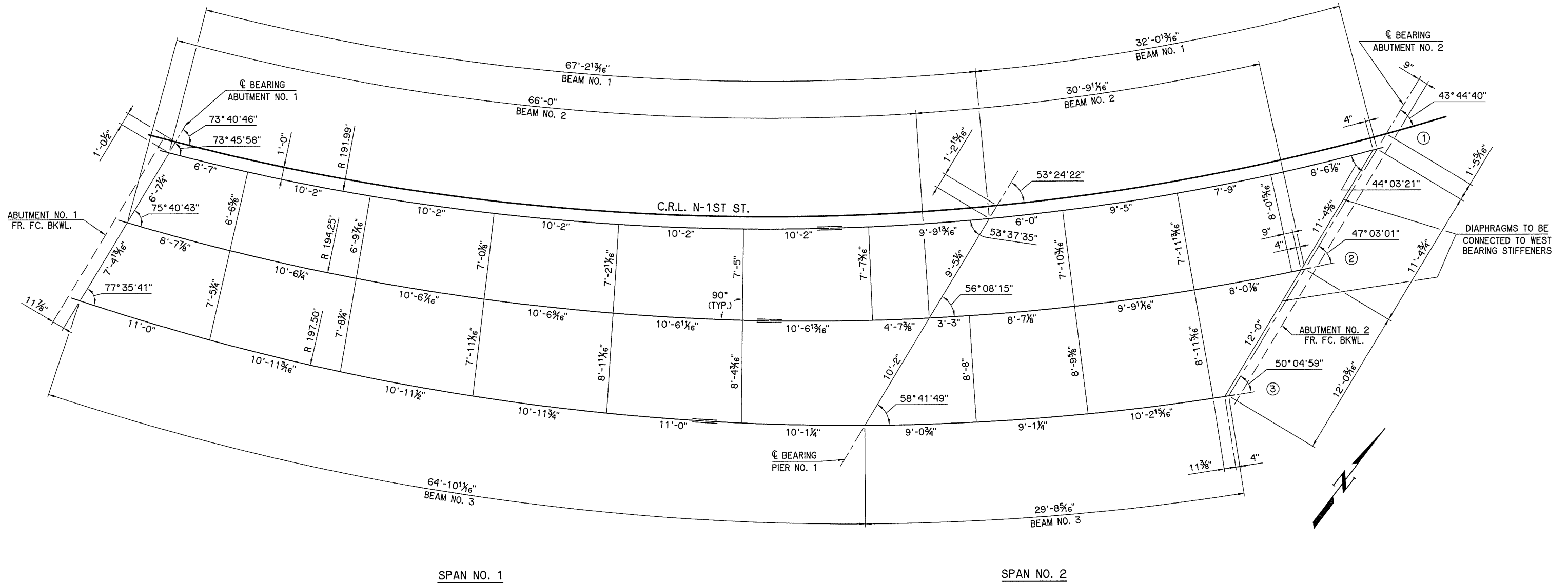

**FRAMING PLAN**

SUPERSTRUCTURE QUANTITIES		
ITEM	UNIT	TOTAL
SAW-CUT GROOVING	S.Y.	194.3
SEALED EXPANSION JOINT	L.F.	20.0
42" F-SHAPED PARAPET	L.F.	200.0
STRUCTURAL STEEL	LB.	63,810
STAINLESS STEEL FIXED BEARING ASSEMBLY	EA.	3
STAINLESS STEEL EXPANSION BEARING ASSEMBLY	EA.	6
CLASS AA CONCRETE	C.Y.	52.0
EPOXY COATED REINFORCING STEEL	LB.	19,890
WATER REPELLENT (VISUALLY INSPECTED)	S.Y.	150
SEALER CRACK PREPARATION	L.F.	20.4
SEALER RESIN	GAL.	1
5" CONCRETE SIDEWALK	S.Y.	17

N-1ST RAMP OVER U.S. 75		TULSA COUNTY		Design	JNS
<b>SUPERSTRUCTURE DETAILS</b> SHEET 3 OF 10 BEAM FRAMING PLAN				Detail	HEJ
				Check	JNS
<b>STATE OF OKLAHOMA</b>				<b>WHITE ENGINEERING ASSOCIATES</b>	
DEPARTMENT OF TRANSPORTATION		JOB PIECE NO. 28879(04)		SHEET NO. 9	