

REVISIONS		
REV. NO.	DESCRIPTION	DATE

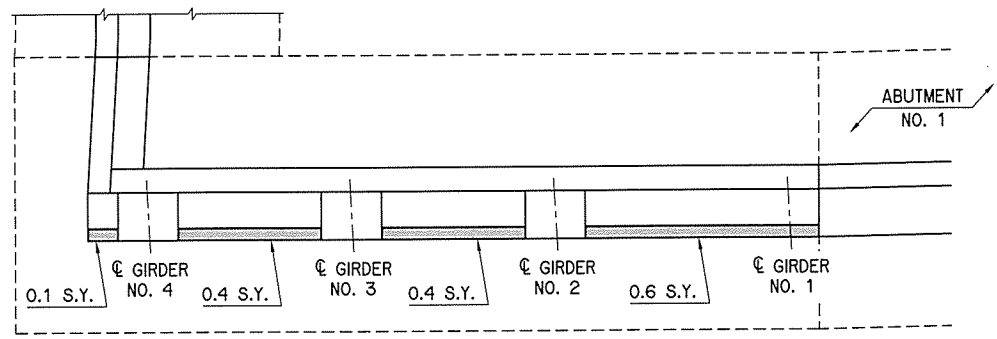

PLAN

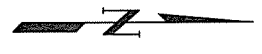
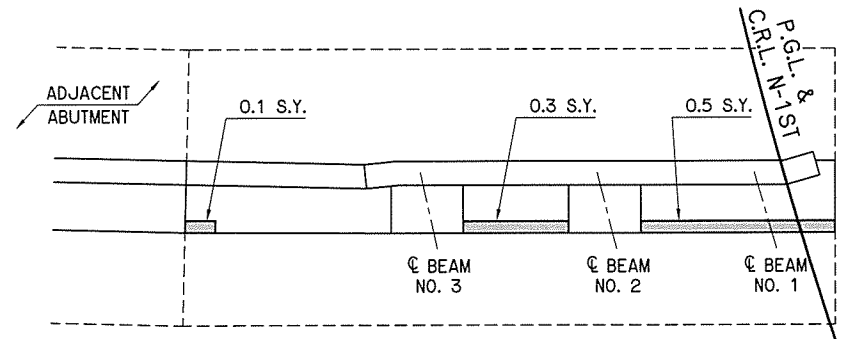

PLAN

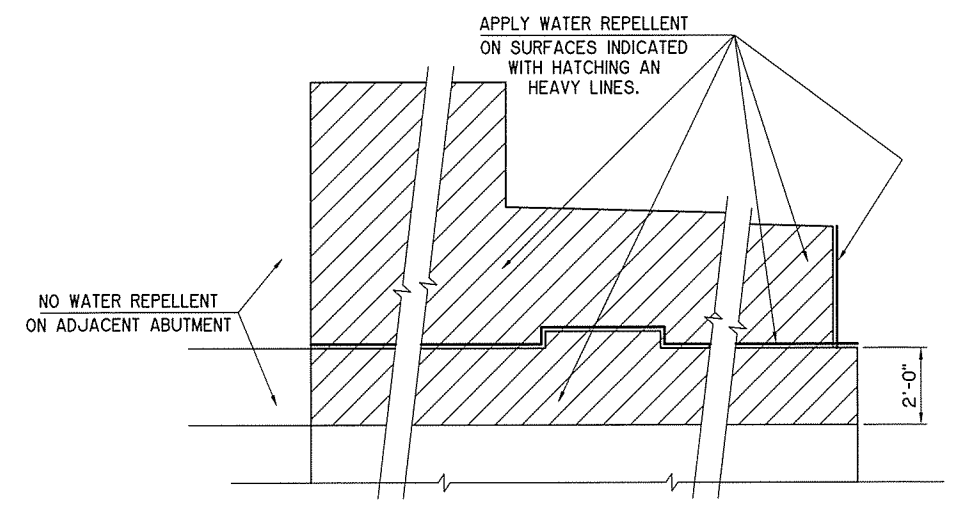

**ABUTMENT NO. 1
WATER REPELLENT TREATMENT DETAIL**

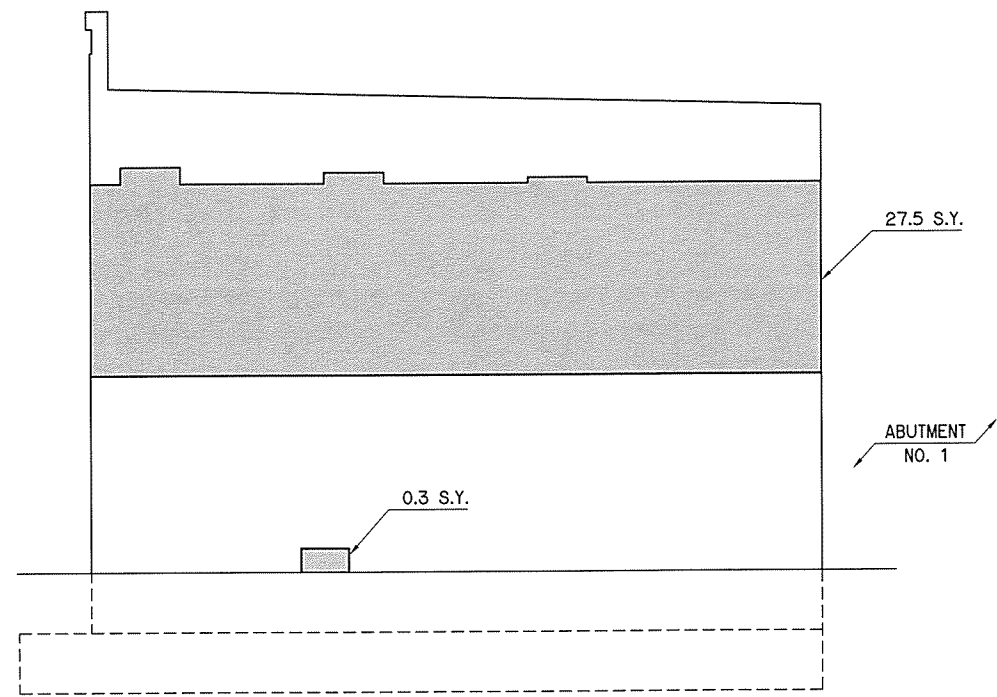

**ELEVATION
ADJACENT ABUTMENT**

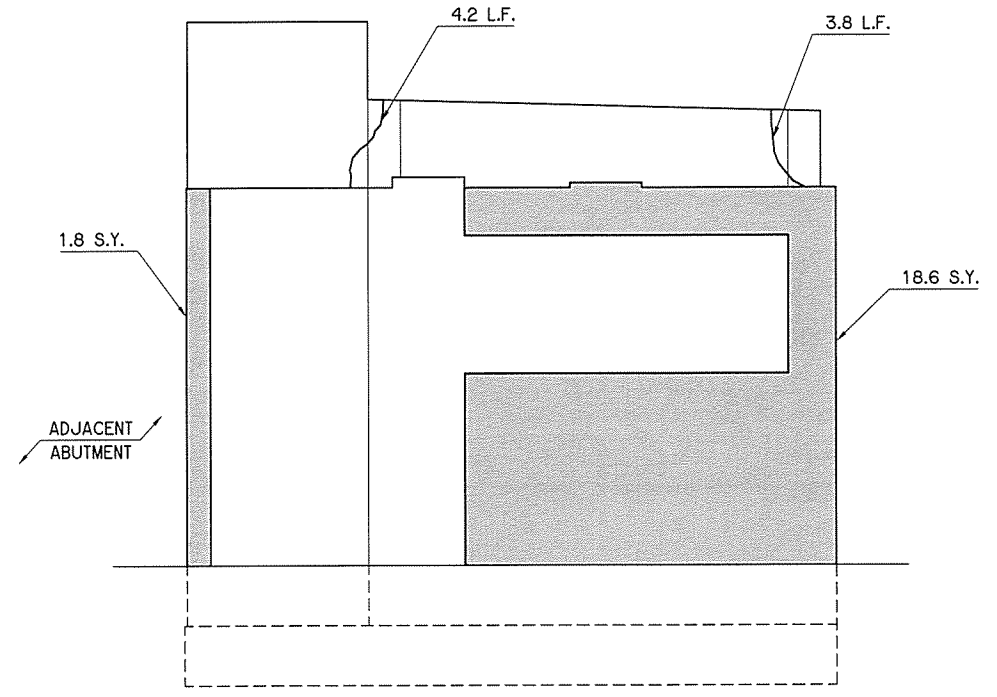

**ELEVATION
ABUTMENT NO. 1**

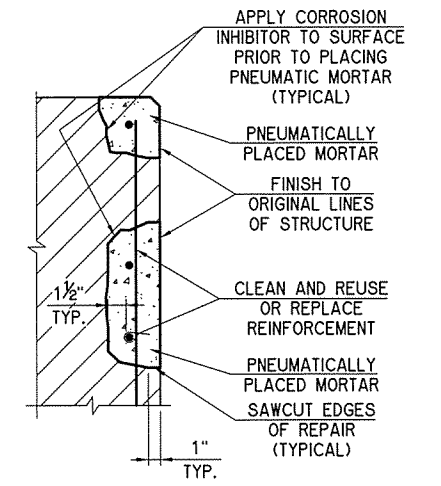

**PNEUMATICALLY PLACED MORTAR
REPAIR DETAIL**

LEGEND

- PNEUMATICALLY PLACED MORTAR WITH CORROSION INHIBITOR (SURFACE APPLIED)
- PREPARATION OF CRACKS, ABOVE WATER

ABUTMENT REPAIR QUANTITIES					
ITEM	UNIT	ABUT. NO. 1	ABUT. 1 ADJ.	ABUT. NO. 2	TOTAL
SPECIAL CONCRETE FINISH	S.Y.	68	57	56	181
CLASS C CONCRETE	C.Y.			1.1	1.1
WATER REPELLENT (VISUALLY INSPECTED)	S.Y.	25		27	52
PREPARATION OF CRACKS, ABOVE WATER	L.F.	8.0		9.8	17.8
EPOXY RESIN, ABOVE WATER	GAL.	1		1	2
PNEUMATICALLY PLACED MORTAR	S.Y.	21.3	29.3	16.1	66.7

N-1ST RAMP OVER U.S. 75		TULSA COUNTY		Design	JNS
ABUTMENT REPAIR DETAILS SHEET 1 OF 2 ABUTMENT NO. 1 AND ADJACENT ABUTMENT				Detail	HEJ
				Check	JNS
STATE OF OKLAHOMA				WHITE ENGINEERING ASSOCIATES	
				DEPARTMENT OF TRANSPORTATION	

I:\Active\1445\Drawings\Structural\5 Abutment Repair Dtls Sheet 1 of 2.dwg, 5/12/2016 10:08:41 AM, Howard