

TOP MAT REINFORCING

APPROACH SLAB NO. 1 PLAN

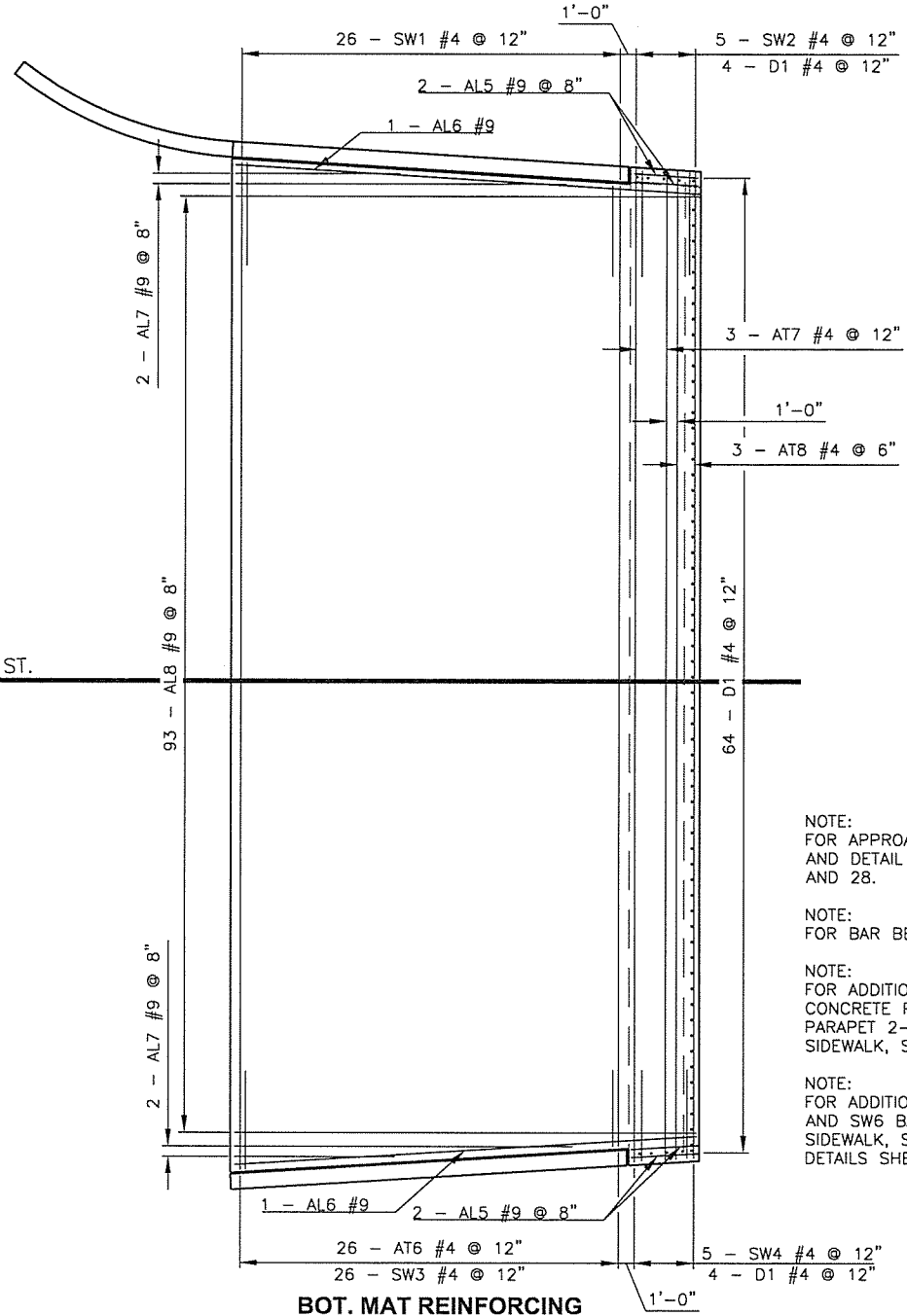

BOT. MAT REINFORCING

NOTE:
FOR APPROACH SLAB SECTIONS AND DETAIL A, SEE SHEETS 27 AND 28.

NOTE:
FOR BAR BENDS, SEE SHEET 29.

NOTE:
FOR ADDITIONAL DETAILS OF CONCRETE PARAPET, INCLUDING PARAPET 2-B BARS CAST INTO SIDEWALK, SEE SHEETS 29-31.

NOTE:
FOR ADDITIONAL DETAIL OF SW5 AND SW6 BARS CAST INTO SIDEWALK, SEE EXPANSION JOINT DETAILS SHEET 24.

① **APPROACH SLAB NO. 1 BAR LIST**

EPOXY COATED REINFORCING

MARK	SIZE	NO.	FORM	LENGTH	LENGTH VARIATION
AL1	#4	2	STR.	4'-3"	
AL2	#4	2	STR.	29'-9"	
AL3	#4	2	STR.	16'-0"	
AL4	#4	65	STR.	29'-10"	
AL5	#9	4	STR.	4'-3"	
AL6	#9	2	STR.	29'-9"	
AL7	#9	4	STR.	16'-0" AVG.	10'-8" TO 21'-4"
AL8	#9	93	STR.	29'-10"	
AT1	#4	26	STR.	17'-4" AVG.	16'-7" TO 18'-1"
AT2	#4	5	STR.	17'-6" AVG.	17'-5" TO 17'-7"
AT3	#4	31	STR.	23'-8"	
AT4	#4	26	STR.	21'-5" AVG.	20'-8" TO 22'-2"
AT5	#4	5	STR.	21'-6" AVG.	21'-5" TO 21'-7"
AT6	#4	26	STR.	65'-1" AVG.	63'-7" TO 66'-7"
AT7	#4	3	STR.	65'-6" AVG.	65'-5" TO 65'-7"
AT8	#4	3	STR.	65'-2"	
D1	#4	72	BNT.	3'-6"	
L2	#4	4	BNT.	2'-2"	
SW1	#4	26	BNT.	10'-7" AVG.	10'-0" TO 11'-2"
SW2	#4	5	BNT.	11'-0" AVG.	10'-11" TO 11'-1"
SW3	#4	26	BNT.	9'-5" AVG.	9'-0" TO 9'-10"
SW4	#4	5	BNT.	10'-0" AVG.	9'-11" TO 10'-1"

④ **APPROACH SLAB NO. 1 SIDEWALK BAR LIST**

EPOXY COATED REINFORCING

MARK	SIZE	NO.	FORM	LENGTH	LENGTH VARIATION
C1	#5	5	BNT.	9'-3"	
C2	#5	4	BNT.	5'-11"	
C3	#5	11	BNT.	8'-10" AVG.	8'-5" TO 9'-3"
C5	#5	11	BNT.	6'-10" AVG.	6'-5" TO 7'-3"
C7	#5	21	BNT.	4'-4" AVG.	3'-5" TO 5'-3"
CB	#5	14	BNT.	4'-9"	
L1	#4	8	BNT.	1'-4"	
L2	#4	2	BNT.	2'-2"	
SL1	#4	17	STR.	29'-10"	
SL2	#4	2	STR.	4'-3"	
SW5	#4	3	STR.	6'-4"	
SW6	#4	3	STR.	7'-4"	

- ① REINFORCEMENT INCLUDED IN THE CONTRACT UNIT PRICE OF "APPROACH SLAB".
- ② TWO SETS OF 2.
- ③ INCLUDES ONE LAP AT 2'-0".
- ④ REINFORCEMENT INCLUDED IN THE CONTRACT UNIT PRICE OF "EPOXY COATED REINFORCING STEEL".

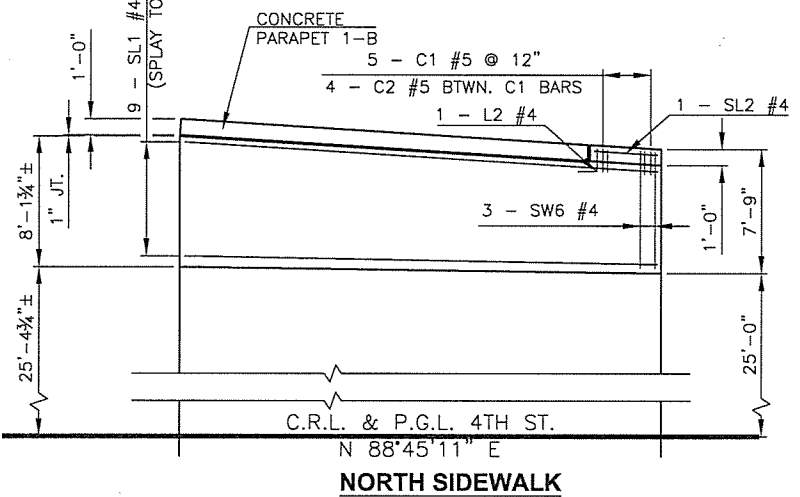

NORTH SIDEWALK

APPROACH SLAB NO. 1 SIDEWALK PLAN

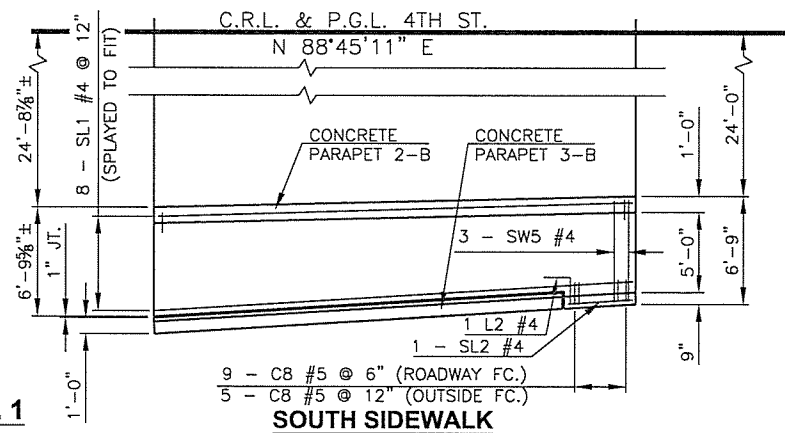

SOUTH SIDEWALK

APPROACH SLAB QUANTITIES

ITEM	UNIT	APPROACH SLAB NO. 1	APPROACH SLAB NO. 2	TOTAL
CLSM BACKFILL	C.Y.	75	95	170
APPROACH SLAB	S.Y.	211.8	271.1	482.9
SAW-CUT GROOVING	S.Y.	165	209	374
CONCRETE PARAPET	L.F.	105.0	114.0	219.0
CLASS AA CONCRETE	C.Y.	11.1	15.2	26.3
EPOXY COATED REINFORCING STEEL	LB.	800	1000	1,800
WATER REPELLENT (VISUALLY INSPECTED)	S.Y.	105	132	237

Ⓐ ASSUMED 1'-0" DEPTH BELOW EXTENTS OF APPROACH SLABS FOR COMPUTING CLSM BACKFILL QUANTITY, FOR ESTIMATING PURPOSES ONLY. ACTUAL QUANTITY TO BE DETERMINED IN THE FIELD BY THE ENGINEER.