

**TYPE (B) DIAPHRAGM**  
(FOR INFORMATION ONLY)

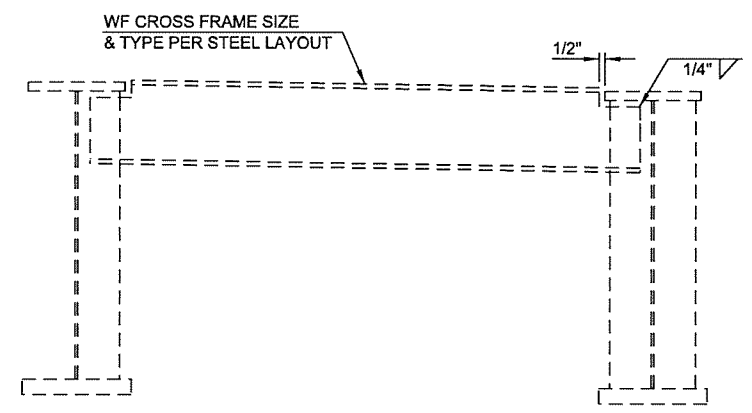

**TYPE (C) DIAPHRAGM**  
(FOR INFORMATION ONLY)

SPAN	BEAM	BRG. TO BRG. LENGTH	BEAM AND DIAPHRAGM DEFLECTION						DECK SLAB, HAUNCH, S.I.P. STEEL DECK FORMS AND TRAFFIC RAIL DEFLECTIONS						LFD OPERATING RATING
			CL BRG.	0.1 & 0.9	0.2 & 0.8	0.3 & 0.7	0.4 & 0.6	0.5	CL BRG.	0.1 & 0.9	0.2 & 0.8	0.3 & 0.7	0.4 & 0.6	0.5	
			R3	RG-1	80'-4 5/8"	0.00"	0.06"	0.12"	0.16"	0.18"	0.19"	0.00"	0.24"	0.44"	
	RG-2	76'-5 5/8"	0.00"	0.08"	0.15"	0.19"	0.22"	0.22"	0.00"	0.31"	0.56"	0.73"	0.83"	0.84"	HS 86.2
	RG-3	73'-6 1/8"	0.00"	0.10"	0.18"	0.24"	0.28"	0.29"	0.00"	0.38"	0.69"	0.92"	1.07"	1.12"	HS 89.3
R4	RG-1	25'-7 3/8"	0.00"	0.00"	0.00"	0.01"	0.01"	0.01"	0.00"	0.01"	0.02"	0.02"	0.03"	0.03"	HS 64.1
	RG-2	40'-4 3/4"	0.00"	0.02"	0.03"	0.04"	0.05"	0.05"	0.00"	0.08"	0.14"	0.20"	0.24"	0.24"	HS 53.5
	RG-3	54'-1 3/4"	0.00"	0.04"	0.08"	0.10"	0.11"	0.12"	0.00"	0.20"	0.36"	0.48"	0.55"	0.58"	HS 49.1
R5	RG-1	47'-11"	0.00"	0.02"	0.04"	0.06"	0.07"	0.07"	0.00"	0.13"	0.24"	0.32"	0.37"	0.39"	HS 52.2
	RG-2	48'-10 7/8"	0.00"	0.03"	0.06"	0.07"	0.09"	0.09"	0.00"	0.16"	0.29"	0.39"	0.46"	0.49"	HS 77.8
	RG-3	49'-10 3/4"	0.00"	0.04"	0.07"	0.09"	0.10"	0.11"	0.00"	0.20"	0.35"	0.47"	0.55"	0.59"	HS 59.4

N:\11399200-11399-13001-05\CAD\SheetFiles\J 28865 (04) -69-BR.B-Steel\_Details.2.dgn  
 6/7/2016

DESIGN	JSH	1-15	<b>OKLAHOMA DEPARTMENT OF TRANSPORTATION</b>  <b>STEEL DETAILS</b> SHEET 2 OF 2 STATE JOB NO. 28865(04) SHEET NO. 69 TULSA CO. 2ND STREET
DRAWN	MRM	1-15	
CHECKED	LWN	3-16	
APPROVED			
SQUAD	TT		