

PARTIAL SECTION AT INTERMEDIATE DIAPHRAGM      PARTIAL SECTION AT END DIAPHRAGM

**TYPICAL SECTION - EXISTING BRIDGE DECK**  
(FOR INFORMATION ONLY)

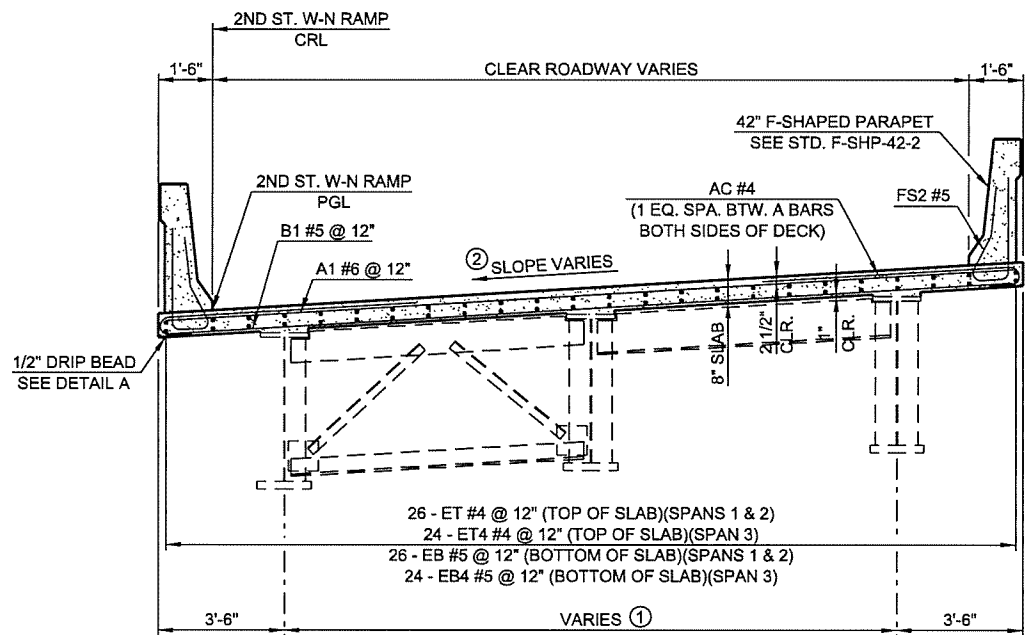

PARTIAL SECTION AT INTERMEDIATE DIAPHRAGM      PARTIAL SECTION AT END DIAPHRAGM

**TYPICAL SECTION - PROPOSED BRIDGE DECK**

NOTE:  
FOR BAR BENDS AND BAR LIST SEE SHEET 65. ROATE HOOKS ON A BARS TO MAINTAIN MINIMUM CLEARANCE.

- ① SEE FRAMING PLAN ON SHEET 63 FOR DIMENSIONS
- ② SEE SHEET 15 FOR CROSS SLOPE

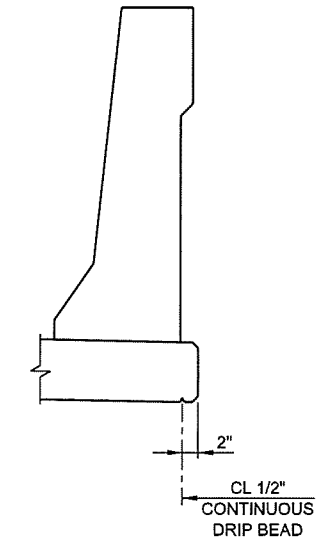

**DETAIL A**

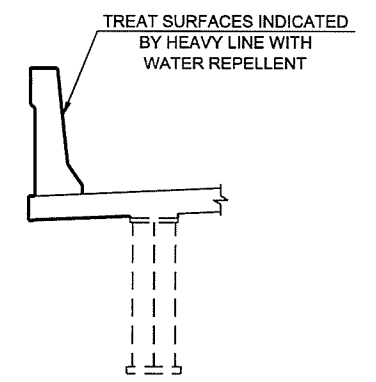

**WATER REPELLENT TREATMENT DETAILS**

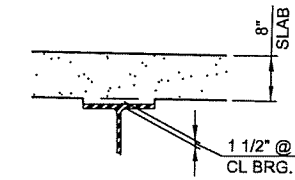

**BEAM HAUNCH DETAIL**

NOTE:  
PLAN QUANTITIES FOR CLASS AA CONCRETE INCLUDE BEAM HAUNCHES. THE HAUNCH HEIGHT SHOWN IS THE THEORETICAL HAUNCH HEIGHT AT THE CENTERLINE BEARING ONLY, MEASURED FROM THE BOTTOM OF THE DECK SLAB TO THE TOP OF THE BEAM, AND VARIES ACROSS THE SPAN. DETERMINE THE ACTUAL HEIGHT (ACCOUNTING FOR BEAM CAMBER, DEAD LOAD DEFLECTION AND ROADWAY GRADE) AFTER RESETTING THE BEAMS AND SUBMIT TO THE ENGINEER FOR APPROVAL. THE ENGINEER WILL NOT MEASURE DIFFERENCES BETWEEN THE THEORETICAL AND THE ACTUAL HEIGHTS FOR PAYMENT

SUPERSTRUCTURE QUANTITIES		
DESCRIPTION	UNIT	TOTAL
SAW-CUT GROOVING	SY	385.0
SEALED EXPANSION JOINT	LF	54.0
42" F-SHAPED PARAPET	LF	341.2
STRUCTURAL STEEL	LB	1000.0
WEATHERING STEEL FIXED BEARING ASSEMBLY	EA	9.0
WEATHERING STEEL EXPANSION BEARING ASSEMBLY	EA	9.0
CLASS AA CONCRETE	CY	100.6
EPOXY COATED REINFORCING	LB	27960.0
WATER REPELLENT (VISUALLY INSPECTED)	SY	450.0
SEALER CRACK PREPARATION	LF	39.0
SEALER RESIN	GAL	0.5

N:\11399\200-11399-13001-05\CAD\SheetFiles\JP 28865 (04) -62-BR.B-Typ.Section.dgn 6/7/2016

DESIGN	JSH	1-1-6	<b>OKLAHOMA DEPARTMENT OF TRANSPORTATION</b>  <b>TYPICAL BRIDGE SECTION</b>  STATE JOB NO. 28865(04) SHEET NO. 62 TULSA CO. 2ND STREET
DRAWN	MRM	1-1-6	
CHECKED	LWN	3-1-6	
APPROVED			
SQUAD	TT		