

NOTE:
FOR ADDITIONAL DETAIL OF
F-SHAPED PARAPET, SEE STD.
FSHP-42-2.

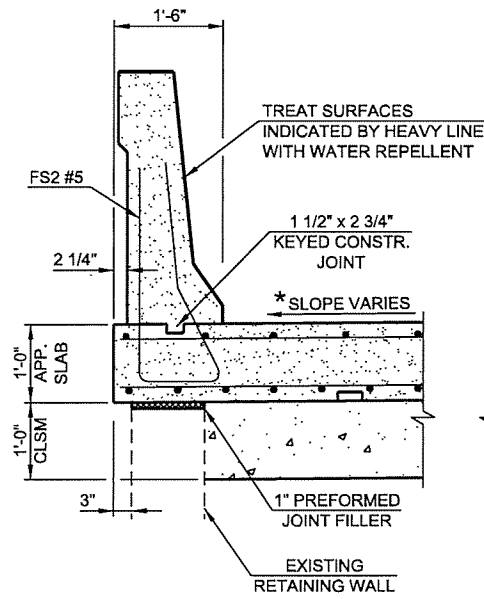

SECTION A

NOTE:
PLACE REINFORCING IN THE TOP OF APPROACH SLAB 2" FROM
EITHER SIDE OF THE SAWED AND SEALED LONGITUDINAL
JOINT. FOR ADDITIONAL DETAILS FOR LONGITUDINAL JOINT,
SEE STD. LECS-4.

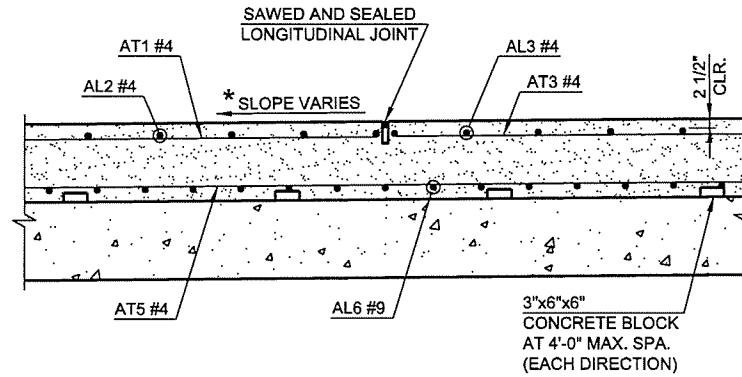

SECTION B

NOTE:
FOR ADDITIONAL DETAIL OF
CONCRETE TRAFFIC RAIL,
SEE STD. TR4-2.

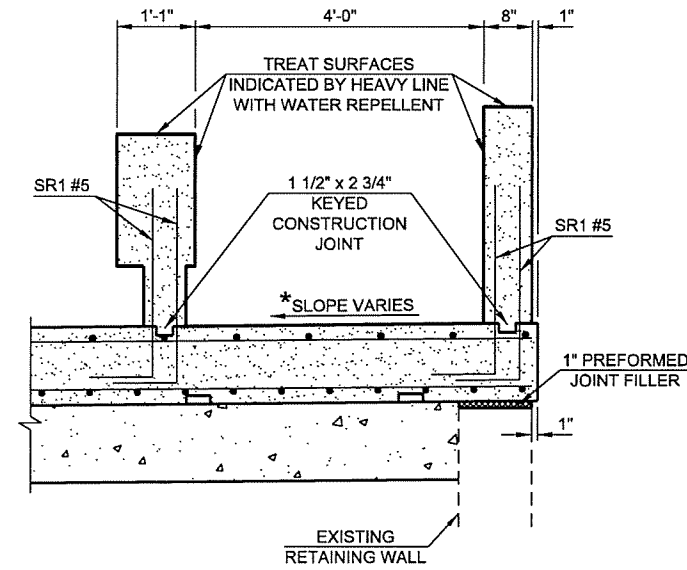

SECTION C

*SEE SHEET 15 FOR CROSS SLOPES

APPROACH SLAB NO. 2 BAR LIST

MARK	SIZE	NO.	FORM	LENGTH	LENGTH VARIES
EPOXY COATED REINFORCING BARS					
AT1	#4	35	STR	27'-2"	
AT2	#4	21	STR	13'-0" AVG	1'-3" TO 24'-9"
AT3	#4	62	STR	18'-6"	
AT4	#4	10	STR	11'-5" AVG	5'-7" TO 17'-3"
AT5	#4	38	STR	46'-0"	
AT6	#4	34	STR	24'-8" AVG	5'-7" TO 43'-9"
AL1	#4	2	STR	29'-9"	
AL2	#4	27	STR	42'-11" AVG	30'-5" TO 55'-5"
① AL3	#4	14	STR	63'-5" AVG	57'-5" TO 69'-5"
① AL4	#4	6	STR	71'-3"	
AL5	#9	3	STR	29'-9"	
AL6	#9	46	STR	49'-9" AVG	35'-0" TO 64'-6"
② AL7	#9	9	STR	68'-8" AVG	65'-2" TO 72'-2"
② AL8	#9	9	STR	69'-7"	
③ FS2	#5	31	BNT	7'-4"	
④ SR1	#5	351	BNT	4'-1"	

- ① INCLUDES 1 LAP LENGTH OF 1'-8"
- ② INCLUDES 1 LAP LENGTH OF 4'-6"
- ③ FOR BAR BEND, SEE STD. FSHP-42-2
- ④ FOR BAR BEND, SEE STD. TR4-2

APPROACH SLAB NO. 2 QUANTITIES

DESCRIPTION	UNIT	TOTAL
⑤ APPROACH SLAB	SY	265
SAW-CUT GROOVING	SY	215
CONCRETE RAIL (TR4)	LF	68.7
42" F-SHAPED PARAPET	LF	30
CONCRETE PARAPET	LF	70
WATER REPELLENT (VISUALLY INSPECTED)	SY	130.7
CLSM BACKFILL	CY	85

⑤ THE DEPARTMENT CONSIDERS THE COST OF CONCRETE, REINFORCING STEEL (INCLUDING FS2 AND SR1 BARS), BACKER ROD, RAPID CURE JOINT SEALANT, POLYSTYRENE AND POLYETHYLENE SHEETING AND PREFORMED JOINT FILLER TO BE INCLUDED IN THE CONTRACT UNIT PRICE OF APPROACH SLAB. THERE IS AN ESTIMATED 88.2 C.Y. OF CLASS AA CONCRETE AND AN ESTIMATED 19,130 LB OF EPOXY COATED REINFORCING STEEL IN APPROACH SLAB NO. 2.

2ND STREET OVER I-444 - BRIDGE 'A'

DESIGN	JSH	3-1-6	OKLAHOMA DEPARTMENT OF TRANSPORTATION
DRAWN	MRM	3-1-6	
CHECKED	JWB	3-1-6	
APPROVED			
SQUAD	TT		

APPROACH SLAB NO. 2
SHEET 2 OF 2
STATE JOB NO. 28865(04) SHEET NO. 51
TULSA CO. 2ND STREET