

APPROACH SLAB NO. 1
TOP REINFORCING
MAT DETAIL

SEE SHEET 3 OF 3 FOR
TRAFFIC RAIL REINFORCING

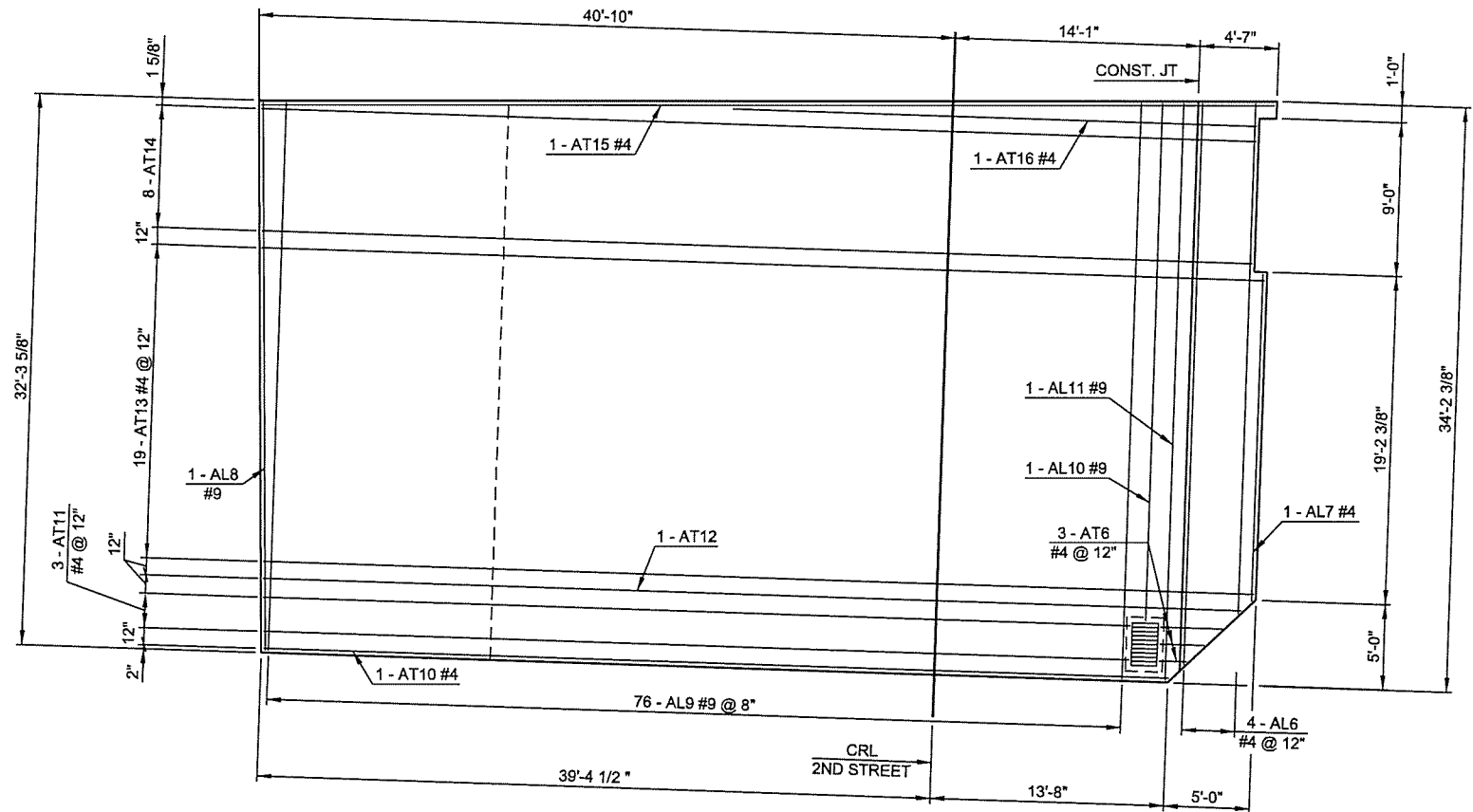

APPROACH SLAB NO. 1
BOTTOM REINFORCING
MAT DETAIL

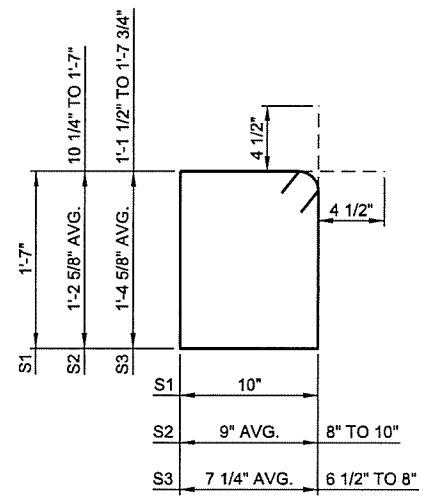
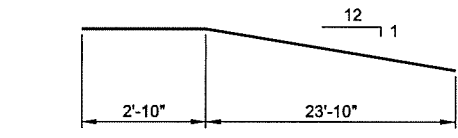

S1 #4 x 5'-7" AVG.
S2 #4 x 4'-8 1/4" AVG.
S3 #4 x 4'-8 3/4" AVG.

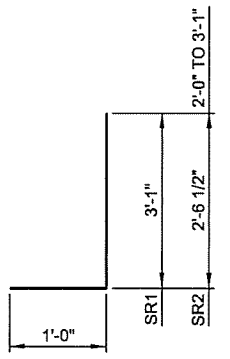

SR1 #5 x 4'-1"
SR2 #5 x 3'-6 1/2"

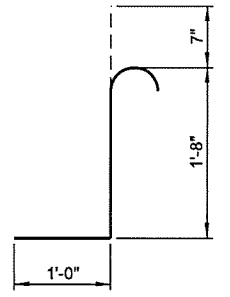

SR3 #5 x 3'-3"

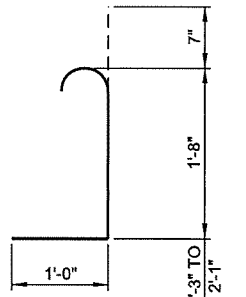

SR4 #5 x 3'-3"

APPROACH SLAB NO. 1 BAR LIST					
FOR INFORMATION ONLY (NOT SHOWN IN QUANTITIES)					
MARK	SIZE	NO.	FORM	LENGTH	LENGTH VARIES
EPOXY COATED REINFORCING BARS					
AL1	#4	1	STR	32'-1"	
AL2	#4	27	STR	32'-5" AVG.	32'-0" TO 32'-10"
AL3	#4	24	STR	33'-3" AVG.	32'-10" TO 33'-8"
AL4	#4	1	STR	30'-0"	
AL5	#4	1	STR	33'-9"	
AL6	#4	8	STR	31'-6" AVG.	29'-6" TO 33'-6"
AL7	#4	2	STR	18'-11"	
AL8	#9	1	STR	32'-1"	
AL9	#9	76	STR	32'-10" AVG.	32'-0" TO 33'-8"
AL10	#9	1	STR	30'-0"	
AL11	#9	1	STR	33'-9"	
AT1	#4	33	STR	26'-10" AVG.	26'-1" TO 27'-7"
AT2	#4	1	STR	27'-7"	
AT3	#4	1	STR	26'-5"	
AT4	#4	3	STR	25'-3"	
AT5	#4	1	STR	30'-5"	
AT6	#4	6	STR	2'-0" AVG.	1'-0" TO 3'-0"
AT7	#4	19	STR	31'-5"	
AT8	#4	9	STR	30'-5"	
AT9	#4	1	STR	31'-5"	
AT10	#4	1	STR	52'-9"	
AT11	#4	3	STR	46'-6"	
AT12	#4	1	STR	56'-9"	
AT13	#4	19	STR	58'-7" AVG.	58'-2" TO 58'-11"
AT14	#4	8	STR	58'-2" AVG.	58'-0" TO 58'-3"
AT15	#4	1	STR	59'-4"	
AT16	#4	1	STR	23'-0"	
FS2	#5	18	BNT	7'-4"	
FS6	#5	5	BNT	7'-6 1/2"	
R1	#5	2	BNT	26'-9"	
R2	#5	2	STR	8'-10"	
R3	#5	2	STR	14'-10"	
R4	#5	2	STR	20'-10"	
R5	#5	4	STR	26'-10"	
S1	#4	7	BNT	5'-7" AVG.	
S2	#4	22	BNT	4'-8 1/4" AVG.	
S3	#4	16	BNT	4'-8 3/4" AVG.	
SR1	#5	10	BNT	4'-1"	
SR2	#5	51	BNT	3'-6 1/2" AVG.	
SR3	#5	20	BNT	3'-3" AVG.	
SR4	#5	8	BNT	3'-3" AVG.	

- ① 2 SETS OF 4
- ② 2 SETS OF 3
- ③ SEE STD. FSHP-42-2 FOR BAR BEND

DESIGN			DRAWN			CHECKED			APPROVED			SQUAD		
JWB	3-16		MRM	3-16		JSH	3-16				TT			

2ND STREET OVER I-444 - BRIDGE 'A'

OKLAHOMA DEPARTMENT OF TRANSPORTATION

APPROACH SLAB NO. 1
SHEET 2 OF 3
STATE JOB NO. 28865(04) SHEET NO. 48
TULSA CO. 2ND STREET

6/7/2016 N:\11399\200-11399-13001-05\CAD\SheetFiles\JP 28865 (04) -48-BR.A-App.Slab.1.2.dgn