

DESCRIPTION	REVISIONS	DATE

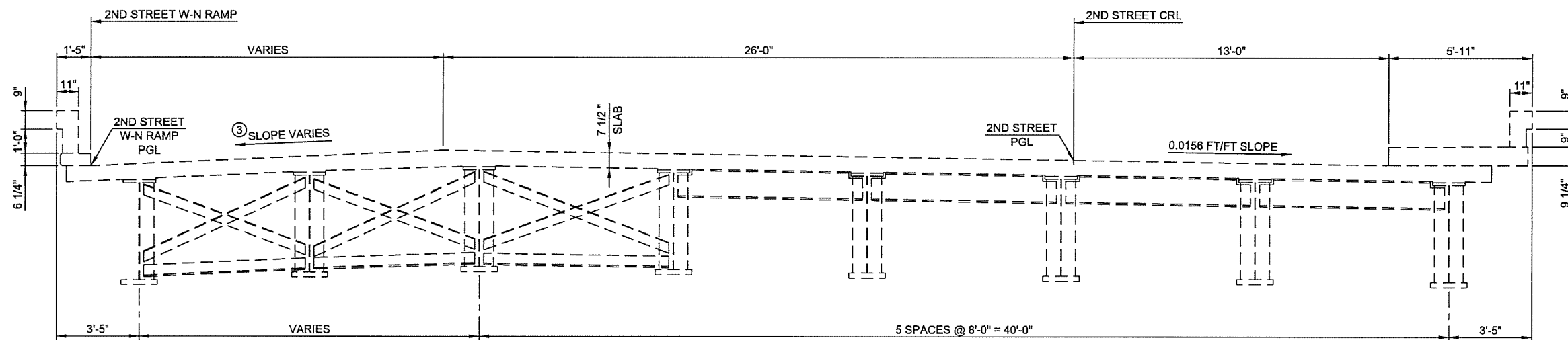

PARTIAL SECTION AT INTERMEDIATE DIAPHRAGM

PARTIAL SECTION AT END DIAPHRAGM

TYPICAL SECTION - EXISTING BRIDGE DECK

(FOR INFORMATION ONLY)

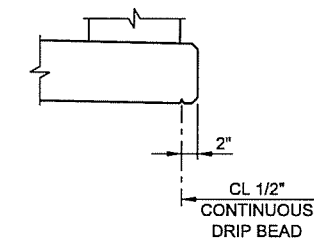

DETAIL A

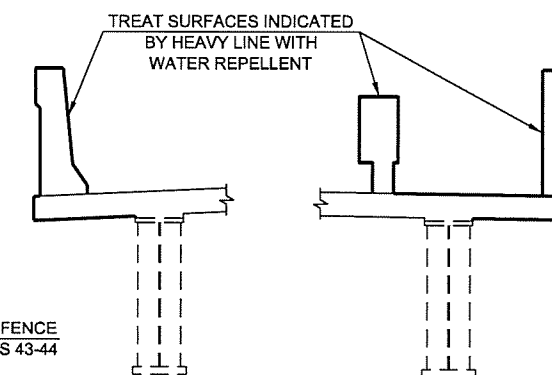

WATER REPELLENT TREATMENT DETAILS

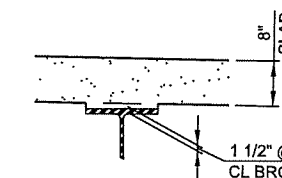

BEAM HAUNCH DETAIL

NOTE:
 PLAN QUANTITIES FOR CLASS AA CONCRETE INCLUDE BEAM HAUNCHES. THE HAUNCH HEIGHT SHOWN IS THE THEORETICAL HAUNCH HEIGHT AT THE CENTERLINE BEARING ONLY, MEASURED FROM THE BOTTOM OF THE DECK SLAB TO THE TOP OF THE BEAM, AND VARIES ACROSS THE SPAN. DETERMINE THE ACTUAL HEIGHT (ACCOUNTING FOR BEAM CAMBER, DEAD LOAD DEFLECTION AND ROADWAY GRADE) AFTER RESETTING THE BEAMS AND SUBMIT TO THE ENGINEER FOR APPROVAL. THE ENGINEER WILL NOT MEASURE DIFFERENCES BETWEEN THE THEORETICAL AND THE ACTUAL HEIGHTS FOR PAYMENT

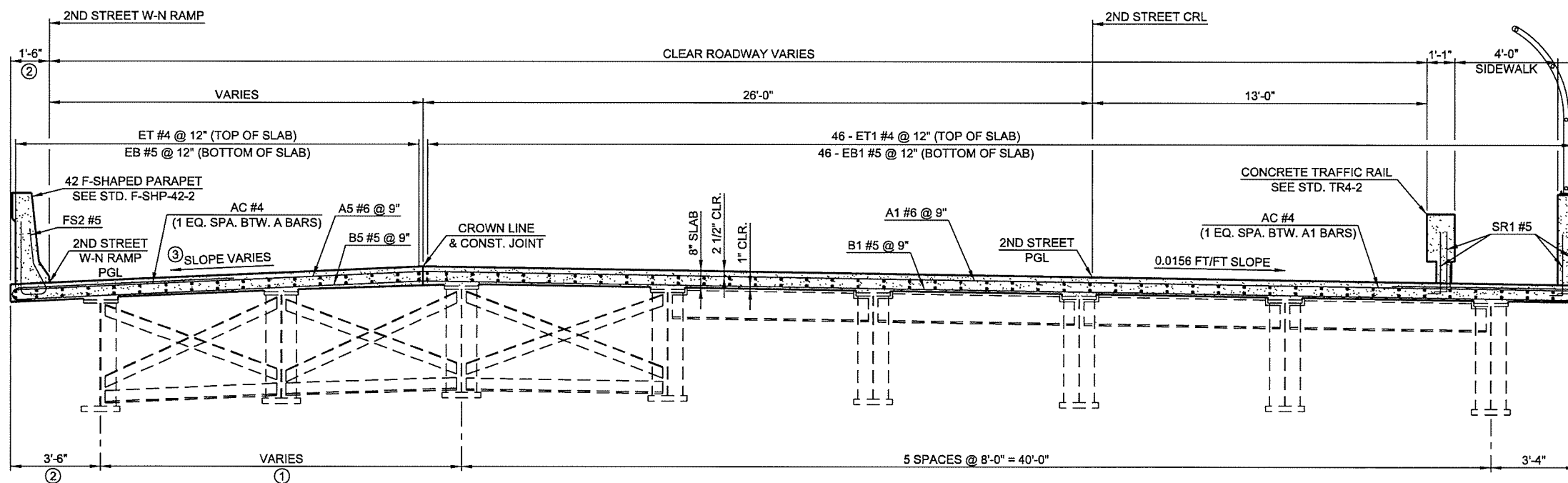

PARTIAL SECTION AT INTERMEDIATE DIAPHRAGM

PARTIAL SECTION AT END DIAPHRAGM

TYPICAL SECTION - PROPOSED BRIDGE DECK

SPAN 1

NOTE:
 FOR BAR BENDS AND BAR LIST SEE SHEET 33. ROTATE HOOKS ON A BARS TO MAINTAIN MINIMUM CLEARANCE.

- ① SEE FRAMING PLAN ON SHEET 29 FOR DIMENSIONS
- ② MEASURED PERPENDICULAR TO 2ND STREET W-N RAMP CRL
- ③ SEE SHEET 15 FOR CROSS SLOPE

DESIGN	JSH	1-16	OKLAHOMA DEPARTMENT OF TRANSPORTATION TYPICAL BRIDGE SECTION SPAN 1 STATE JOB NO. 28865(04) SHEET NO. 26 TULSA CO. 2ND STREET
DRAWN	MRM	1-16	
CHECKED	LWN	3-16	
APPROVED			
SQUAD	TT		

N:\11399\200-11399-13001-05\CAD\SheetFiles\JP 28865 (04) -26-BR-A-Typ.Section.1.dgn
 6/7/2016