

| DESCRIPTION | REVISIONS | DATE |
|-------------|-----------|------|
| | | |

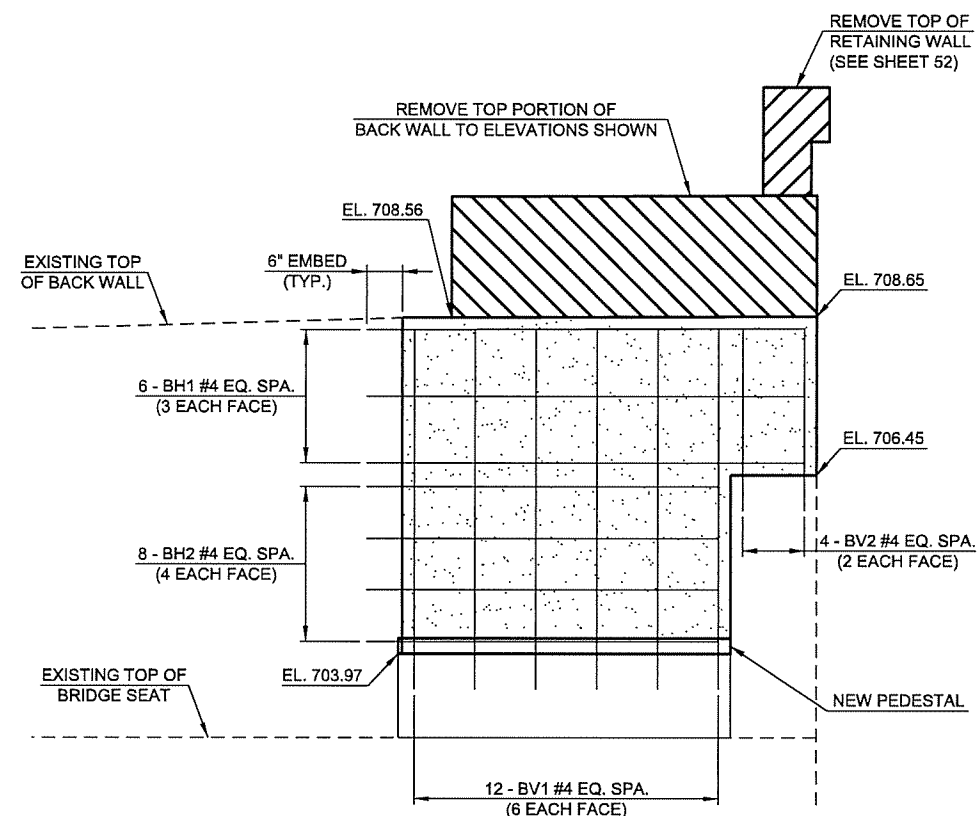

SECTION A-A
(FROM SHEET 20)
(REPAIR BRIDGE ITEM (TYPE A))

**REPAIR BRIDGE ITEM (TYPE A)
BAR LIST**

(FOR INFORMATION ONLY)

| MARK | SIZE | NO. | FORM | LENGTH |
|-------------------------------|------|-----|------|--------|
| EPOXY COATED REINFORCING BARS | | | | |
| BH1 | #4 | 6 | BNT | 5'-10" |
| BH2 | #4 | 8 | BNT | 4'-10" |
| BV1 | #4 | 12 | STR | 5'-0" |
| BV2 | #4 | 4 | STR | 2'-6" |

NOTE:
SEE ANCHORAGE SYSTEM NOTE
ON SHEET 20

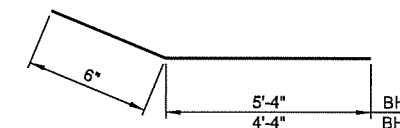

BH1 #4 x 5'-10" (FOR INFORMATION ONLY)
BH2 #4 x 4'-10" (FOR INFORMATION ONLY)

N:\11399\200-11399-13001-05\CAD\SheetFiles\JP 28865 (04) -21-BR.A-Abut. 2.2.dgn

6/6/2016

2ND STREET OVER I-444 - BRIDGE 'A'

| | | | |
|----------|-----|------|--|
| DESIGN | JSH | 3-16 | OKLAHOMA DEPARTMENT OF TRANSPORTATION ABUTMENT NO. 2 REPAIRS SHEET 2 OF 2 STATE JOB NO. 28865(04) SHEET NO. 21 TULSA CO. 2ND STREET |
| DRAWN | MRM | 3-16 | |
| CHECKED | LWN | 3-16 | |
| APPROVED | | | |
| SQUAD | TT | | |