

DESCRIPTION	REVISIONS	DATE

CURVE NO.	CURVE DATA								COORDINATES					
	P.I. STA.	Δ	D	T	L	R	E	P.I.		P.C.		P.T.		
								NORTH	EAST	NORTH	EAST	NORTH	EAST	
C1	226+37.28	57° 42' 26"	25° 00'	126.27'	230.83'	229.18'	32.48'	426,630.22	2,564,854.78	427,624.35	2,564,728.65	427,739.98	2,564,917.20	
C2	230+42.34	55° 26' 38"	18° 00'	167.27'	308.02'	318.31'	41.27'	428,001.20	2,565,065.75	427,855.80	2,564,983.06	428,015.58	2,565,232.40	
C3	518+84.07	49° 40' 00"	30° 00'	88.38'	165.56'	190.99'	19.46'	427,667.52	2,564,703.60	427,660.17	2,564,615.53	427,739.41	2,564,755.00	
C4	521+21.79	45° 35' 41"	15° 00'	160.54'	303.96'	381.97'	32.37'	427,870.01	2,564,848.37	427,739.41	2,564,755.00	428,028.09	2,564,820.41	

CONTROL POINT	DESCRIPTION	NORTH	EAST	ELEVATION
CP1	COT PW008 ALUM CAP	427344.91	2563496.61	712.88
CP2	3/8" IRON PIN	427757.48	2564401.94	709.80
CP3	3/8" IRON PIN	427687.42	2564536.51	707.82
CP4	3/8" IRON PIN	427742.03	2564879.63	706.06
CP5	3/8" IRON PIN	427836.52	2564931.97	706.82
CP6	3/8" IRON PIN	427995.33	2564820.12	691.49

- REPLACE INLET FRM, GRT & HOOD ON EXISTING INLET STRUCTURE AND REPLACE DAMAGED PORTIONS OF EXISTING 15" RCP AS NECESSARY UP TO 19'
- REPLACE DAMAGED PORTIONS OF EXISTING 15" RCP AS NECESSARY UP TO 29 LF
- REPLACE INLET FRM, GRT & HOOD ON EXISTING INLET STRUCTURE
- CONST. INLET LONG. BARR. TYPE 1, DES. 1
- REMOVE AND REPLACE EXIST. DAMAGED PAVED DITCH STA 223+45, 56' LT TO STA 223+48, 40 LT WITH PAVED DITCH DESIGN NO. 1 INCLUDING 8 S.Y. OF CONC. PAVEMENT REMOVAL AND 2 C.Y. OF CLASS C CONCRETE
- REPAIR DAMAGED SLOPE ADJACENT TO PAVED DITCH INCLUDING 8 C.Y. OF UNCLASSIFIED BORROW AND 12 S.Y. SOLID SLAB SODDING

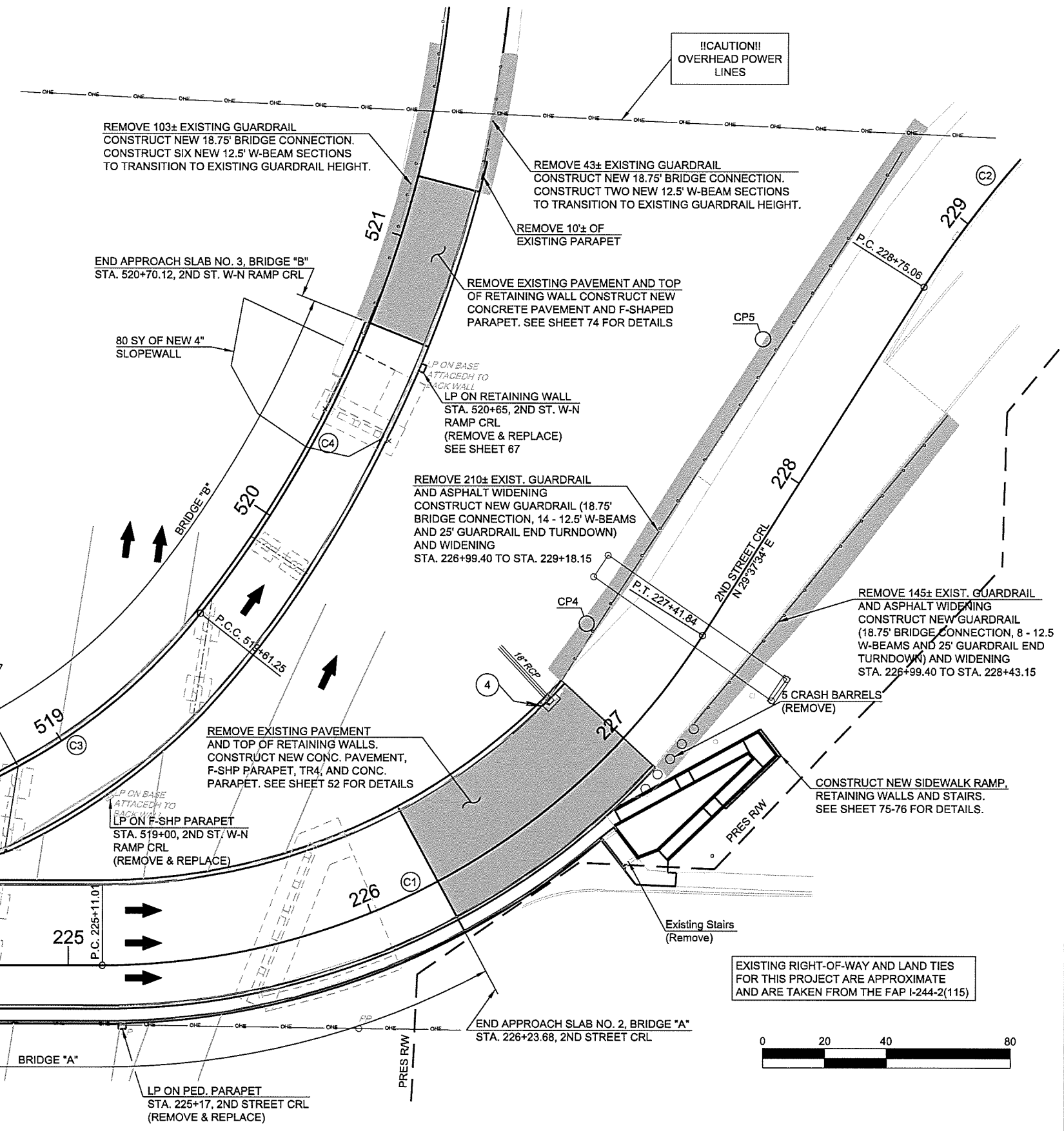

SEC. 1 T-19-N, R-12-E

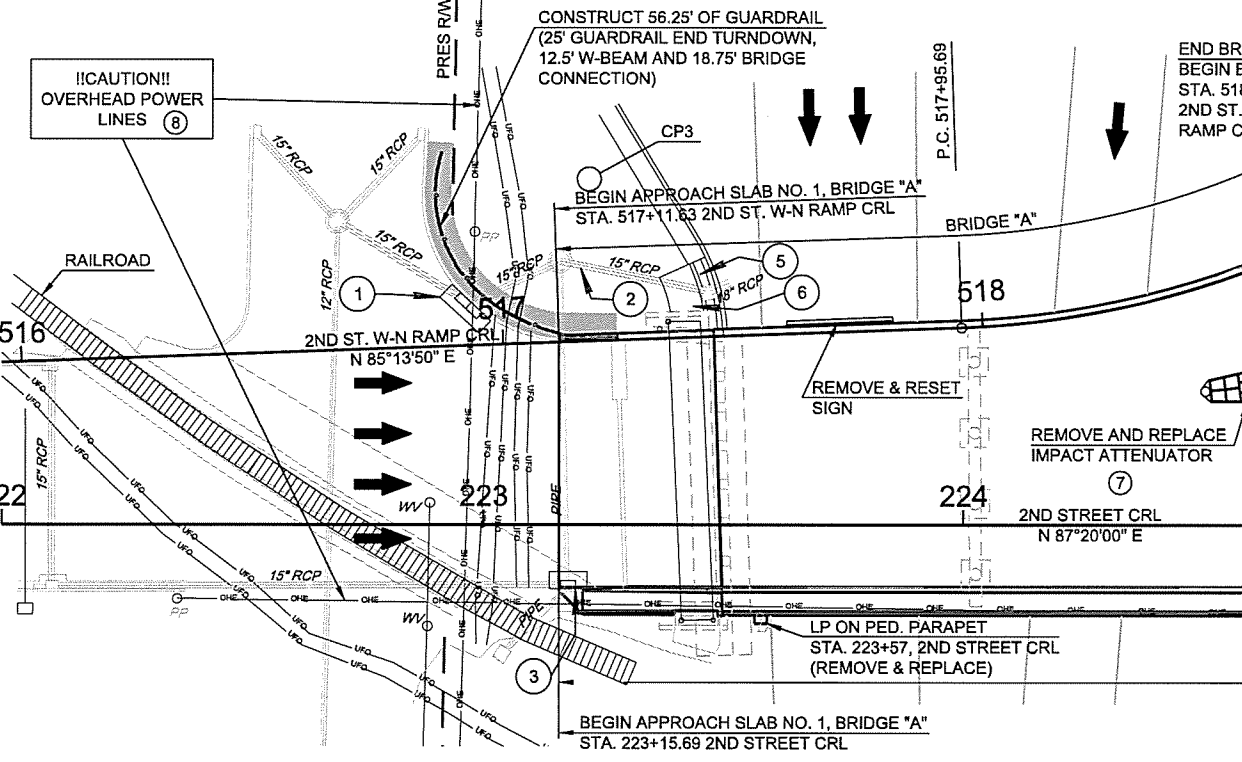

- IMPACT ATTENUATOR SHALL BE TRINITY ENERGY ABSORPTION SYSTEMS QUADGUARD ELITE MODEL NO QS9008E (5 BAY) OR APPROVED EQUAL.
- POWER LINES SHALL REMAIN IN PLACE AND THE CONTRACTOR SHALL TAKE EXTRA CARE TO WORK AROUND THE EXISTING POWER LINES.

EXISTING RIGHT-OF-WAY AND LAND TIES FOR THIS PROJECT ARE APPROXIMATE AND ARE TAKEN FROM THE FAP I-244-2(115)

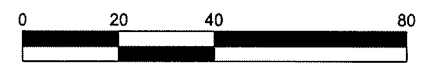

DESIGN	JSH	1-16	OKLAHOMA DEPARTMENT OF TRANSPORTATION ROADWAY PLAN STATE JOB NO. 28865(04) SHEET NO. 12 TULSA CO. 2ND STREET
DRAWN	MRM	1-16	
CHECKED	LWN	3-16	
APPROVED			
SQUAD	TT		

N:\11399\200-11399-13001-05\CAD\SheetFiles\JP 28865 (04) -12-RD -Plan.dgn 6/6/2016