

STATIONING BASED ON "AS-BUILT" PLANS  
FEDERAL AID PROJECT NO. I-244-2(115)096

STATE OF OKLAHOMA  
DEPARTMENT OF TRANSPORTATION

PLAN OF PROPOSED  
**INTERSTATE HIGHWAY**

PROJECT NO. ACNHPP1-4440-(002)SS  
BRIDGE REHABILITATION  
2<sup>ND</sup> STREET OVER I-444 AND  
2<sup>ND</sup> STREET W-N RAMP OVER I-444

**TULSA COUNTY**

CONTROL SECTION NO. 11-72-90  
STATE JOB NO. JP 28865(04)

BRIDGE "A" NBI NO. 18097, STRUCTURE NO. 7292 0106 X  
BRIDGE "B" NBI NO. 29155, STRUCTURE NO. 7292 0107 XR

**MANDATORY TIE**  
THIS PROJECT SHALL BE MANDATORILY  
TIED WITH TULSA COUNTY JOB PIECES:  
28880(04), 28879(04), 28868(04) AND  
SHALL BE BID ACCORDINGLY.

FOR INDEX OF SHEETS AND  
STANDARDS SEE SHEET 2

**DESIGN DATA**

ADT 2016	=	5,200
ADT 2036	=	7,700
T (% ADT)	=	5%
V	=	30MPH
20 YR FLEX ESALS	=	3.4M

**SCALES**

PLAN 1" = 50'  
PROFILE HOR. 1" = 50'  
VER. 1" = 5'  
LAYOUT MAP 1" = 5,280'

- CONVENTIONAL SYMBOLS**
- +—+— PROPOSED ROAD
  - +—+— RAILROADS
  - RANGE & TOWNSHIP
  - SECTION LINES
  - QUARTER SECTION LINES
  - x- FENCES
  - - - GROUND LINE
  - == == EXISTING ROADS
  - +—+— BASE LINE
  - +—+— GRADE LINES
  - +—+— TELEPHONE & TELEGRAPH
  - +—+— POWER LINES
  - +—+— BUILDINGS
  - +—+— OILWELL
  - +—+— DRAINAGE STRUCTURES - IN PLACE
  - +—+— DRAINAGE STRUCTURES - NEW
  - +—+— RIGHT-OF-WAY LINES - EXISTING
  - +—+— RIGHT-OF-WAY LINES - NEW
  - +—+— CONTROLLED ACCESS
  - +—+— RIGHT-OF-WAY FENCE

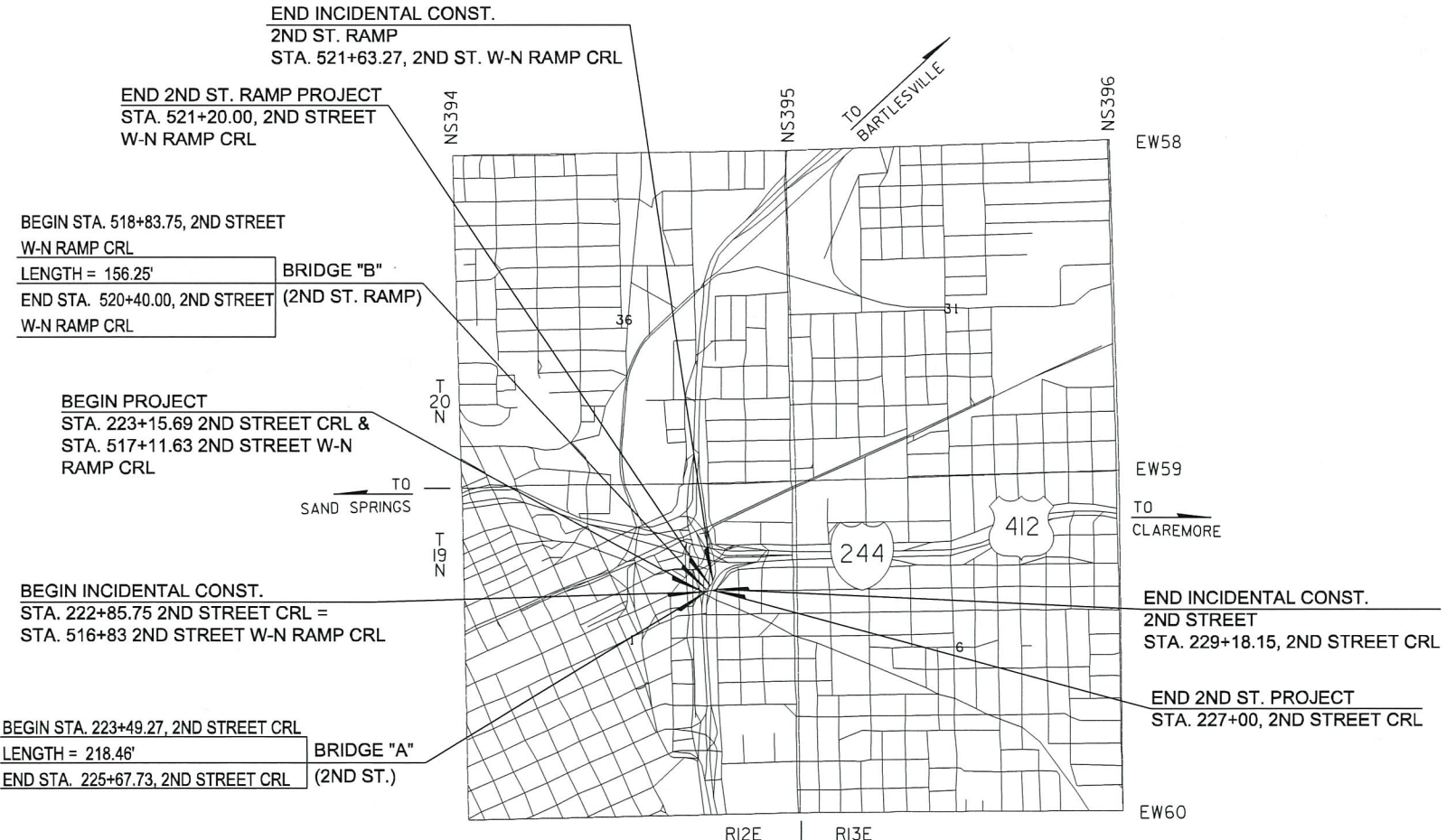
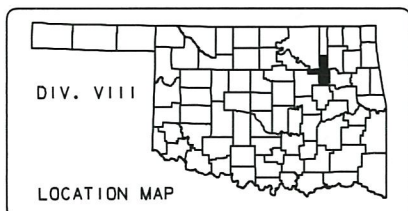

NOTE: PROJECT LENGTH BASED ON 2ND STREET AND 2ND ST. W-N RAMP CRL STATIONING

ROADWAY LENGTH ----- 245.85 FT. 0.047 MI.  
BRIDGE LENGTH ----- 374.71 FT. 0.071 MI.  
PROJECT LENGTH ----- 0.118 MI.

EQUATIONS : NONE  
EXCEPTIONS : NONE

2009 OKLAHOMA STANDARD SPECIFICATIONS FOR HIGHWAY CONSTRUCTION GOVERN, APPROVED BY  
THE U.S. DEPARTMENT OF TRANSPORTATION, FEDERAL HIGHWAY ADMINISTRATION, JANUARY 4, 2010.

**TETRA TECH**

PREPARED BY:  
TETRA TECH  
FOR THE OKLAHOMA  
DEPARTMENT OF TRANSPORTATION

CA 2388  
(EXP. 06-30-17)

John W. Barker  
16541

DATE  
JOHN W. BARKER, P.E.  
OKLA. REG. NO. 16541

REGISTERED PROFESSIONAL ENGINEER

OKLAHOMA  
DEPARTMENT OF TRANSPORTATION

DATE APPROVED \_\_\_\_\_

BY \_\_\_\_\_

CHIEF ENGINEER

DEPARTMENT OF TRANSPORTATION  
FEDERAL HIGHWAY ADMINISTRATION

DATE APPROVED \_\_\_\_\_

BY \_\_\_\_\_

DIVISION ADMINISTRATOR

PROJECT NO. ACNHPP1-4440(002)SS SHEET NO. 1