

DESCRIPTION	REVISIONS	DATE

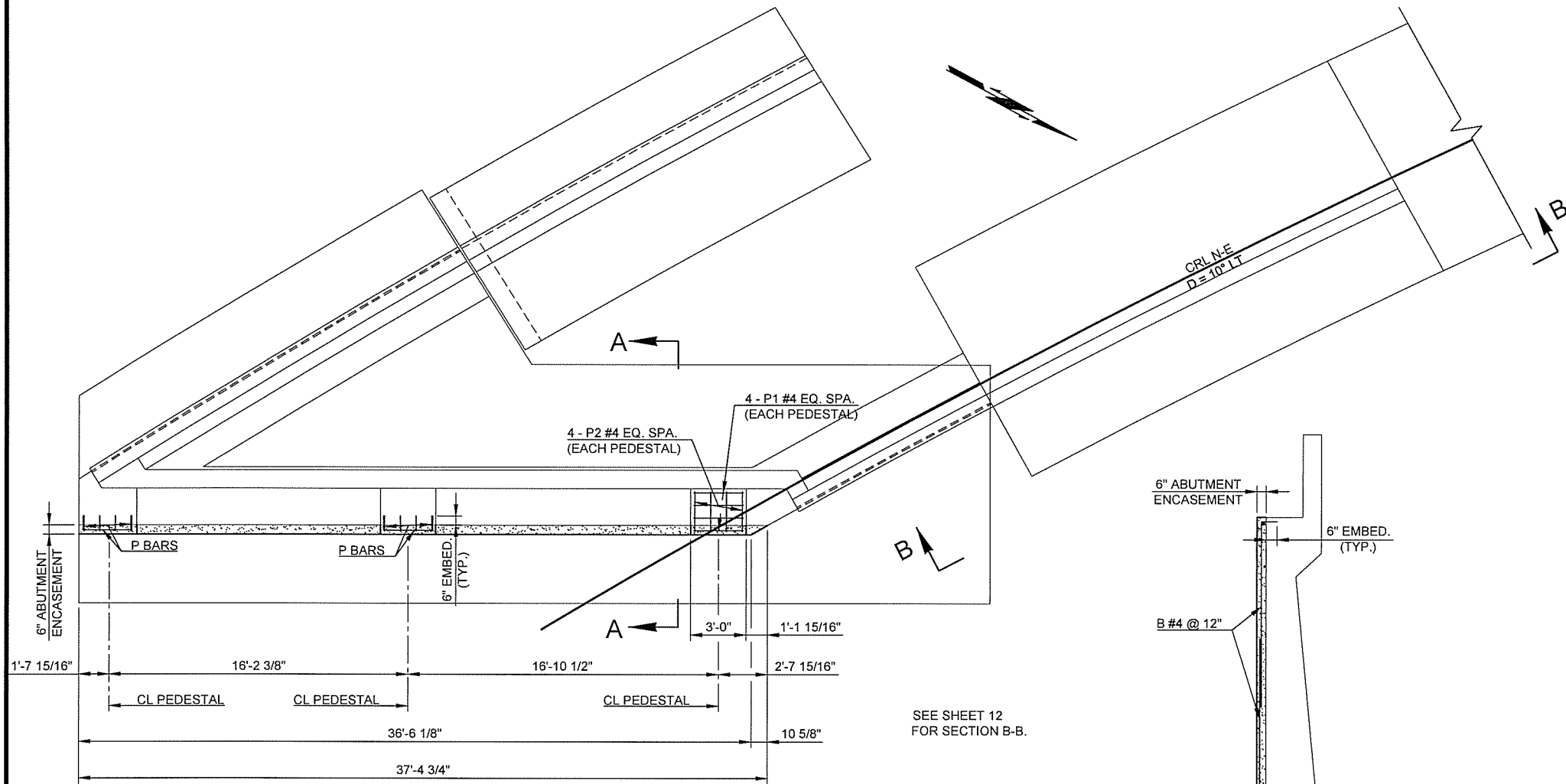

ABUTMENT NO. 1 PLAN

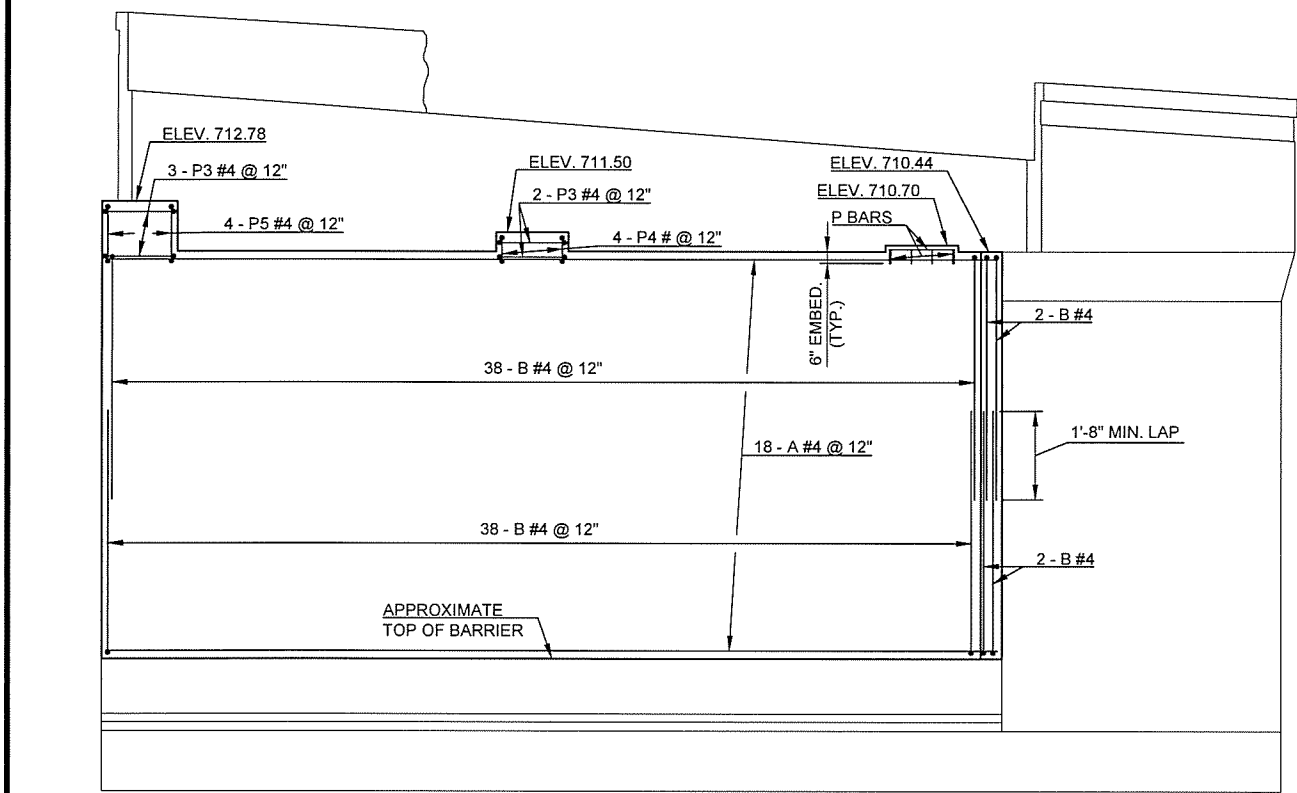

ABUTMENT NO. 1 ELEVATION

NOTE:
 BEFORE ENCASING THE EXISTING ABUTMENT WITH NEW CONCRETE, THE CONTRACTOR SHALL REMOVE ALL UNSOUND CONCRETE FROM THE ABUTMENT. AFTER REMOVAL OF UNSOUND CONCRETE, EXPOSED REINFORCING STEEL SHALL BE CLEANED, AND CORROSION INHIBITOR SHALL BE APPLIED TO EXISTING CONCRETE SURFACES AND ALLOWED TO DRY BEFORE ENCASING WITH NEW CONCRETE. ONLY THE SURFACES TO BE ENCASED SHALL BE TREATED WITH THE CORROSION INHIBITOR. ALL COST FOR THE REMOVAL OF UNSOUND CONCRETE AND CLEANING EXPOSED REBAR SHALL BE INCLUDED IN THE PRICE BID PER CUBIC YARD OF "CLASS A CONCRETE".

A SPECIAL CONCRETE FINISH SHALL BE APPLIED TO THE EXPOSED SURFACES OF THE ABUTMENTS AFTER ALL REPAIRS ARE COMPLETE.

ANCHORAGE SYSTEM:
 THE CONTRACTOR SHALL USE AN ANCHORAGE SYSTEM THAT HAS BEEN APPROVED BY ODOT'S MATERIALS DIVISION. FOR EMBEDMENT OF REINFORCING STEEL THE ANCHORAGE SYSTEM SHALL BE CAPABLE OF DEVELOPING THE FULL STRENGTH OF THE REINFORCING STEEL THAT IS TO BE ANCHORED. THE EMBEDMENT DEPTH SHOWN IS TO BE ADJUSTED TO MEET THE REQUIREMENTS. ANCHORAGE SHALL BE INSTALLED IN ACCORDANCE WITH THE MANUFACTURE'S SPECIFICATIONS FOR THE SYSTEM USED.
 ALL COSTS OF THE ANCHORAGE SYSTEM INCLUDING LABOR, MATERIALS, TOOLS, DRILLING, AND INCIDENTALS NECESSARY TO COMPLETE THE WORK SHOWN IN THE PLANS SHALL BE INCLUDED IN THE PRICE BID PER POUND OF "EPOXY COATED REINFORCING STEEL".

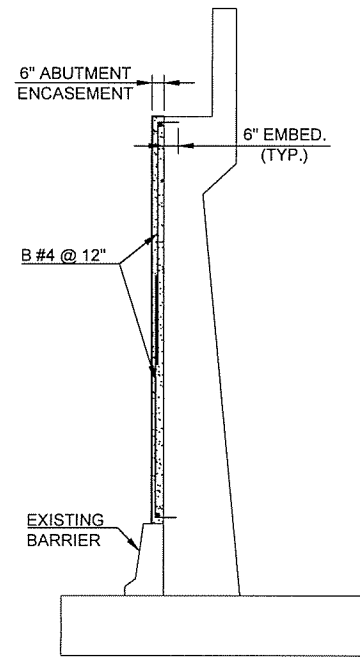

SECTION A-A

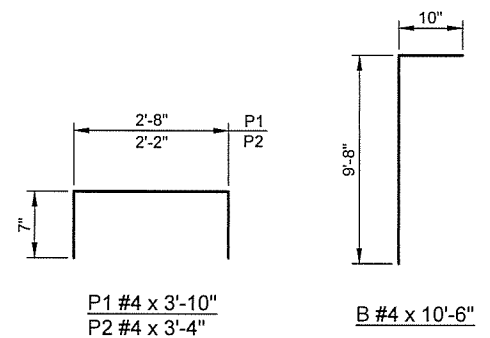

ABUTMENT NO. 1 ENCAPSULATION BAR LIST				
MARK	SIZE	NO.	FORM	LENGTH
EPOXY COATED REINFORCING				
A	#4	18	BNT	38'-4"
B	#4	80	BNT	10'-6"
P1	#4	12	BNT	3'-10"
P2	#4	12	BNT	3'-4"
P3	#4	5	BNT	4'-4"
P4	#4	4	BNT	2'-9"
P5	#4	4	BNT	3'-9"

① INCLUDES ONE MIN. LAP OF 1'-8"

ABUTMENT QUANTITIES				
ITEM	UNIT	ABUT. NO. 1	ABUT. NO. 2	TOTAL
SUBSTRUCTURE EXCAVATION COMMON	CY	50.0	160.0	210.0
CLSM BACKFILL	CY	40.0	140.0	180.0
SPECIAL CONCRETE FINISH	LSUM	1.0	1.0	1.0
CLASS A CONCRETE	CY	12.0	8.0	20.0
SLOPEWALL (4')	SY	0.0	3.0	3.0
EPOXY COATED REINFORCING STEEL	LB	1112.0	720.0	1832.0
WATER REPELLENT (VISUALLY INSPECTED)	SY	155.0	230.0	385.0
PREPARATION OF CRACKS, ABOVE WATER	LF	0.0	85.0	85.0
EPOXY RESIN, ABOVE WATER	GAL	0.0	2.0	2.0
PNEUMATICALLY PLACED MORTAR	SY	15.0	30.0	45.0
(SP) CORROSION INHIBITOR (SURFACE APPLIED)	SY	110.0	52.0	162.0
6" NON-PERF. PIPE UNDERDRAIN RND.	LF	3.0	3.0	6.0
6" PERFORATED PIPE UNDERDRAIN ROUND	LF	46.0	91.0	137.0

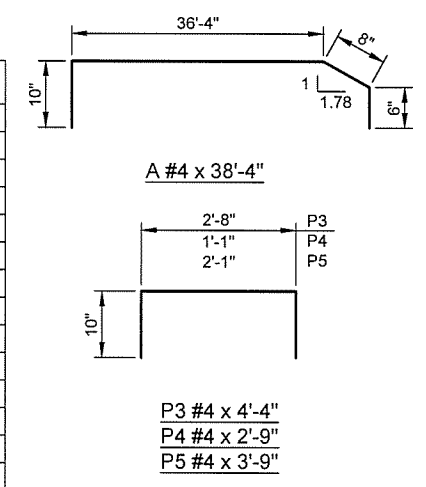

DESIGN	JSH	12/13	OKLAHOMA DEPARTMENT OF TRANSPORTATION BRIDGE A TULSA COUNTY
DRAWN	MRM	12/13	
CHECKED	JWB	3/16	
APPROVED			
SQUAD	TT		

SUBSTRUCTURE REPAIR DETAILS (SHEET 1 OF 4)

STATE JOB NO. 28880(04) SHEET NO. 10

3/21/2016 10:05:24 AM - MATETRA TECH11399 ODOTREC 1414FTASK ORDER 3\CAD\SHEETFILES\10 - SUBSTRU,REPAIR,1.DWG - MARQUART, MATT