

FED. ROAD DIST. NO.	STATE	JOB PIECE NO.	FISCAL YEAR	SHEET NO.	TOTAL SHEETS
6	OKLA.	21899(04)			

DESCRIPTION	REVISIONS	DATE

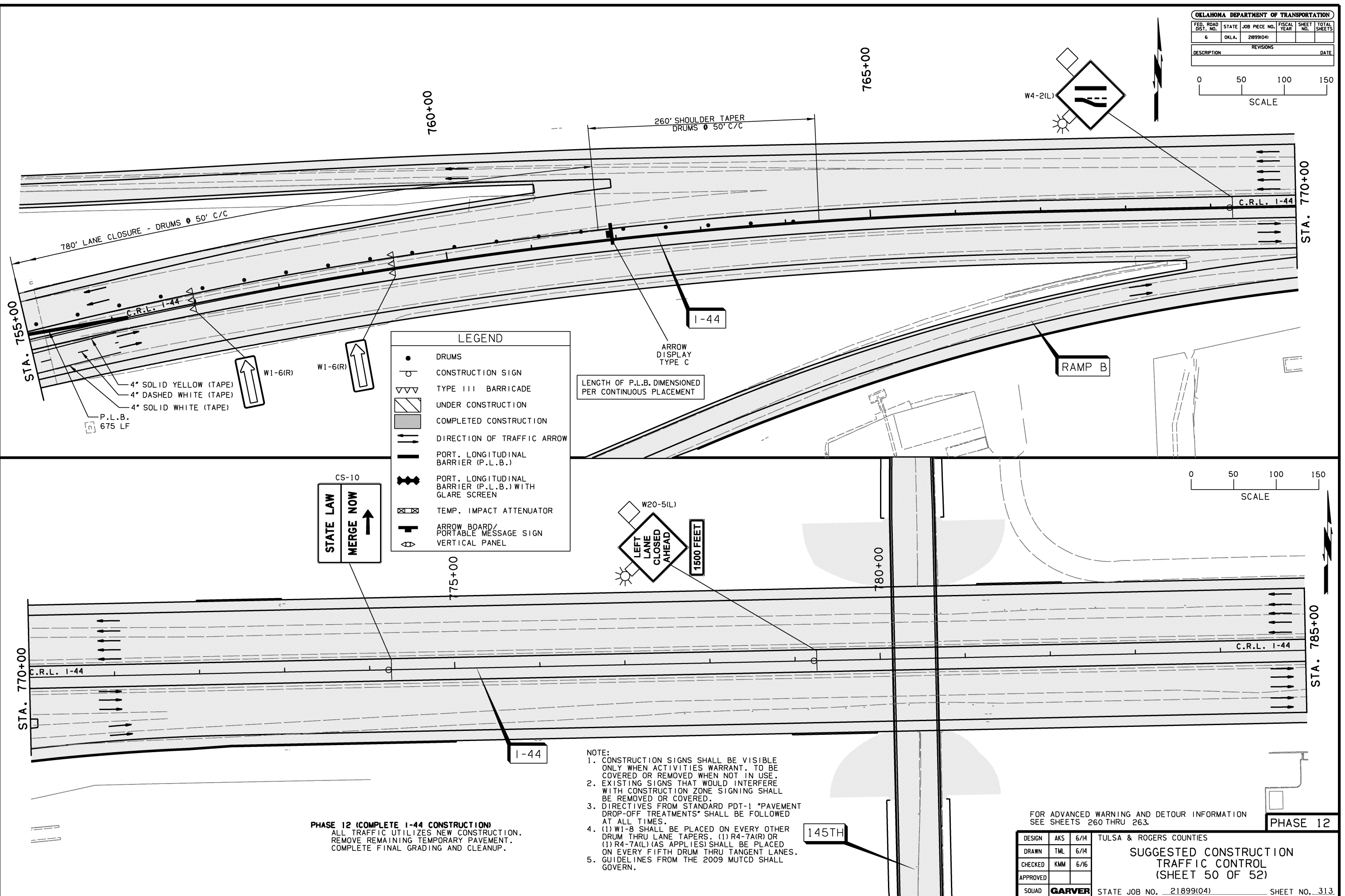
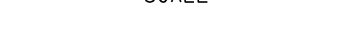

LEGEND

- DRUMS
- ⊕ CONSTRUCTION SIGN
- ▤ TYPE III BARRICADE
- ▨ UNDER CONSTRUCTION
- ▩ COMPLETED CONSTRUCTION
- DIRECTION OF TRAFFIC ARROW
- PORT. LONGITUDINAL BARRIER (P.L.B.)
- PORT. LONGITUDINAL BARRIER (P.L.B.) WITH GLARE SCREEN
- ⊠ TEMP. IMPACT ATTENUATOR
- ↑ ARROW BOARD/ PORTABLE MESSAGE SIGN VERTICAL PANEL

LENGTH OF P.L.B. DIMENSIONED PER CONTINUOUS PLACEMENT

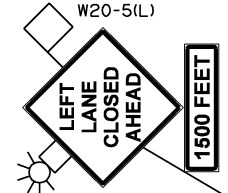
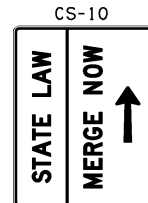

- NOTE:**
- CONSTRUCTION SIGNS SHALL BE VISIBLE ONLY WHEN ACTIVITIES WARRANT. TO BE COVERED OR REMOVED WHEN NOT IN USE.
 - EXISTING SIGNS THAT WOULD INTERFERE WITH CONSTRUCTION ZONE SIGNING SHALL BE REMOVED OR COVERED.
 - DIRECTIVES FROM STANDARD PDT-1 "PAVEMENT DROP-OFF TREATMENTS" SHALL BE FOLLOWED AT ALL TIMES.
 - (1) W1-8 SHALL BE PLACED ON EVERY OTHER DRUM THRU LANE TAPERS. (1) R4-7A(R) OR (1) R4-7A(L) (AS APPLIES) SHALL BE PLACED ON EVERY FIFTH DRUM THRU TANGENT LANES.
 - GUIDELINES FROM THE 2009 MUTCD SHALL GOVERN.

PHASE 12 (COMPLETE I-44 CONSTRUCTION)
 ALL TRAFFIC UTILIZES NEW CONSTRUCTION.
 REMOVE REMAINING TEMPORARY PAVEMENT.
 COMPLETE FINAL GRADING AND CLEANUP.

FOR ADVANCED WARNING AND DETOUR INFORMATION
 SEE SHEETS 260 THRU 263.

DESIGN	AKS	6/14
DRAWN	TML	6/14
CHECKED	KMM	6/16
APPROVED		
SQUAD	GARVER	

TULSA & ROGERS COUNTIES
SUGGESTED CONSTRUCTION TRAFFIC CONTROL
 (SHEET 50 OF 52)
 STATE JOB NO. 21899(04) SHEET NO. 313