

| LEGEND |   |
|--------|---|
| ●      | DRUMS   |
| ○      | CONSTRUCTION SIGN                                     |
| ▽▽▽    | TYPE III BARRICADE                                    |
| ▨      | UNDER CONSTRUCTION                                    |
| ■      | COMPLETED CONSTRUCTION                                |
| →      | DIRECTION OF TRAFFIC ARROW                            |
| —      | PORT. LONGITUDINAL BARRIER (P.L.B.)                   |
| —●—    | PORT. LONGITUDINAL BARRIER (P.L.B.) WITH GLARE SCREEN |
| ⊠      | TEMP. IMPACT ATTENUATOR                               |
| →      | ARROW BOARD/ PORTABLE MESSAGE SIGN                    |
| ⊕      | VERTICAL PANEL  |

LENGTH OF P.L.B. DIMENSIONED PER CONTINUOUS PLACEMENT

**PHASE 11B (CONTINUE I-44 CONSTRUCTION, EXISTING STRUCTURE REMOVAL)**  
 EASTBOUND I-44 TRAFFIC REMAINS UNDER NORMAL OPERATING CONDITIONS. SHIFT WESTBOUND I-44 TRAFFIC TO INSIDE LANES AND SHOULDER. SHIFT WESTBOUND OFF RAMP TO OUTSIDE SHOULDER AND LANE OF RAMP A. REMOVE TEMPORARY ASPHALT PAVEMENT PATCH AND THE REMAINING PORTION OF THE EXISTING CROSS STRUCTURES. ONCE STRUCTURE IS REMOVED, CONSTRUCT FINAL FULL DEPTH PAVING SECTION.

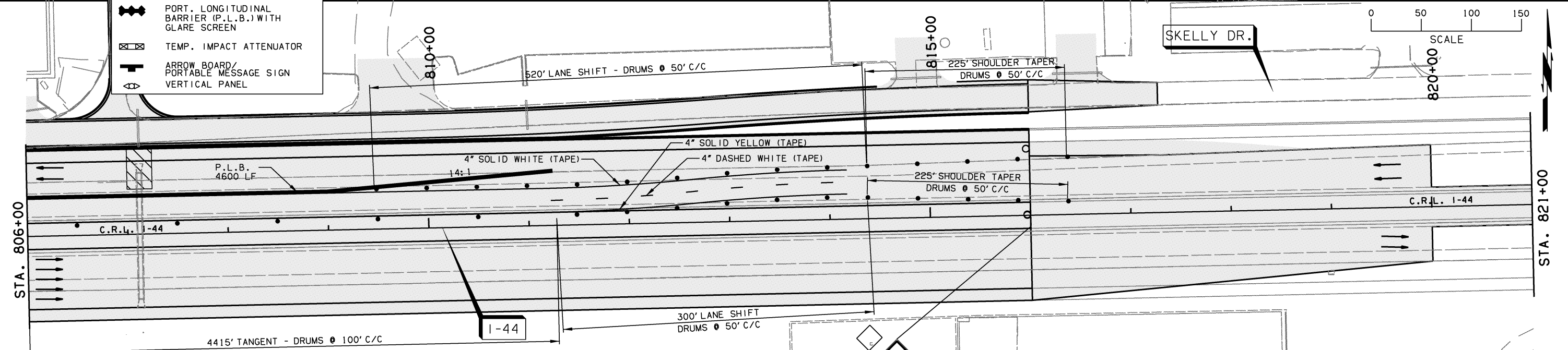

- NOTE:
- CONSTRUCTION SIGNS SHALL BE VISIBLE ONLY WHEN ACTIVITIES WARRANT. TO BE COVERED OR REMOVED WHEN NOT IN USE.
  - EXISTING SIGNS THAT WOULD INTERFERE WITH CONSTRUCTION ZONE SIGNING SHALL BE REMOVED OR COVERED.
  - DIRECTIVES FROM STANDARD PDT-1 "PAVEMENT DROP-OFF TREATMENTS" SHALL BE FOLLOWED AT ALL TIMES.
  - (1) W1-8 SHALL BE PLACED ON EVERY OTHER DRUM THRU LANE TAPERS. (1) R4-7A(R) OR (1) R4-7A(L) (AS APPLIES) SHALL BE PLACED ON EVERY FIFTH DRUM THRU TANGENT LANES.
  - GUIDELINES FROM THE 2009 MUTCD SHALL GOVERN.

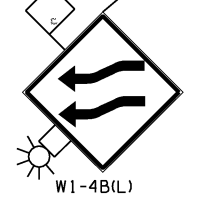

FOR ADVANCED WARNING AND DETOUR INFORMATION SEE SHEETS 260 THRU 263. **PHASE 11B**

|          |               |                         |   |
|----------|---------------|-------------------------|---|
| DESIGN   | AKS           | 6/14                    | TULSA & ROGERS COUNTIES                                 |
| DRAWN    | TML           | 6/14                    | SUGGESTED CONSTRUCTION TRAFFIC CONTROL (SHEET 48 OF 52) |
| CHECKED  | KMM           | 6/16                    |   |
| APPROVED |               |                         |   |
| SQUAD    | <b>GARVER</b> | STATE JOB NO. 21899(04) | SHEET NO. 311   |