

**LEGEND**

- DRUMS
- CONSTRUCTION SIGN
- ▽▽▽ TYPE III BARRICADE
- ▨ UNDER CONSTRUCTION
- ▩ COMPLETED CONSTRUCTION
- DIRECTION OF TRAFFIC ARROW
- PORT. LONGITUDINAL BARRIER (P.L.B.)
- ◆ PORT. LONGITUDINAL BARRIER (P.L.B.) WITH GLARE SCREEN
- ⊠ TEMP. IMPACT ATTENUATOR
- ⊞ ARROW BOARD/PORTABLE MESSAGE SIGN
- ⊞ VERTICAL PANEL

**NOTE:**

- CONSTRUCTION SIGNS SHALL BE VISIBLE ONLY WHEN ACTIVITIES WARRANT. TO BE COVERED OR REMOVED WHEN NOT IN USE.
- EXISTING SIGNS THAT WOULD INTERFERE WITH CONSTRUCTION ZONE SIGNING SHALL BE REMOVED OR COVERED.
- DIRECTIVES FROM STANDARD PDT-1 "PAVEMENT DROP-OFF TREATMENTS" SHALL BE FOLLOWED AT ALL TIMES.
- (1) W1-8 SHALL BE PLACED ON EVERY OTHER DRUM THRU LANE TAPERS. (1) R4-7A(R) OR (1) R4-7A(L) (AS APPLIES) SHALL BE PLACED ON EVERY FIFTH DRUM THRU TANGENT LANES.
- GUIDELINES FROM THE 2009 MUTCD SHALL GOVERN.

**PHASE 10 (CONTINUE I-44 CONSTRUCTION, EASTBOUND)**  
 I-44 TRAFFIC REMAINS ON NEWLY CONSTRUCTED WESTBOUND PAVEMENT. RELOCATE TEMPORARY EASTBOUND ON RAMP ONTO NEWLY CONSTRUCTED PAVEMENT. COMPLETE CONSTRUCTION OF PROPOSED EASTBOUND PAVEMENT AND PROPOSED CROSS STRUCTURES. COMPLETE CONSTRUCTION SOUTH HALF BRIDGE 'A'.

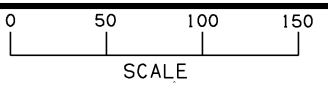
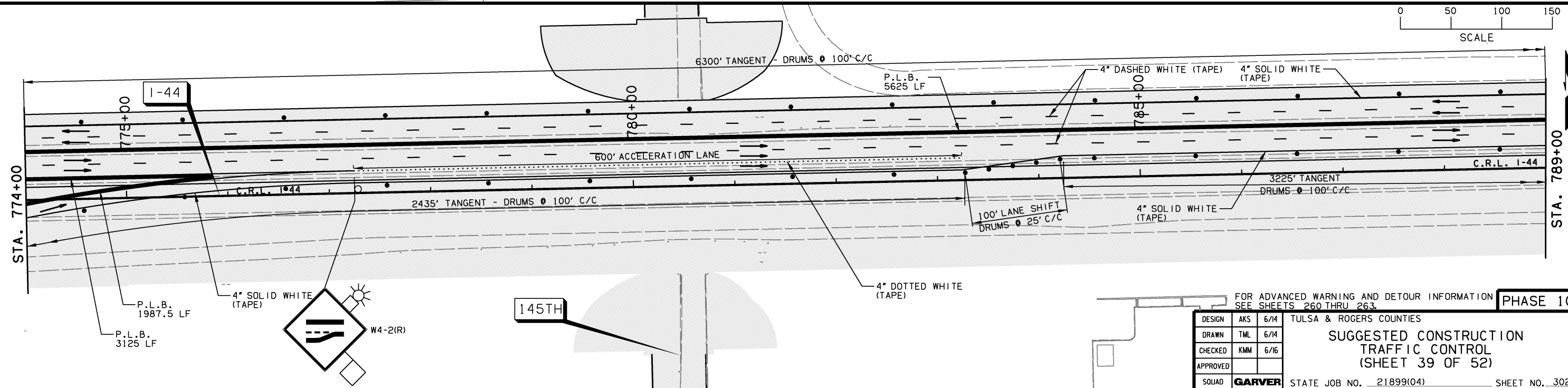

FOR ADVANCED WARNING AND DETOUR INFORMATION SEE SHEETS 260 THRU 263. **PHASE 10**

DESIGN	AKS	6/14	TULSA & ROGERS COUNTIES
DRAWN	TML	6/14	
CHECKED	KMM	6/16	
APPROVED			
SQUAD	<b>GARVER</b>		

**SUGGESTED CONSTRUCTION TRAFFIC CONTROL (SHEET 39 OF 52)**

STATE JOB NO. 21899(04) SHEET NO. 302