

OKLAHOMA DEPARTMENT OF TRANSPORTATION					
FED. ROAD DIST. NO.	STATE	JOB PIECE NO.	FISCAL YEAR	SHEET NO.	TOTAL SHEETS
6	OKLA.	21899(04)			
DESCRIPTION			REVISIONS	DATE	

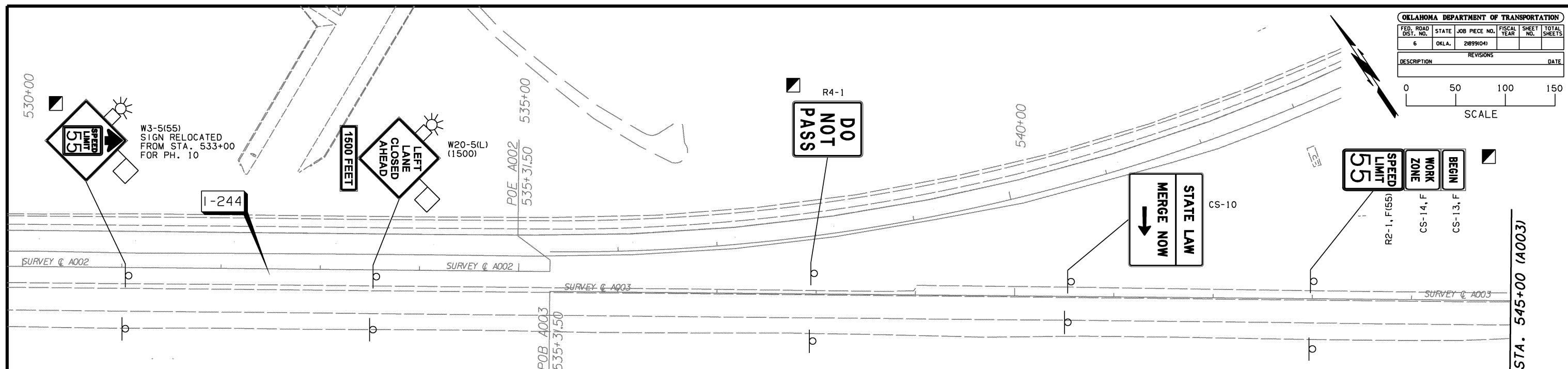
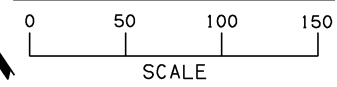

PHASE 10 (CONTINUE I-44 CONSTRUCTION, EASTBOUND)
 I-44 TRAFFIC REMAINS ON NEWLY CONSTRUCTED WESTBOUND PAVEMENT.
 RELOCATE TEMPORARY EASTBOUND ON RAMP ONTO NEWLY CONSTRUCTED PAVEMENT.
 COMPLETE CONSTRUCTION OF PROPOSED EASTBOUND PAVEMENT AND PROPOSED CROSS STRUCTURES.
 COMPLETE CONSTRUCTION SOUTH HALF BRIDGE 'A'.

LEGEND	
	DRUMS
	CONSTRUCTION SIGN
	TYPE III BARRICADE
	UNDER CONSTRUCTION
	COMPLETED CONSTRUCTION
	DIRECTION OF TRAFFIC ARROW
	PORT. LONGITUDINAL BARRIER (P.L.B.)
	PORT. LONGITUDINAL BARRIER (P.L.B.) WITH GLARE SCREEN
	TEMP. IMPACT ATTENUATOR
	ARROW BOARD/PORTABLE MESSAGE SIGN
	VERTICAL PANEL

LENGTH OF P.L.B. DIMENSIONED PER CONTINUOUS PLACEMENT

SIGN ASSEMBLY INCLUDED IN ADVANCED WARNING

FOR PHASE 10 TRAFFIC CONTROL INFORMATION FOR C.R.L. I-44 SEE SHEET 301

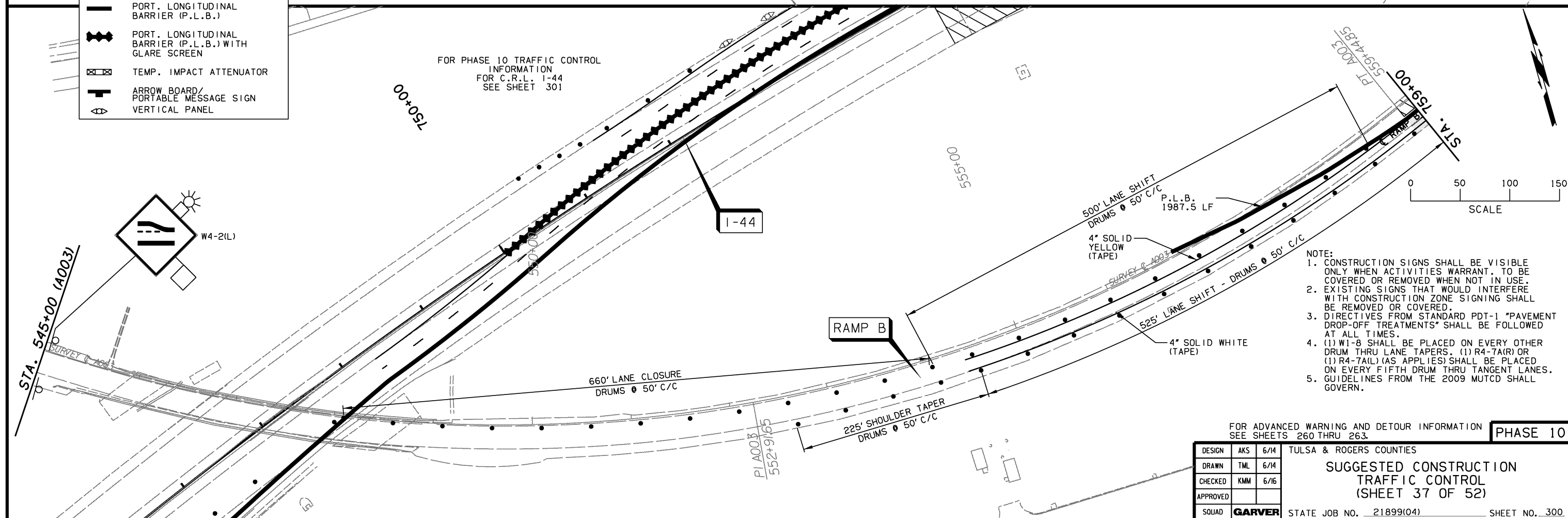

- NOTE:
- CONSTRUCTION SIGNS SHALL BE VISIBLE ONLY WHEN ACTIVITIES WARRANT. TO BE COVERED OR REMOVED WHEN NOT IN USE.
 - EXISTING SIGNS THAT WOULD INTERFERE WITH CONSTRUCTION ZONE SIGNING SHALL BE REMOVED OR COVERED.
 - DIRECTIVES FROM STANDARD PDT-1 "PAVEMENT DROP-OFF TREATMENTS" SHALL BE FOLLOWED AT ALL TIMES.
 - (1) W1-8 SHALL BE PLACED ON EVERY OTHER DRUM THRU LANE TAPERS. (1) R4-7A(R) OR (1) R4-7A(L) (AS APPL IES) SHALL BE PLACED ON EVERY FIFTH DRUM THRU TANGENT LANES.
 - GUIDELINES FROM THE 2009 MUTCD SHALL GOVERN.

FOR ADVANCED WARNING AND DETOUR INFORMATION SEE SHEETS 260 THRU 263.

PHASE 10

DESIGN	AKS	6/14
DRAWN	TML	6/14
CHECKED	KMM	6/16
APPROVED		
SQUAD	GARVER	

TULSA & ROGERS COUNTIES
SUGGESTED CONSTRUCTION TRAFFIC CONTROL
 (SHEET 37 OF 52)
 STATE JOB NO. 21899(04) SHEET NO. 300