

PHASE 6 (STAGE 1 AND 2 BEGIN I-44 CONSTRUCTION, TEMPORARY PAVEMENT)
 SHIFT I-44 TRAFFIC ONTO OUTSIDE SHOULDERS TO CONSTRUCT TEMPORARY PAVEMENT THROUGH THE EXISTING MEDIANS FOR CROSSOVERS AND RAMP ACCESS IN FOLLOWING PHASES.
 ONCE TEMPORARY PAVING WITHIN THE MEDIAN IS COMPLETE, SHIFT I-44 TRAFFIC TOWARD THE INSIDE SHOULDER TO CONSTRUCT THE REMAINING TEMPORARY PAVEMENT WIDENINGS AND SHOULDER STRENGTHENING.

LENGTH OF P.L.B. DIMENSIONED PER CONTINUOUS PLACEMENT

| LEGEND | |
|--------|---|
| | DRUMS |
| | CONSTRUCTION SIGN |
| | TYPE III BARRICADE |
| | UNDER CONSTRUCTION |
| | COMPLETED CONSTRUCTION |
| | DIRECTION OF TRAFFIC ARROW |
| | PORT. LONGITUDINAL BARRIER (P.L.B.) |
| | PORT. LONGITUDINAL BARRIER (P.L.B.) WITH GLARE SCREEN |
| | TEMP. IMPACT ATTENUATOR |
| | ARROW BOARD/PORTABLE MESSAGE SIGN |
| | VERTICAL PANEL |

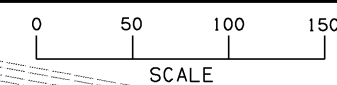

FOR ADVANCED WARNING AND DETOUR INFORMATION SEE SHEETS 260 THRU 263.

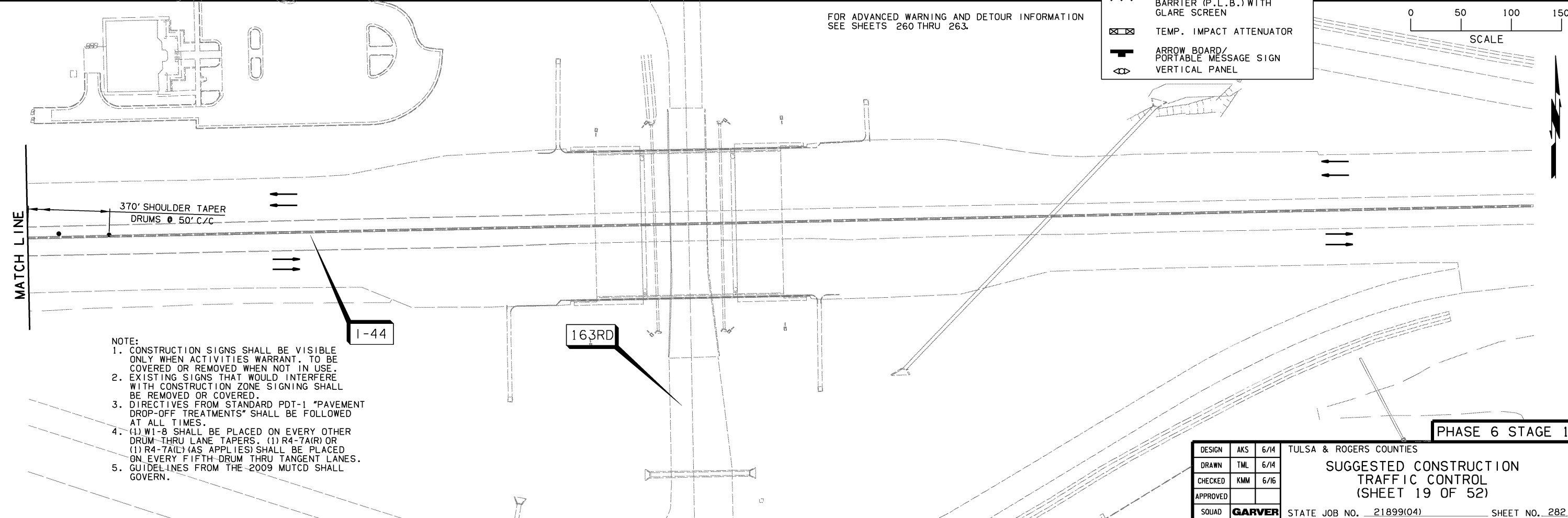

- NOTE:
- CONSTRUCTION SIGNS SHALL BE VISIBLE ONLY WHEN ACTIVITIES WARRANT. TO BE COVERED OR REMOVED WHEN NOT IN USE.
 - EXISTING SIGNS THAT WOULD INTERFERE WITH CONSTRUCTION ZONE SIGNING SHALL BE REMOVED OR COVERED.
 - DIRECTIVES FROM STANDARD PDT-1 "PAVEMENT DROP-OFF TREATMENTS" SHALL BE FOLLOWED AT ALL TIMES.
 - (1) W1-8 SHALL BE PLACED ON EVERY OTHER DRUM THRU LANE TAPERS, (1) R4-7A(R) OR (1) R4-7A(L) (AS APPLIES) SHALL BE PLACED ON EVERY FIFTH DRUM THRU TANGENT LANES.
 - GUIDELINES FROM THE 2009 MUTCD SHALL GOVERN.

| | | |
|----------|---------------|------|
| DESIGN | AKS | 6/14 |
| DRAWN | TML | 6/14 |
| CHECKED | KMM | 6/16 |
| APPROVED | | |
| SQUAD | GARVER | |

TULSA & ROGERS COUNTIES
SUGGESTED CONSTRUCTION TRAFFIC CONTROL
 (SHEET 19 OF 52)
 STATE JOB NO. 21899(04) SHEET NO. 282