

OKLAHOMA DEPARTMENT OF TRANSPORTATION					
FED. ROAD DIST. NO.	STATE	JOB PIECE NO.	FISCAL YEAR	SHEET NO.	TOTAL SHEETS
6	OKLA.	21899(04)			
DESCRIPTION			REVISIONS		DATE

LEGEND

- PHASE 9
- PHASE 10
- COMPLETED CONSTRUCTION

0 100 200 300
SCALE

LEGEND

- TEMPORARY WIDENING
- MAINLINE
- EXISTING GROUND
- PORTABLE LONGITUDINAL BARRIER (P.L.B.)

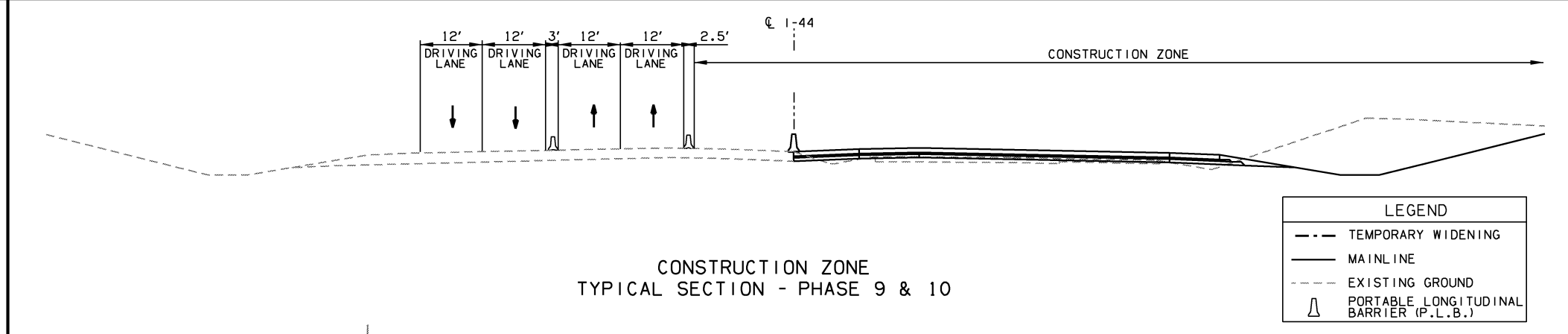

CONSTRUCTION ZONE
TYPICAL SECTION - PHASE 9 & 10

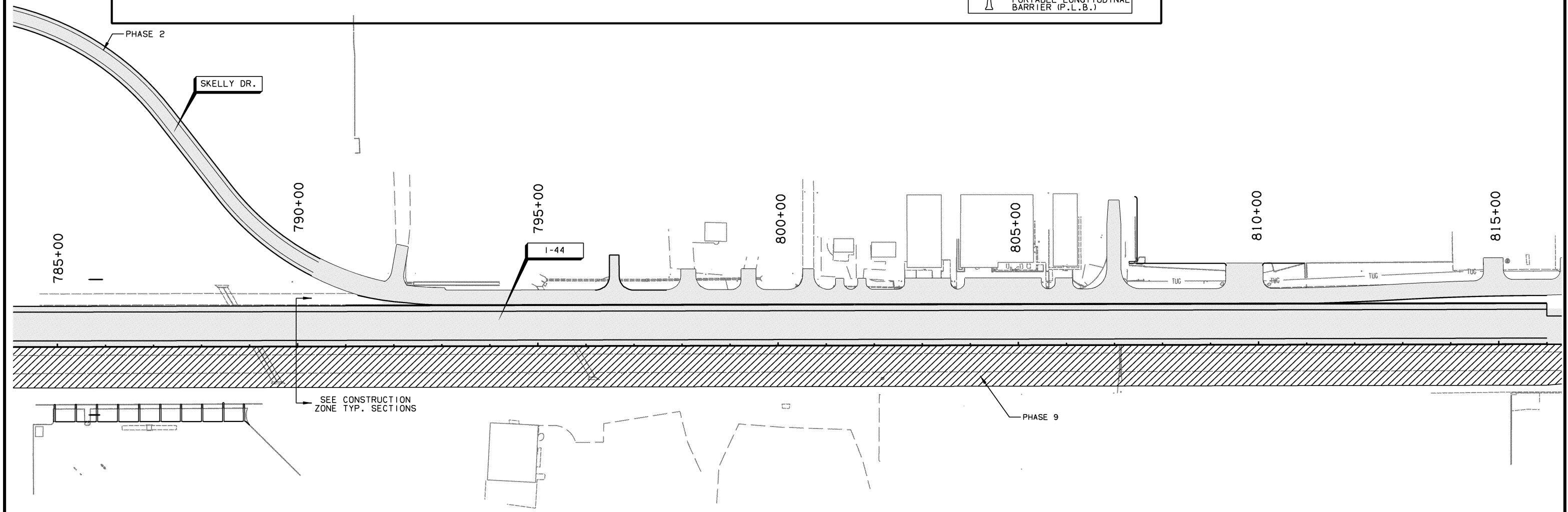

PHASE 9 (CONTINUE I-44 CONSTRUCTION, EASTBOUND)
 SHIFT ALL I-44 TRAFFIC TO THE NEWLY CONSTRUCTED WESTBOUND PAVEMENT.
 BEGIN CONSTRUCTION OF PROPOSED EASTBOUND AND RAMP B PAVEMENT.
 CONSTRUCT SOUTH PORTION OF PROPOSED CROSS STRUCTURES.
 COMPLETE CONSTRUCTION OF BRIDGE A.

PHASE 10 (CONTINUE I-44 CONSTRUCTION, EASTBOUND)
 I-44 TRAFFIC REMAINS ON NEWLY CONSTRUCTED WESTBOUND PAVEMENT.
 RELOCATE TEMPORARY EASTBOUND ON RAMP ONTO NEWLY CONSTRUCTED PAVEMENT.
 COMPLETE CONSTRUCTION OF PROPOSED EASTBOUND PAVEMENT AND PROPOSED CROSS STRUCTURES.
 COMPLETE CONSTRUCTION SOUTH HALF BRIDGE 'A'.

PHASE 9 & 10

DESIGN	AKS	6/14	TULSA & ROGERS COUNTIES
DRAWN	TML	6/14	
CHECKED	KMM	6/16	
APPROVED			
SQUAD	GARVER		

SUGGESTED CONSTRUCTION SEQUENCE OVERVIEW (SHEET 11 OF 14)

STATE JOB NO. 21899(04) SHEET NO. 256