

OKLAHOMA DEPARTMENT OF TRANSPORTATION						
FED. ROAD DIST. NO.	STATE	JOB PIECE NO.	FISCAL YEAR	SHEET NO.	TOTAL SHEETS	
6	OKLA.	21899(04)				
DESCRIPTION		REVISIONS	DATE			

**PHASE 7 (CONTINUE I-44 CONSTRUCTION, WESTBOUND)**  
 SHIFT ALL I-44 TRAFFIC TO EXISTING EASTBOUND LANES AND NORTH PORTION TEMPORARY WIDENING.  
 BEGIN CONSTRUCTION OF PROPOSED WESTBOUND (STA. 767+00 TO STA. 820+00) AND RAMP A PAVEMENT.  
 BEGIN MAJOR CONSTRUCTION NORTH HALF OF BRIDGE 'A'.  
 CONSTRUCT NORTH PORTION OF PROPOSED CROSS STRUCTURES, EXISTING TO REMAIN UNTIL PROPOSED ARE COMPLETE.  
 CONSTRUCT TEMPORARY ASPHALT TO FACILITATE THE REMOVAL OF EXISTING CROSSING STRUCTURES IN A LATER PHASE.  
 761+50 TO 762+40, 788+25 TO 789+30, 795+00 TO 796+00, 807+00 TO 807+25  
 BEGIN CONSTRUCTION OF BRIDGE A INCLUDING CENTER PIER AND NORTH SPAN.

**PHASE 8 (CONTINUE I-44 CONSTRUCTION, WESTBOUND)**  
 I-44 TRAFFIC REMAINS ON EXISTING EASTBOUND LANES AND TEMPORARY WIDENING.  
 RELOCATE TEMPORARY WESTBOUND OFF RAMP A ONTO NEWLY CONSTRUCTED PAVEMENT.  
 COMPLETE CONSTRUCTION OF PROPOSED WESTBOUND PAVEMENT AND RAMP A.  
 COMPLETE CONSTRUCTION OF NORTH HALF BRIDGE 'A'.

**LEGEND**

- PHASE 7
- PHASE 8
- COMPLETED CONSTRUCTION

0 100 200 300  
SCALE

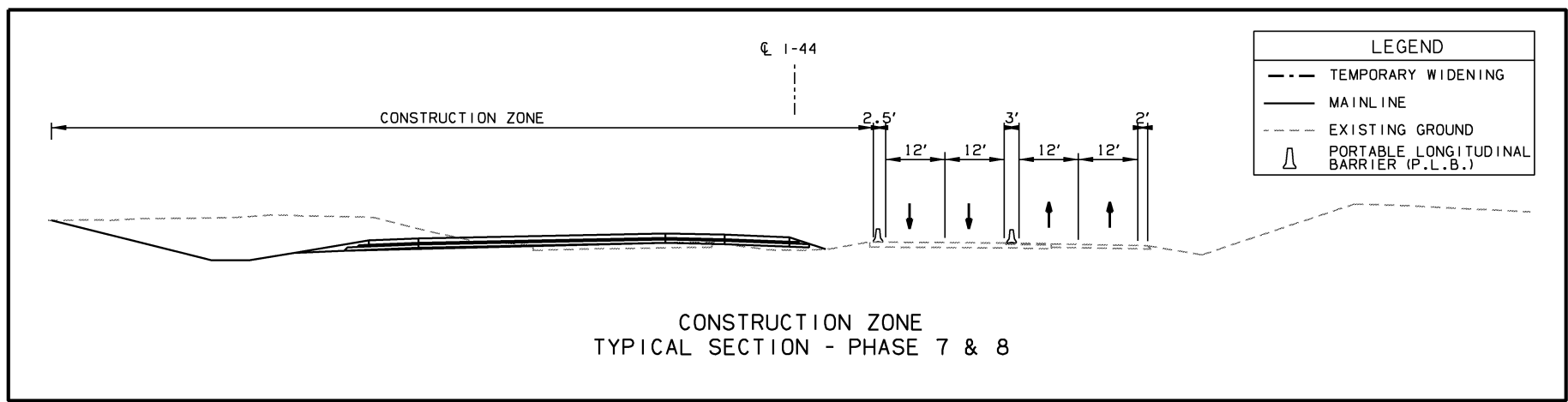
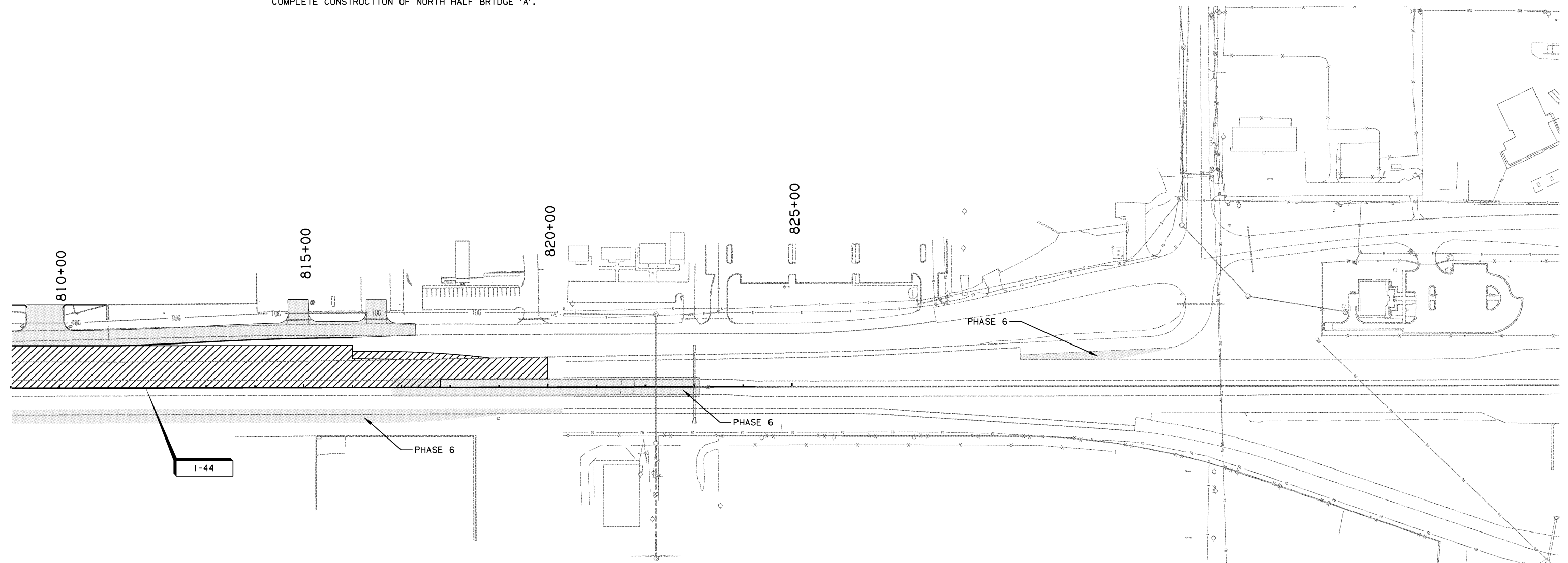

DESIGN	AKS	6/14	TULSA & ROGERS COUNTIES
DRAWN	TML	6/14	<b>SUGGESTED CONSTRUCTION SEQUENCE OVERVIEW (SHEET 9 OF 14)</b>
CHECKED	KMM	6/16	
APPROVED			
SQUAD	<b>GARVER</b>	STATE JOB NO. 21899(04)	SHEET NO. 254