

OKLAHOMA DEPARTMENT OF TRANSPORTATION						
FED. ROAD DIST. NO.	STATE	JOB PIECE NO.	FISCAL YEAR	SHEET NO.	TOTAL SHEETS	
6	OKLA.	21899(04)				
DESCRIPTION			REVISIONS	DATE		

PHASE 7 (CONTINUE I-44 CONSTRUCTION, WESTBOUND)
 SHIFT ALL I-44 TRAFFIC TO EXISTING EASTBOUND LANES AND NORTH PORTION TEMPORARY WIDENING.
 BEGIN CONSTRUCTION OF PROPOSED WESTBOUND (STA. 767+00 TO STA. 820+00) AND RAMP A PAVEMENT.
 BEGIN MAJOR CONSTRUCTION NORTH HALF OF BRIDGE 'A'.
 CONSTRUCT NORTH PORTION OF PROPOSED CROSS STRUCTURES. EXISTING TO REMAIN UNTIL PROPOSED ARE COMPLETE.
 CONSTRUCT TEMPORARY ASPHALT TO FACILITATE THE REMOVAL OF EXISTING CROSSING STRUCTURES IN A LATER PHASE.
 761+50 TO 762+40, 788+25 TO 789+30, 795+00 TO 796+00, 807+00 TO 807+25
 BEGIN CONSTRUCTION OF BRIDGE A INCLUDING CENTER PIER AND NORTH SPAN.

PHASE 8 (CONTINUE I-44 CONSTRUCTION, WESTBOUND)
 I-44 TRAFFIC REMAINS ON EXISTING EASTBOUND LANES AND TEMPORARY WIDENING.
 RELOCATE TEMPORARY WESTBOUND OFF RAMP A ONTO NEWLY CONSTRUCTED PAVEMENT.
 COMPLETE CONSTRUCTION OF PROPOSED WESTBOUND PAVEMENT AND RAMP A.
 COMPLETE CONSTRUCTION OF NORTH HALF BRIDGE 'A'.

LEGEND

- PHASE 7
- PHASE 8
- COMPLETED CONSTRUCTION

0 100 200 300
SCALE

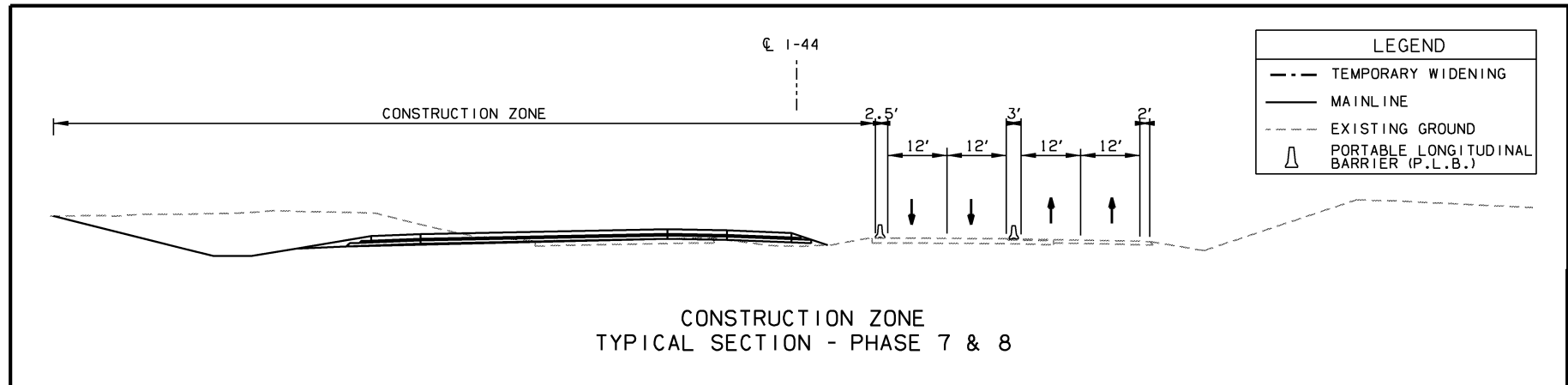
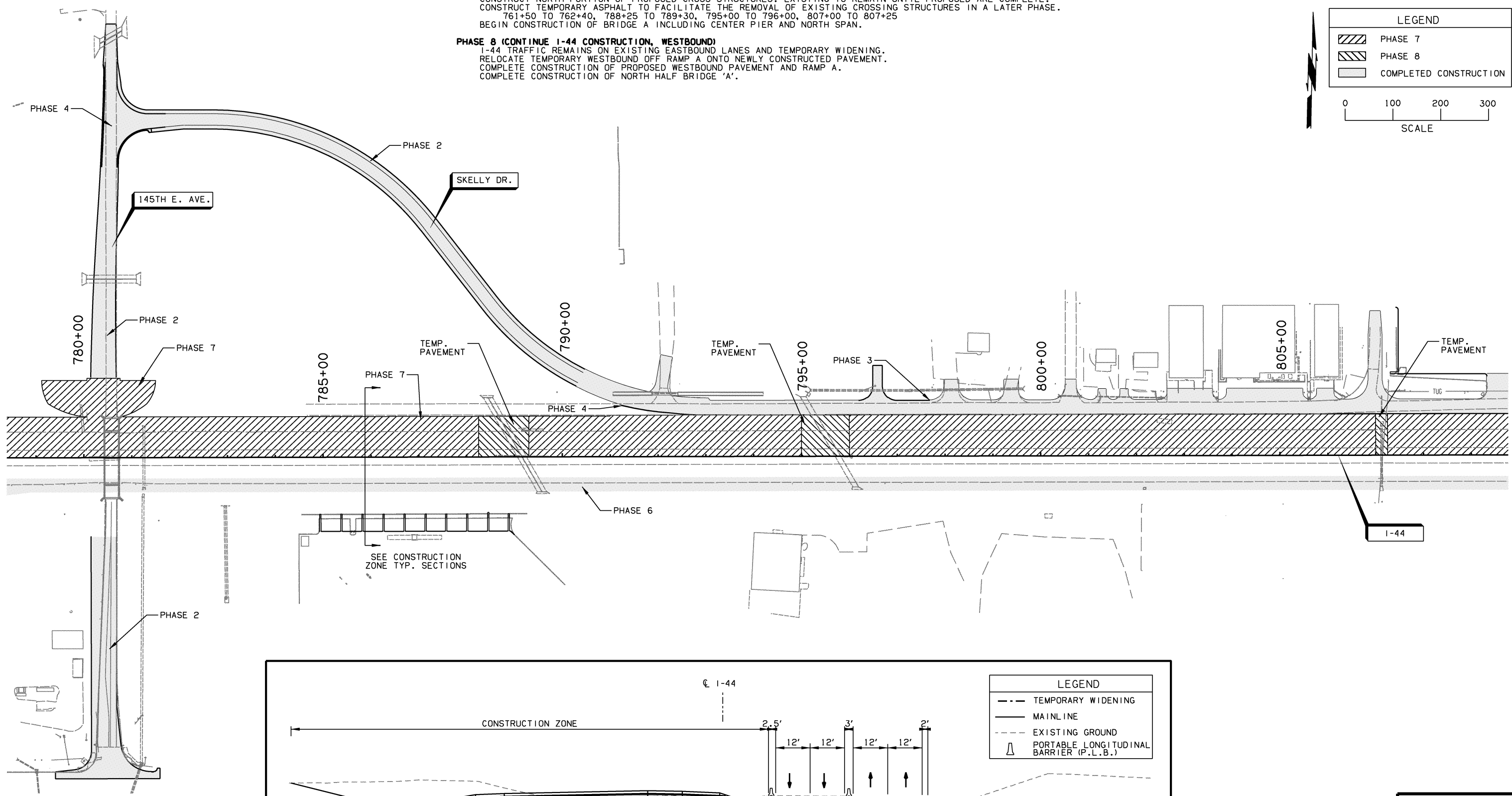

			PHASE 7 & 8	
DESIGN	AKS	6/14	TULSA & ROGERS COUNTIES	
DRAWN	TML	6/14	SUGGESTED CONSTRUCTION SEQUENCE OVERVIEW (SHEET 8 OF 14)	
CHECKED	KMM	6/16		
APPROVED				
SQUAD	GARVER	STATE JOB NO. 21899(04)	SHEET NO. 253	