

OKLAHOMA DEPARTMENT OF TRANSPORTATION						
FED. ROAD DIST. NO.	STATE	JOB PIECE NO.	FISCAL YEAR	SHEET NO.	TOTAL SHEETS	
6	OKLA.	21899(04)				
DESCRIPTION		REVISIONS			DATE	

LEGEND	
---	TEMPORARY WIDENING
—	MAINLINE
- - -	EXISTING GROUND
▲	PORTABLE LONGITUDINAL BARRIER (P.L.B.)

LEGEND	
[Cross-hatched]	PHASE 1A
[Diagonal lines]	PHASE 1B
[Horizontal lines]	PHASE 1C

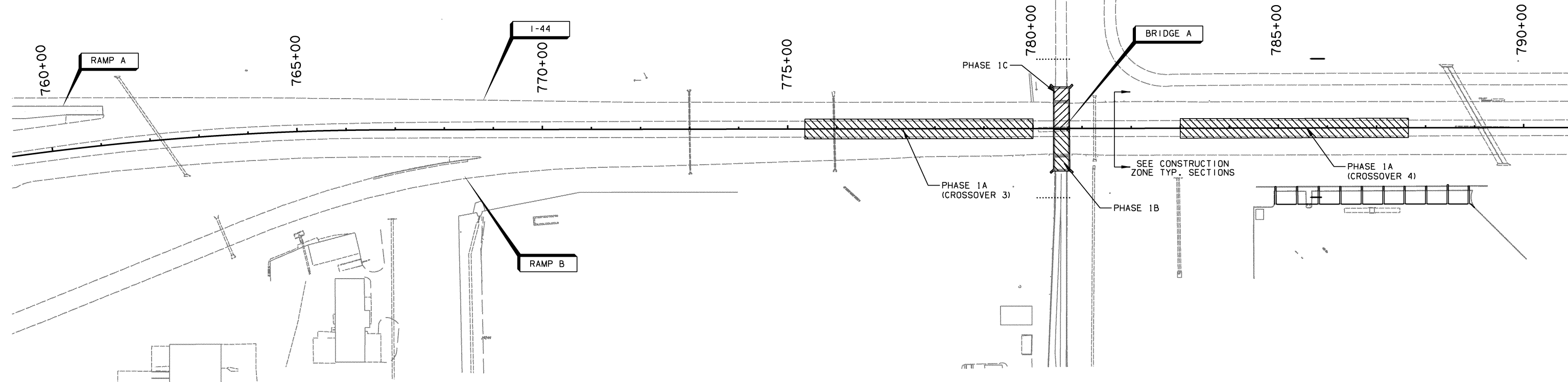
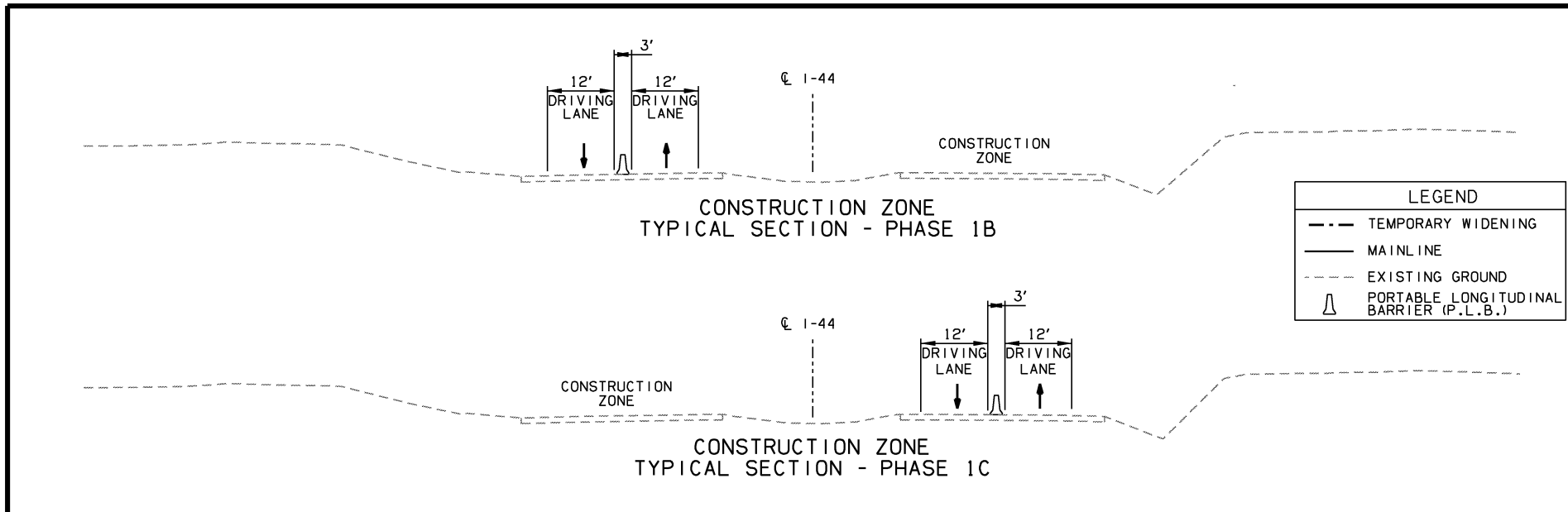
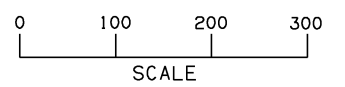

- PHASE 1A (CONSTRUCT CROSSOVERS FOR BRIDGE REMOVAL)**
SHIFT I-44 TRAFFIC TOWARD OUTSIDE SHOULDERS.
REMOVE PORTION EXISTING CABLE BARRIER.
CONSTRUCT TEMPORARY CROSSOVERS FOR USE IN PHASE 1B AND PHASE 1C.
- PHASE 1B (REMOVAL OF SOUTH PORTION EXIST. 145TH E. AVE. BRIDGE, TO OCCUR OVER ONE WEEKEND)**
CLOSE AND DETOUR 145TH FOR DURATION OF PROJECT.
SHIFT EASTBOUND I-44 TRAFFIC TO WESTBOUND LANES.
MAINTAIN ONE LANE OF TRAFFIC EACH DIRECTION.
REMOVE SOUTHERN PORTION OF 145TH E. AVE. BRIDGE.
TRAFFIC TO BE RESTORED TO NORMAL CONDITIONS PRIOR TO MONDAY MORNING.
- PHASE 1C (REMOVAL OF NORTH PORTION EXIST. 145TH E. AVE. BRIDGE, TO OCCUR OVER ONE WEEKEND)**
SHIFT WESTBOUND I-44 TRAFFIC TO EASTBOUND LANES.
MAINTAIN ONE LANE TRAFFIC EACH DIRECTION.
REMOVE NORTHERN PORTION OF 145TH E. AVE. BRIDGE.
TRAFFIC TO BE RESTORED TO NORMAL CONDITIONS PRIOR TO MONDAY MORNING.

ADMIRAL

DESIGN	AKS	6/14
DRAWN	TML	6/14
CHECKED	KMM	6/16
APPROVED		
SQUAD	GARVER	

TULSA & ROGERS COUNTIES
SUGGESTED CONSTRUCTION SEQUENCE OVERVIEW
 (SHEET 1 OF 14)
 STATE JOB NO. 21899(04) SHEET NO. 246