

Where proposed work is to be fitted against an existing structure, the Contractor shall check all dimensions and conditions of the existing structure in the field and report any errors or discrepancies to the Engineer. The Contractor shall assume responsibility for the accuracy and fitting of the proposed work to the existing structure.

OKLAHOMA DEPARTMENT OF TRANSPORTATION						
FED. ROAD DIST. NO.	STATE	JOB PIECE NO.	FISCAL YEAR	SHEET NO.	TOTAL SHEETS	
6	OKLA.	21899(04)				
DESCRIPTION				REVISIONS	DATE	
				REFERENCE ATTACHMENTS	8/22/16	

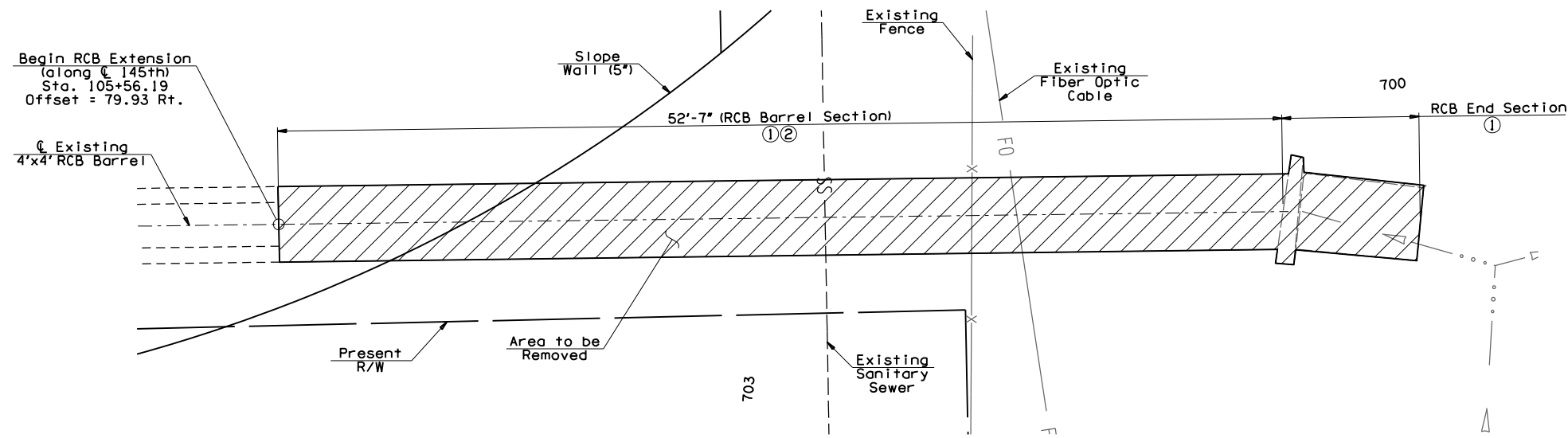

DEMOLITION PLAN

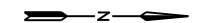
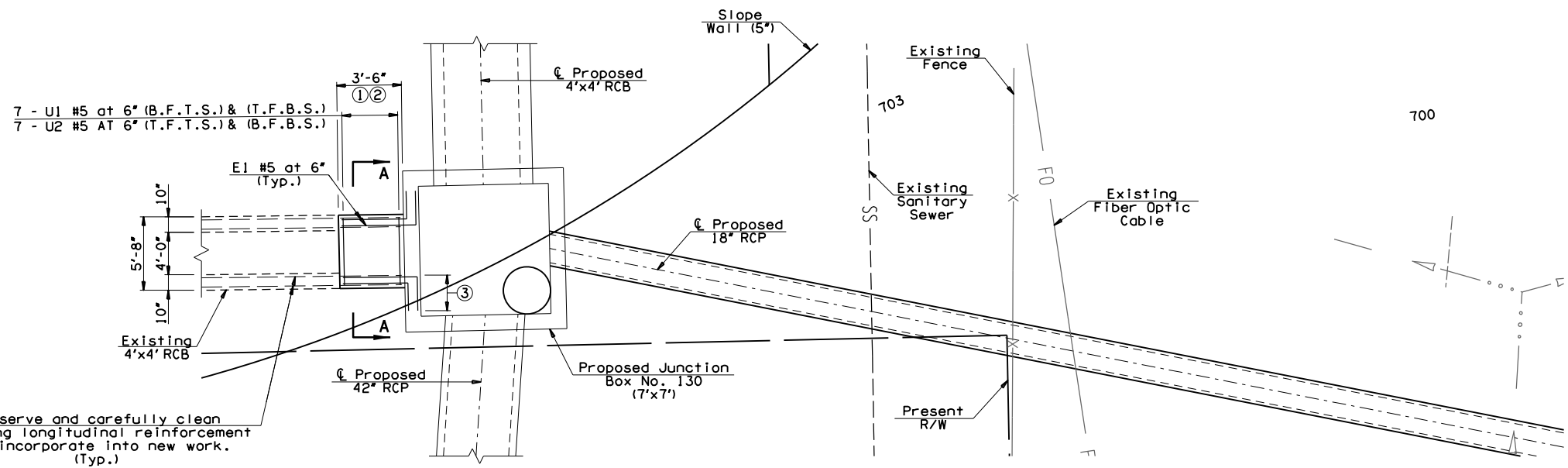

CONSTRUCTION PLAN

- ① Remove existing RCB End Section and approx. 52'-7' of existing RCB Barrel Section concrete. Preserve and clean 3'-6" of existing longitudinal reinforcement to be lapped with new RCB reinforcement. Contractor shall field verify length of RCB Barrel concrete to be removed.

LEGEND

- Existing Structure
- ▨ Removal of Existing Structure
- - - Existing Reinforcing Steel
- Proposed Structure
- B.F.B.S. Bottom Face Bottom Slab
- B.F.T.S. Bottom Face Top Slab
- T.F.B.S. Top Face Bottom Slab
- T.F.T.S. Top Face Top Slab

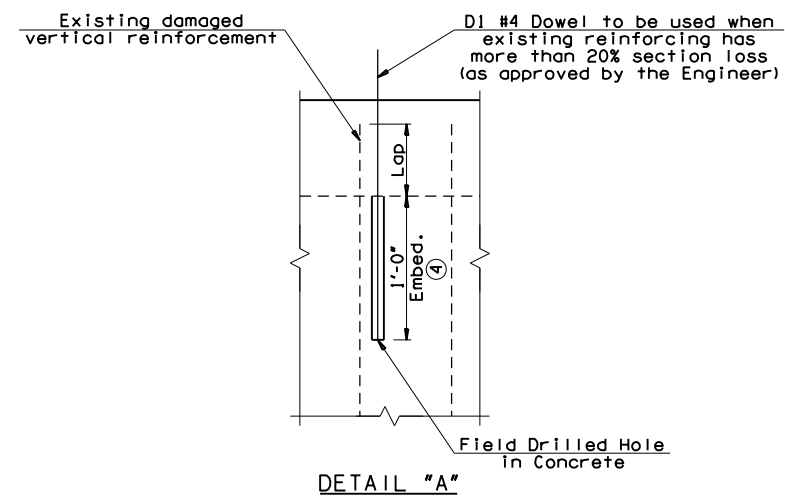

DETAIL "A"

② REMOVAL NOTES:

When removing the existing RCB Concrete, the Contractor shall take every precaution necessary to prevent damaging the existing RCB Barrel, except as shown in the plans, and the existing longitudinal reinforcement extending from the existing RCB Barrel. Only hand tools or hand operated power tools will be allowed to make the removals. No vehicle mounted tools or equipment will be allowed to make removals. Before making any removals with impact tools, all concrete components shall be uniformly saw cut along the removal lines or cut lines shown on the plans. Any damage caused by the Contractor to the existing RCB Barrel or longitudinal reinforcement shall be repaired or completely replaced at the Contractor's expense to the satisfaction of the Engineer. The Engineer will determine if the damaged component can be satisfactorily repaired or if the component shall be completely replaced.

Before making any removals, the Contractor shall submit to the Engineer a plan for removing each item or portions of items to be removed from the existing RCB Culvert. The Contractor shall not make any removals until the plan has been approved by the Engineer. The plan shall include a list of all the equipment that will be used to make the removals, a description of how the equipment will be used to make the removals and a sequential list of steps that will be followed by the Contractor to make removals.

Contractor shall match RCB Extension wall thickness to existing RCB wall thickness.

All costs necessary to complete the work as specified or as shown in the plans including the cost of sawing, cutting, demolition, cleaning and straightening reinforcing steel, containment and removal of debris, materials, labor, equipment and incidentals shall be included in the price bid per Lump Sum of "REMOVAL OF STRUCTURES & OBSTRUCTIONS".

- ③ Extend RCB wall, top, and bottom slab reinforcement for a 1'-6" minimum lap (typ.). Maintain a minimum 2" clearance.

NOTES:

See Sheet No. 153 for Section A-A, bar list, and bar bends.
See Sheet Nos. 147 - 150 for layout and details on Junction Box No. 130.

④ ANCHORAGE SYSTEM:

The Contractor shall use an Anchorage System that has been approved by ODOT's materials division. The Anchorage System shall be capable of developing the full strength of the reinforcing steel that is to be anchored. The embedment depth shown is to be adjusted to meet the Manufacturer's requirements. Anchorages shall be installed in accordance with the Manufacturer's specifications for the system used.

Drilling into the existing concrete to install the anchorage shall be accomplished without cutting existing concrete reinforcing steel bars. Prior to drilling, the Contractor shall locate and mark the existing concrete reinforcing steel bars with non-destructive tools, equipment and methods approved by the Engineer. If existing reinforcing steel bars are encountered during drilling, the drilling shall cease and the hole shall be grouted. The hole shall then be relocated to clear the existing reinforcing steel bars. Any adjustment in the locations of the DI bars from the plan locations shown shall be the minimum amount necessary to avoid cutting the existing concrete reinforcing steel bars and shall be approved by the Engineer.

All costs of the Anchorage Assemblies including labor, materials, tools, drilling, and incidentals necessary to complete the work shown in the plans shall be included in the price bid per Cubic Yard of "CLASS A CONCRETE".

145TH OVER I-44 TULSA & ROGERS COUNTIES		DESIGN	JGS	12/14
RCB EXTENSION DETAILS (SHEET 2 OF 3)		DETAIL	SJL	12/14
		CHECK	XXX	XXX
		GARVER		
STATE OF OKLAHOMA	DEPARTMENT OF TRANSPORTATION			
	JOB PIECE NO. 21899(04)	SHEET NO. 152		