

SUMMARY OF QUANTITIES - SLOPE WALLS				
ITEM	UNIT	SLOPE WALL NO. 1	SLOPE WALL NO. 2	TOTAL
② SLOPE WALL (5%)	S.Y.	1,279.60	1,592.70	2,872.30
③ 6\"/>				

- ② All costs of the "SLOPE WALL (5%)" installation including Class A Concrete, Reinforcing Steel, Lap Splices, Backer Rod, Silicone Joint Sealant, Preformed Joint Filler, Polystyrene, Excavation, Aggregate Base (Type A), Unclassified Backfill, Labor, Equipment, and other incidentals necessary to complete the work as specified on the plans shall be included in the price bid per Square Yard of "SLOPE WALL (5%)".
- ③ All costs of the Perforated Pipe Underdrain installation including trench excavation, cover material, labor, equipment, and incidentals shall be included in the price bid per Linear Foot of "6\"/>

LEGEND
 6" Perf. Underdrain - - - - -
 6" Non-Perf. Underdrain - - - - -

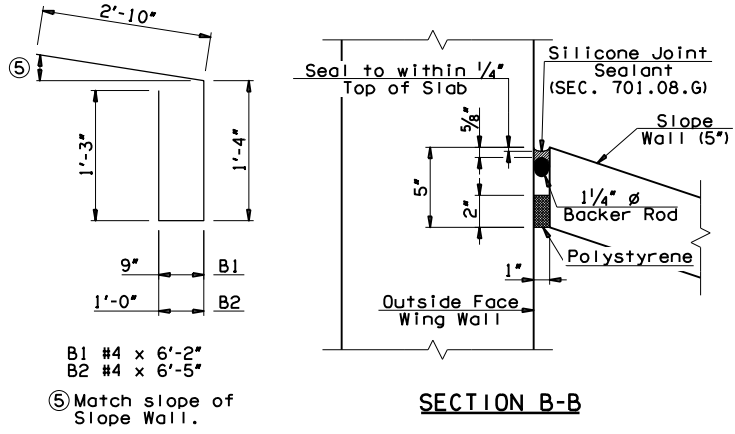

145TH OVER I-44 TULSA & ROGERS COUNTIES DESIGN JMO 3/14
 BRIDGE "A" DETAIL SJL 3/14
 CHECK MJY 10/14
GARVER

SLOPE WALL DETAILS (SHEET 1 OF 2)

STATE OF OKLAHOMA DEPARTMENT OF TRANSPORTATION
 JOB PIECE NO. 21899(04) SHEET NO. 126