

SEC 34 T20N R14E

PROPOSED LIMITS OF ACCESS SKELLY DR. ONLY

EXIST. LIMITS OF ACCESS SKELLY DR. ONLY

OKLAHOMA DEPARTMENT OF TRANSPORTATION					
FED. ROAD DIST. NO.	STATE	JOB PIECE NO.	FISCAL YEAR	SHEET NO.	TOTAL SHEETS
6	OKLA.	21899(04)			
DESCRIPTION			REVISIONS	DATE	

TEMPORARY DRIVEWAY			
NUMBER	STATION	WIDTH	SURFACE
1	23+71	20'	T.B.S.C.
2	29+84	26'	T.B.S.C.
3	31+09	26'	T.B.S.C.
4	32+34	22'	T.B.S.C.
5	33+00	16'	T.B.S.C.
6	33+45	16'	T.B.S.C.
7	34+47	22'	T.B.S.C.
8	35+11	18'	T.B.S.C.
9	35+81	36'	T.B.S.C.
10	37+06	16'	T.B.S.C.
11	37+66	20'	T.B.S.C.
12	38+69	24'	T.B.S.C.
13	41+41	36'	T.B.S.C.
14	46+61	36'	T.B.S.C.
15	48+20	36'	T.B.S.C.
16	28+30	20'	T.B.S.C.

SKELLY DR. C.R.L. CURVE D-3		SKELLY DR. C.R.L. CURVE D-4	
PI=43+01.23	N=430609.86	PI=46+14.51	N=430633.66
E=2616386.96	Δ=3°07'58" LT	E=2616699.41	Δ=3°07'58" RT
D=1°00'00"	T=156.68	D=1°00'00"	T=156.68
L=313.28	R=5729.58	L=313.28	R=5729.58
E=2.14	emax=4.0%	E=2.14	emax=4.0%
S=N.C.	V=40 MPH	S=N.C.	V=40 MPH

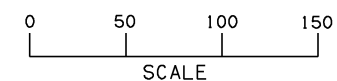

LEGEND	
[Symbol]	PROPOSED PAVEMENT
[Symbol]	TEMP. PAVEMENT
[Symbol]	DRAINAGE STR. NUMBER
[Symbol]	TEMP. DRIVE
[Symbol]	PROPOSED LIGHT FIXTURE
[Symbol]	OVERHEAD SIGN STR.

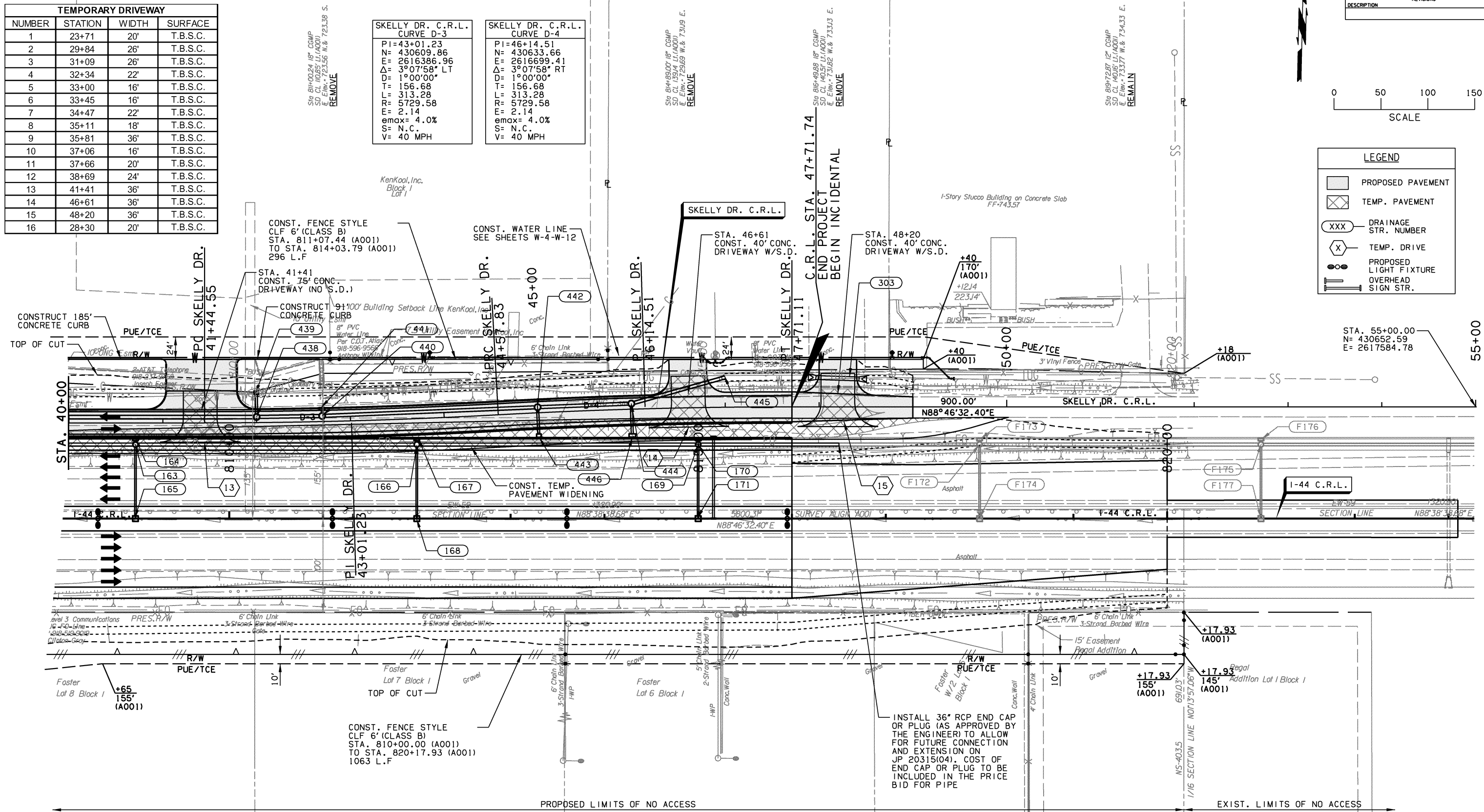

SEE SHEET 75 FOR SKELLY DR. PROFILE

SEE SHEETS 37 - 48 FOR PLAN GEOMETRIC DATA

SEE SHEETS 138 - 148 FOR PLAN STORM SEWER DATA

SEC 3 T19N R14E

BM#136 #4 REBAR SET FLUSH WITH GROUND 125.87' LT. STA. 810+31.35 EL. 726.27' (A001)

BM#101 #6 REBAR SET FLUSH WITH GROUND 96.40' RT. STA. 813+60.37 EL. 727.46' (A001)

BM#137 CHISELED BOX ON TOP OF SSMH 169.65' LT. STA. 815+18.21 EL. 734.71' (A001)

INSTALL 36" RCP END CAP OR PLUG (AS APPROVED BY THE ENGINEER) TO ALLOW FOR FUTURE CONNECTION AND EXTENSION ON JP 20315(04). COST OF END CAP OR PLUG TO BE INCLUDED IN THE PRICE BID FOR PIPE

PREP./PROP. R/W-U/E AND FENCE STATIONS BASED ON SURVEY © ALL OTHER CONST. STATIONS BASED ON C.R.L.

DESIGN	DLT	8/12	TULSA & ROGERS COUNTIES
DRAWN	MAM	8/12	
CHECKED	KMM	6/16	
APPROVED			
SQUAD	<b>GARVER</b>		STATE JOB NO. 21899(04) SHEET NO. 62